

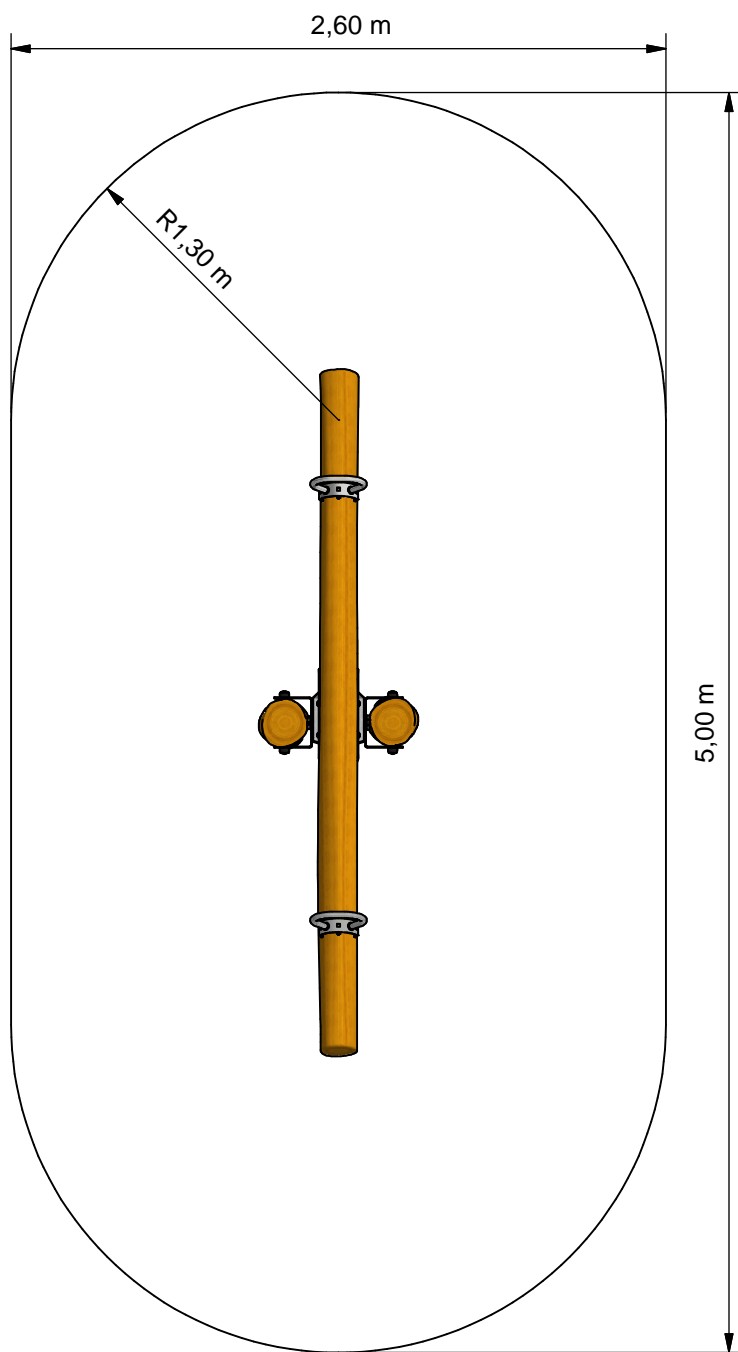

2 person seesaw



PSTE000.001



- Opvangzone**
Impact area
- Obstakelvrije zone**
Obstacle free zone



Benaming / Title: Wip, Gedempt
Opmerking / Comment: 2-Persoons
Datum / Date: 27-5-2016

Tekening / Drawing

TOE PST 000 001 A
Obstakelvrije ruimte *Obstacle free zone*

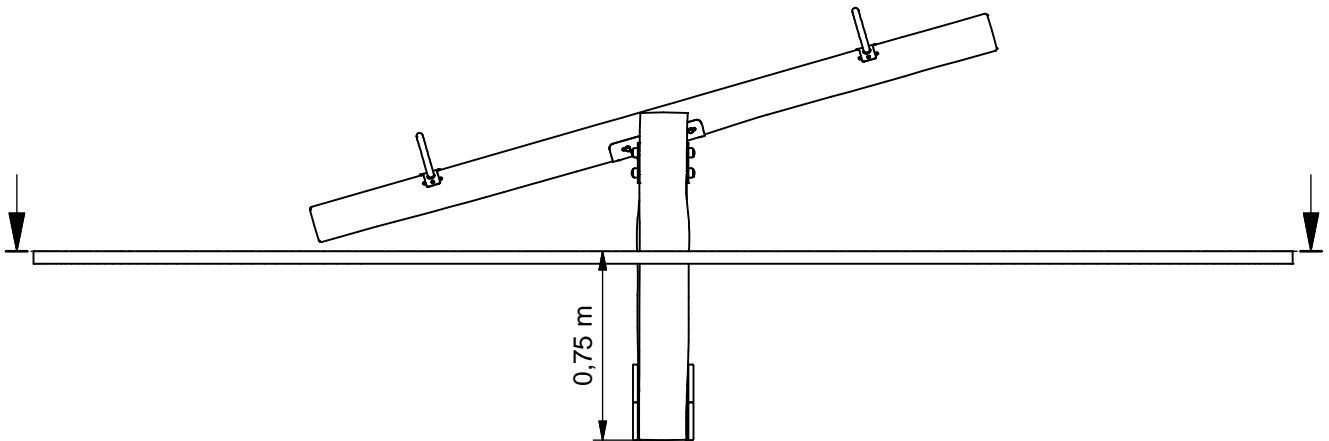
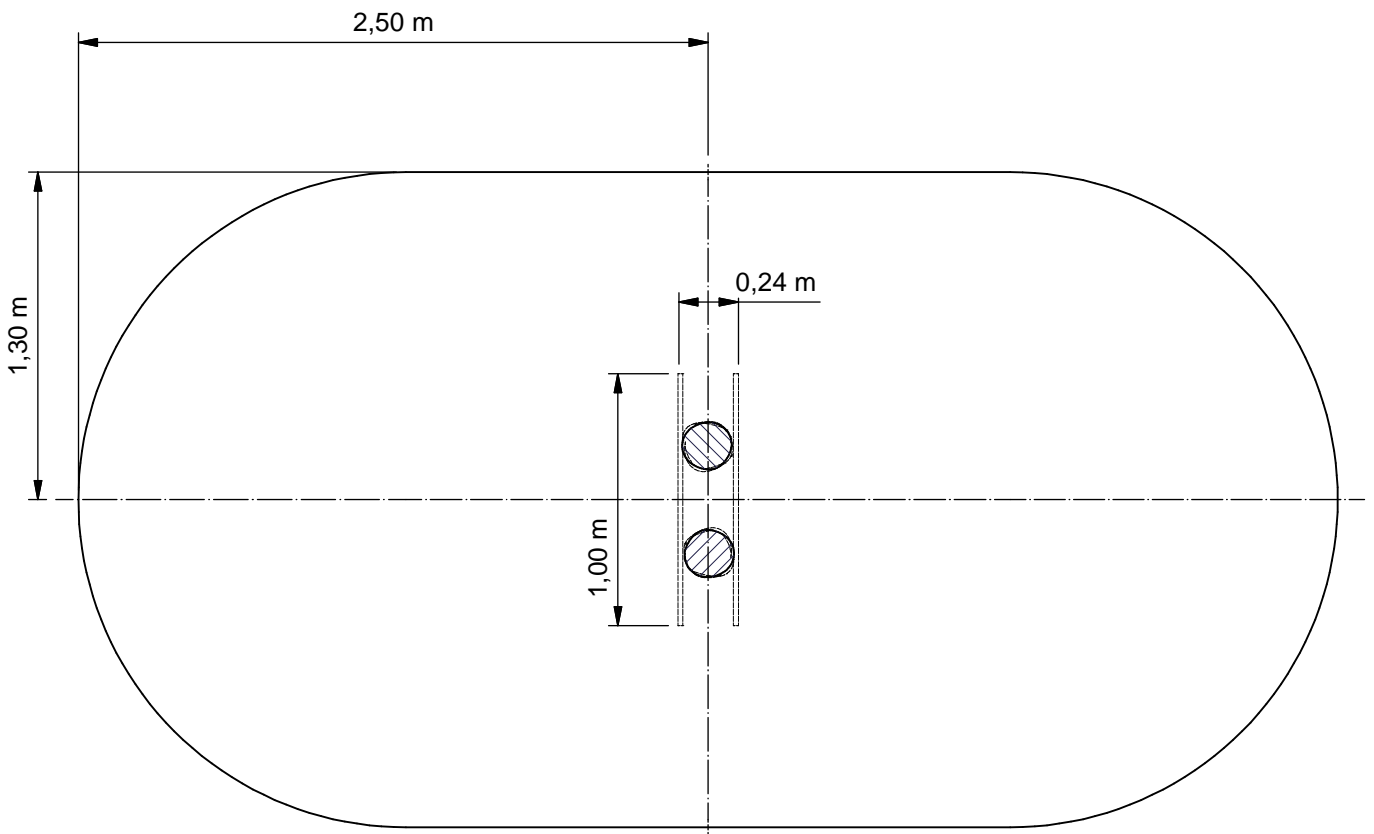

Benaming
Title | Wip, Gedempt

Opmerking
Comment | 2-Persoons

Datum
Date | 27-5-2016

Tekening
Drawing

TOE PST 000 001 A

Bodemplan *Groundplan*

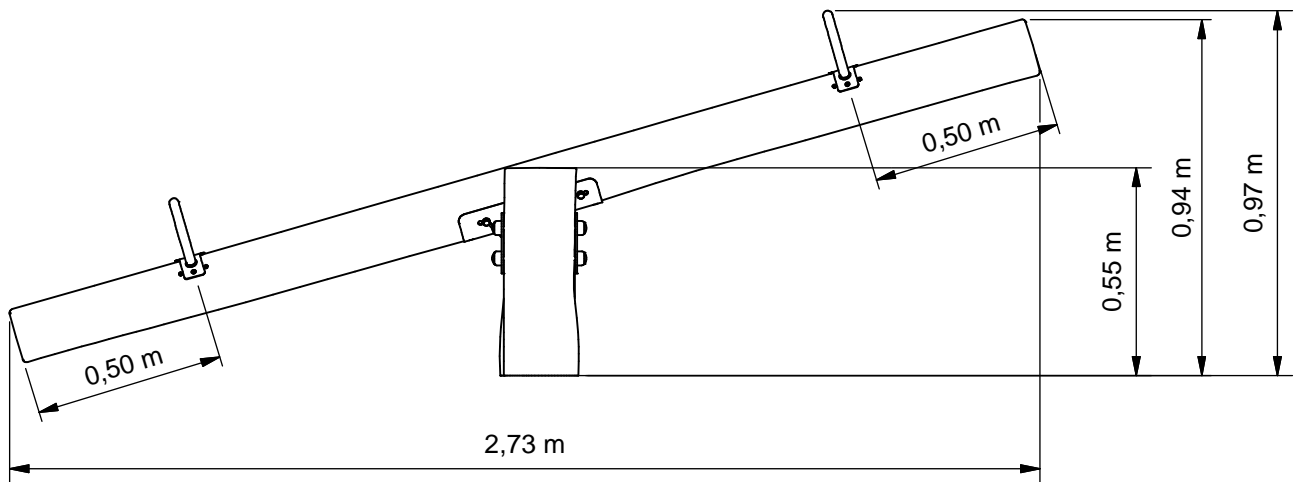
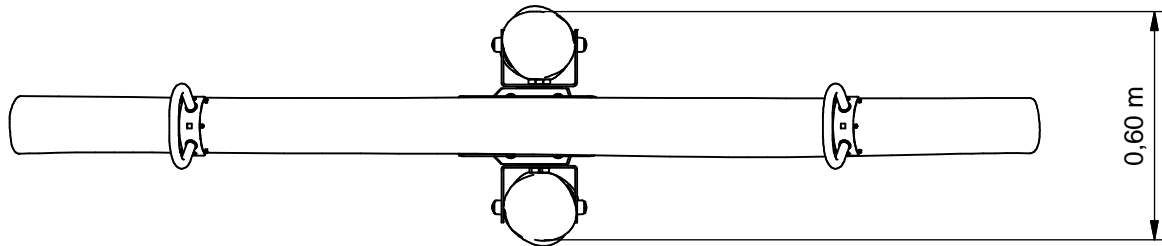

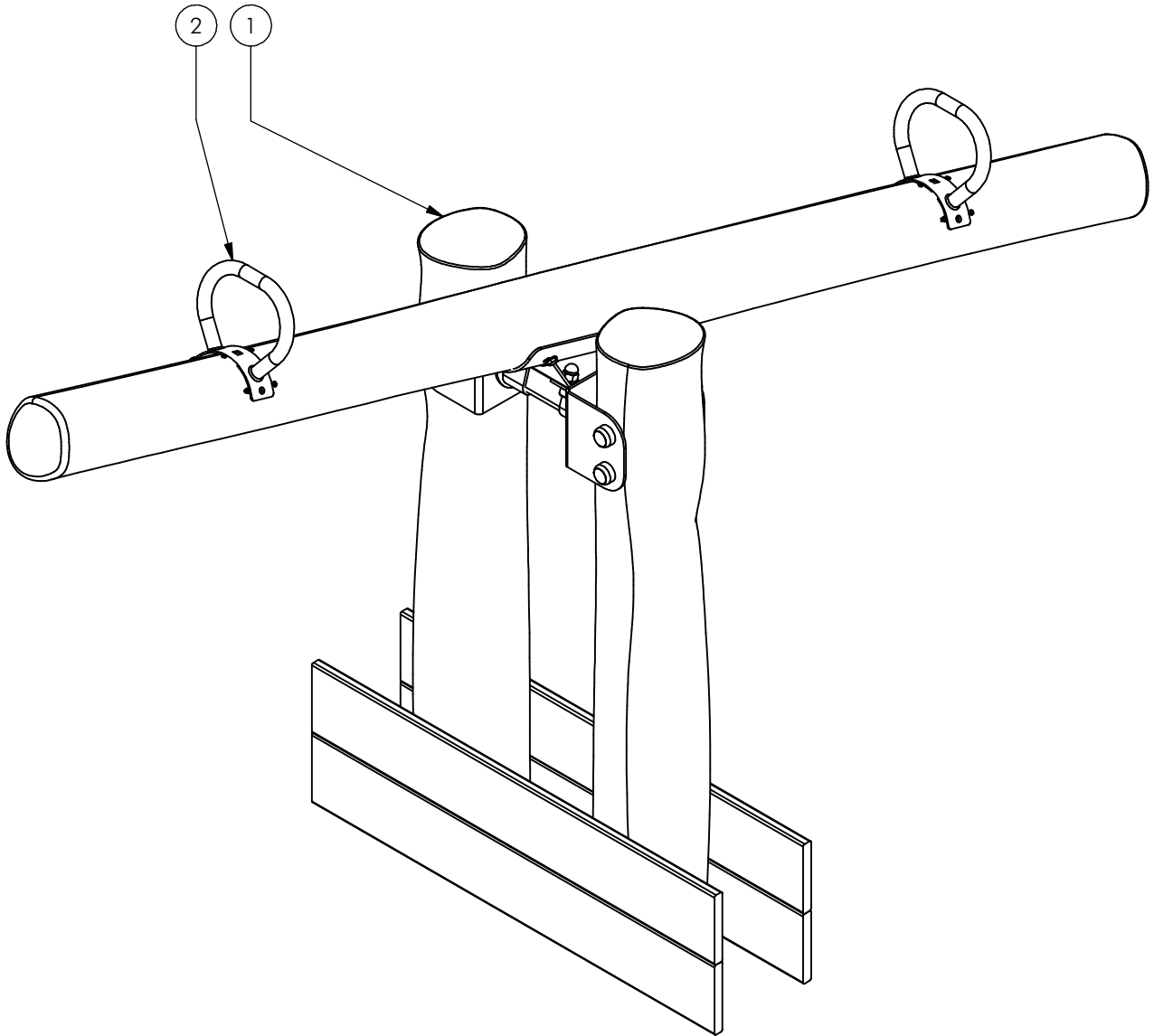

Nr	#	Type	Progr.	Volgnr	Bew.	Rev.	Benaming	Opmerking
1	1	MOD	PST	006	101	C	Wip-wap	Veerelement, Gedempt
2	1	MOD	PST	006	103		Wip-wap	2-Zits



Benaming
Title | Wip, Gedempt

Opmerking
Comment | 2-Persoons

Datum
Date | 27-5-2016

Tekening
Drawing

TOE PST 000 001 A

Modules Modules

Geleverde delen:

A - wip met onderstel 3,0x1,0x1,5 m [140 kg]

Bevestiging sets:

1 - n.v.t.

Montagevolgorde:

- 1 - graaf de gaten volgens het bodemplan en plaats hierin het toestel
- 2 - controleer of het toestel voldoet aan de afmetingen zoals op blad 'afmetingen'
- 3 - dicht de gaten en verdicht het zand

Controles:

- 1 - correcte opbouw en alle bevestigingsmiddelen
- 2 - de uiterste hoogte van het uiteinde van de balk (<100 cm)
- 3 - controleer de afmetingen van de valbodem t.o.v. het toestel

Supplied parts:

A - see-saw with support 3,0x1,0x1,5 m [140 kg]

Mounting kits:

1 - n.a.

Assembly sequence:

- 1 - dig the holes according to the ground plan and place the play equipment
- 2 - check that the equipment conforms to the dimensions shown on sheet 'dimensions'
- 3 - close the holes and compact the sand

Checks:

- 1 - correct assembly and all the fasteners
- 2 - the maximum height of the end of the bar (<100 cm)
- 3 - check the dimensions of the safety area compared to the play equipment

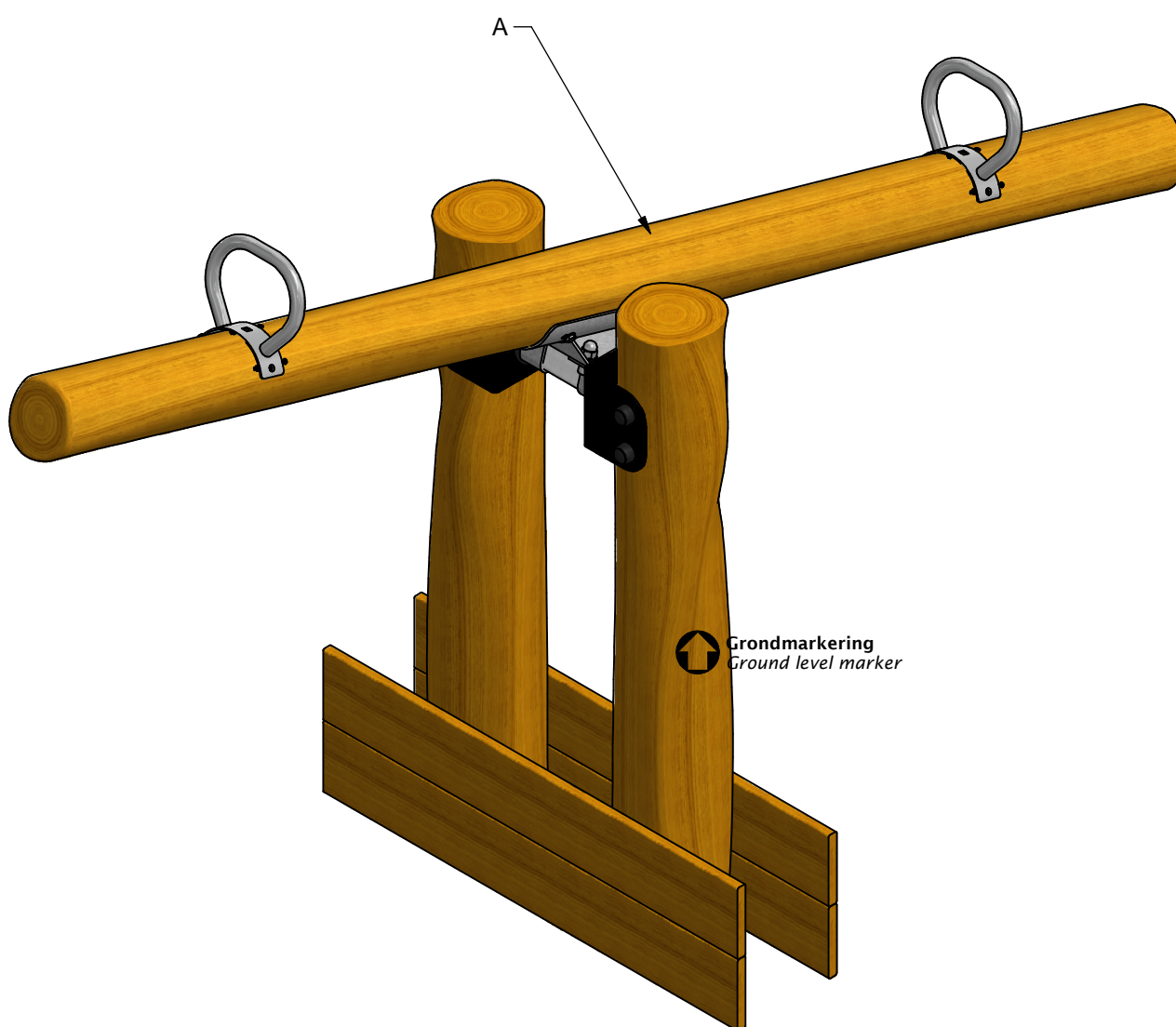

 **Grondmarkering**
Ground level marker

PSTE000.001

2 person seesaw

LOGBOOK

(Onderstaand logboek kan gebruikt worden om te voldoen aan de eisen, gesteld in artikel 14 van het Warenwetbesluit Attractie- en Speeltoestellen)

Type indication	Adventure Play
Product code	PSTE000.001
Name of equipment	2-Persoonswip gedempt
Maximum height of fall	1,0 m
Year of construction	2017
Certificate	031050
inspection authority	TUV Nederland QA BV De Waal 21c, Best - 5684 PH Best
Name manufacturer	BOERplay Hyacintstraat 2 - 4255 HX Nieuwendijk Phone: +31 (0)183 40 23 66 Fax: +31 (0)183 40 35 64
name installer	_____ _____
Description of equipment	2 person seesaw
Location of equipment	_____
Data about the owner of the play equipment	
Name:	_____
Address:	_____
Postcode and town:	_____
Contact person:	_____
Telephone number:	_____
Data about the administrator of the play equipment	
Name:	_____
Address:	_____
Postcode and town:	_____
Contact person:	_____
Telephone number:	_____

LOGBOOK

Inspection and maintenance intervals



Nr.	Inspection	Maintenance	months between inspections
1	Verify equipment's stability, junctions and missing parts. Inspect bolts, screws and nuts for absence, jams, corrosion and wear.	Add missing parts, secure joints, apply missing fixing agent and replace corroded parts.	1
2	Check suspension for wear.	Replace worn parts and/or remove non-functioning parts.	1
3	Inspect rotating parts such as hinges, rolling-element bearings, etc. for wear and acceptability.	Replace worn parts and/or remove non-functioning parts.	1
4	Check wood for splinters, unacceptable damage and signs of rot. Especially at ground level.	Repair damage. Replace affected wood. Smoothen splintered wood and sharp edges.	1
5	Inspect foundation for stability, tearing and coverage.	Restore foundation and covering material.	3
6	Examine rubber and synthetic parts for wear, damage and break.	Replace original parts.	3
7	Inspect metal for corrosion and damage in the coating.	Restore any damaged coating (after removing rust and applying primer).	6
8	Check ropes, cables, chains and nets for wear and damage. Steel cables and nets which are tensioned must be checked for tension.	Replace parts where necessary. Steel cables and nets must be tensioned.	3
9	Inspect equipment for unsafe changes and additions.	Remove unsafe additions and correct unsafe changes.	1
10	Inspect safety surfaces.	Restore and repair where necessary.	1

Remarks

1. If used intensively, all points require extra attention.
2. Extreme weather conditions and locations may require a higher inspection frequency. Discuss this with the supplier.
3. Vandalism-sensitive locations require stricter inspections, possibly daily.
4. Check the terrain regularly for items that do not belong there, are unsafe or may be used wrongly. Examples are poisonous plants, glass shards, etc. Frequency depends on strain.
5. Remember that bad maintenance leads to unsafe conditions and notably faster impoverishment of the playground area.
6. Replacement parts can be ordered at the manufacturer with the part numbers on the module drawing. Drawings can be found in de user guide.
7. The impact area shall be provided with impact attenuating surface according to the specified falling height.
8. This list is conform the CEN-standard "playground equipment and surfacing NEN-EN 1176-7".

Warenwet

Certificaat van Typeonderzoek Type Examination Certificate

afgegeven door issued by

TÜV Nederland QA BV



aangewezen bij ministeriële beschikking van 4 mei 2012, nr. VGP 3113590
commissioned by departmental order of 4 May 2012, no. VGP 3113590

Certificaat nr. Certificate nr.	031050TF_20121005	Dossiernr. File nr.	031050TF
Productomschrijving Product description	2-persoons gedempte wip		
Evt. nadere aanduidingen Further indications	Plaatsing met en zonder rubberen buffers mogelijk		
voor nadere informatie zie bijbehorend rapport met gelijkloidend dossiernr. for further information see associated report with identical file nr.			
Eigenaar / certificaathouder en adres Owner/certificate holder and address	Boer Speeltoestellen B.V. Postbus 10 4255 ZG NIEUWENDIJK		
Soort toestel Category of equipment	Speeltoestel		
Fabrikant Manufacturer	Boer Speeltoestellen B.V. Postbus 10 4255 ZG NIEUWENDIJK		
Type/Serienummer Type/Serial number	PST.000.001 /	in te vullen door de fabrikant to be filled out by the manufacturer	
Jaar van fabricage Year of construction	vanaf 2012 since		
Leverancier Supplier	Boer Speeltoestellen B.V. Postbus 10 4255 ZG NIEUWENDIJK		
Jaar van levering Year of supply			in te vullen door de leverancier to be filled out by the supplier
Datum keuring Date of examination	16-03-2012 – 05-10-2012		

TÜV Nederland QA BV, de Waal 21C, NL-5684 PH Best verklaart, dat het bovenaangehaalde toestel voldoet aan de vervaardigingvoorschriften genoemd in het Warenwetbesluit attractie- en speeltoestellen (met als leidraad de normatieve documenten NEN-EN 1176:2008).

TÜV Nederland QA BV declares that the here above mentioned equipment meets the safety and health requirements mentioned in the Dutch law "Warenwetbesluit attractie- en speeltoestellen" (guided by normative documents EN 1176:2008).

Namens het bestuur, For the board, A.C. Boon Directeur	
---	--

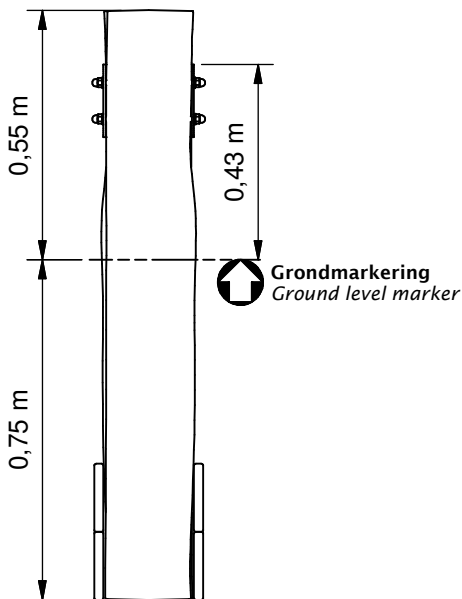
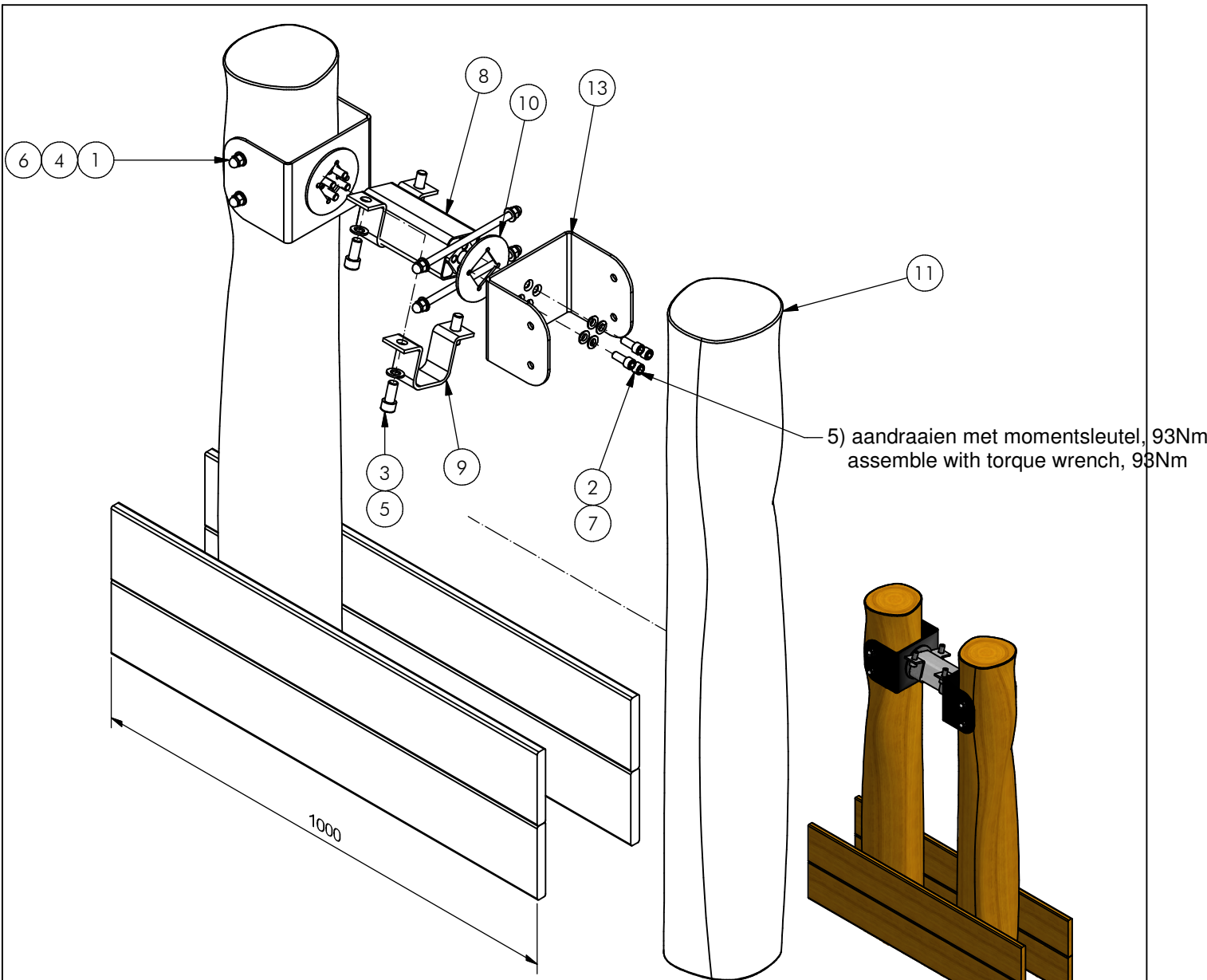

Nr	#	Type	Progr.	Volgnr	Bew.	Rev.	Benaming	Opmerking
1	8	BSR	011	012	025		Borgdopmoer	M12 - RVS A2-70
2	8	BSR	027	012	030		Cilinderkop bout	M12 x 30 - RVS A2-70
3	4	BSR	027	016	035		Cilinderkop bout	M16 x 35 - RVS A2-70
4	8	BSR	030	012	003		Sluitring	M12 - RVS A2-70
5	4	BSR	030	016	003		Sluitring	M16 - RVS A2-70
6	4	BSR	070	012	230		Draadeind	M12 x 230 - RVS A2-70
7	8	BSV	037	012	005		Conische veerring	M12 x 23
8	1	BSV	080	200	050		Torsie element Rosta	DR-A 50 x 200 - VZ 8.8
9	2	BSV	080	250	000		KLEMBEUGEL	ROSTA BR50
10	2	KST	SOL	001	HPE		OPVULSCHIJFJE	ADELAAR
11	2	OHO	PST	200	013		Paal 18-20	Lengte =1300
12	4	OHO	PST	212	100		Plank 120x20	Lengte = 1000
13	2	OME	PST	001	905	B	Beugel	Wipdemper



Benaming Title Wip-wap
 Opmerking Comment Veerelement, Gedempt
 Datum Date 19-1-2016

Tekening Drawing

MOD PST 006 101 C
 Samenstelling module Assembly module

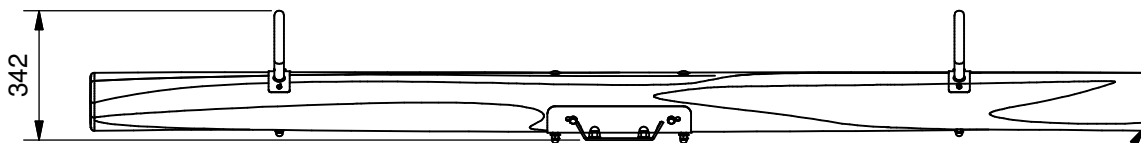
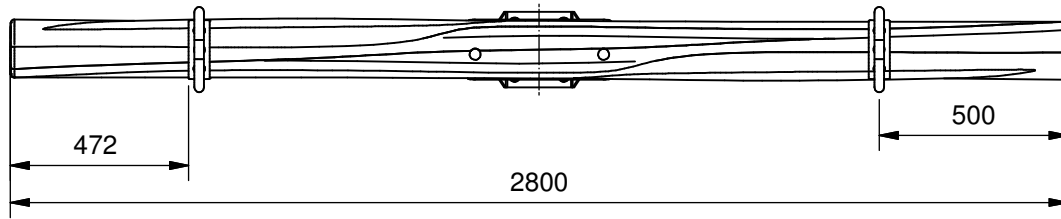

Uiteinden afronden

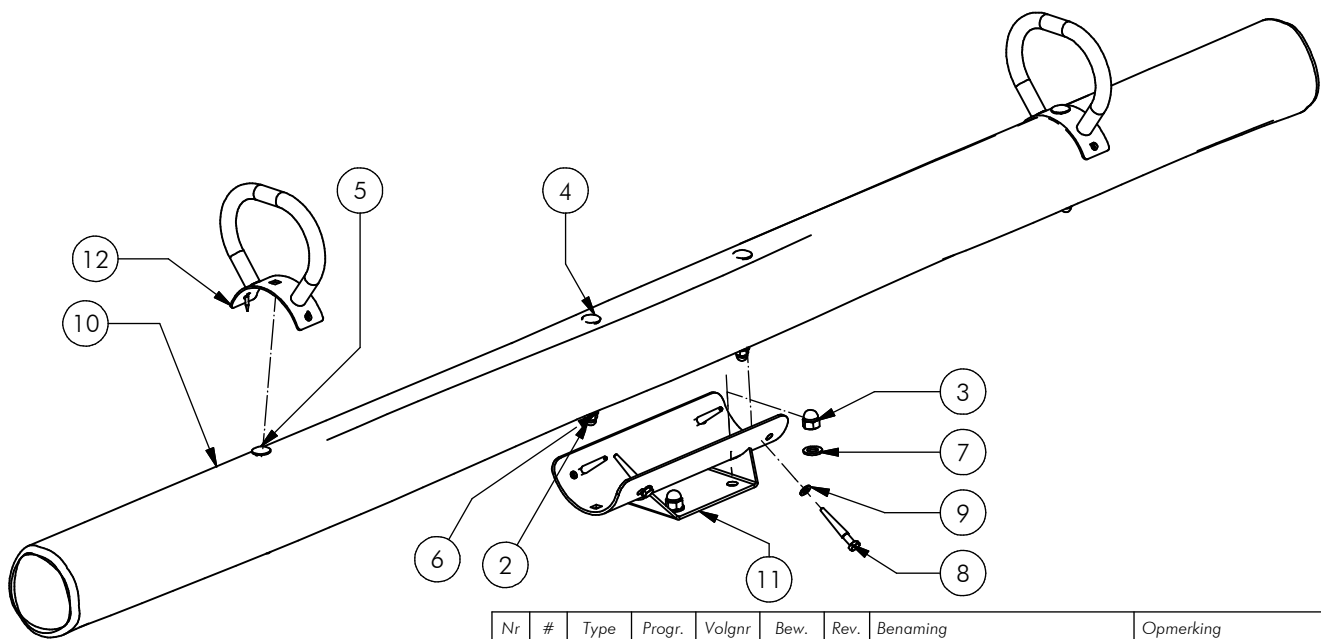

Nr	#	Type	Progr.	Volgnr	Bew.	Rev.	Benaming	Opmerking
1	4	BSR	002	005	030		Schroef Assy	5 x 30 - RVS A2-70
2	4	BSR	011	012	025		Borgdopmoer	M12 - RVS A2-70
3	4	BSR	012	016	030		Dopmoer	M16 - RVS A2-70
4	2	BSR	026	012	180		Slotbout	M12 x 180 - RVS A2-70
5	2	BSR	026	012	160		Slotbout	M12 x 160 - RVS A2-70
6	4	BSR	030	012	003		Sluitring	M12 - RVS A2-70
7	4	BSR	030	016	003		Sluitring	M16 - RVS A2-70
8	4	BSV	022	010	080		HOUTDRAADBOUT	M10 X 80
9	4	BSV	030	010	002		SLUITRING	M10 VZ
10	2	OHO	PST	116	002		Paal Ø14-Ø16	2 Persoons - L=2800
11	1	SME	PST	003	372	C	Steun	Wip balk
12	2	SME	PST	053	320	A	Handgreep	R & T



Benaming Title Wip-wap
 Opmerking Comment 2-Zits
 Datum Date 7-3-2011

Tekening Drawing

MOD PST 006 103

Samenstelling module Assembly module