

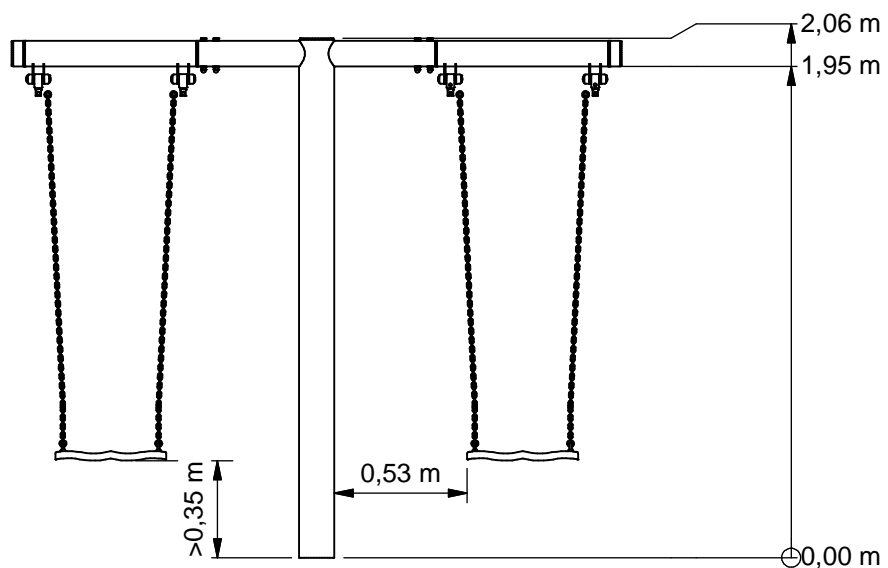

## S2 half hexagon swing

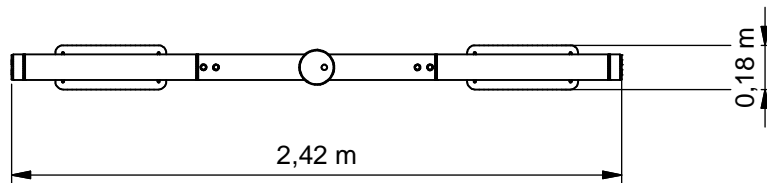

CSPE440.320



Benaming  
Title T-Schommel

Opmerking  
Comment Anti-Overgooi

Datum  
Date 3-3-2015

Tekening  
Drawing

**TOE CSP 440 320 B**  
Hoofdafmetingen *Main dimensions*

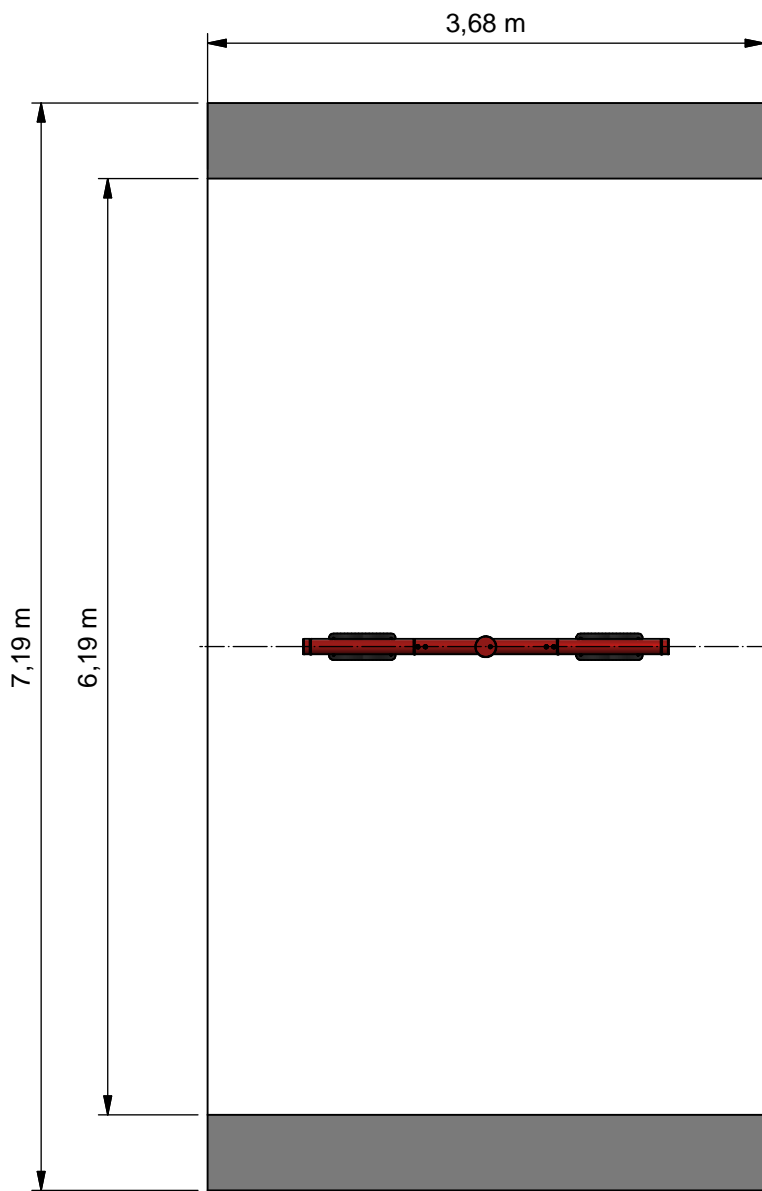

- Opvangzone  
Impact area
- Obstakelvrije zone  
Obstacle free zone



Benaming  
Title T-Schommel

Opmerking  
Comment Anti-Overgooi

Datum  
Date 3-3-2015

Tekening  
Drawing

**TOE CSP 440 320 B**  
Obstakelvrije zone *Obstacle free zone*

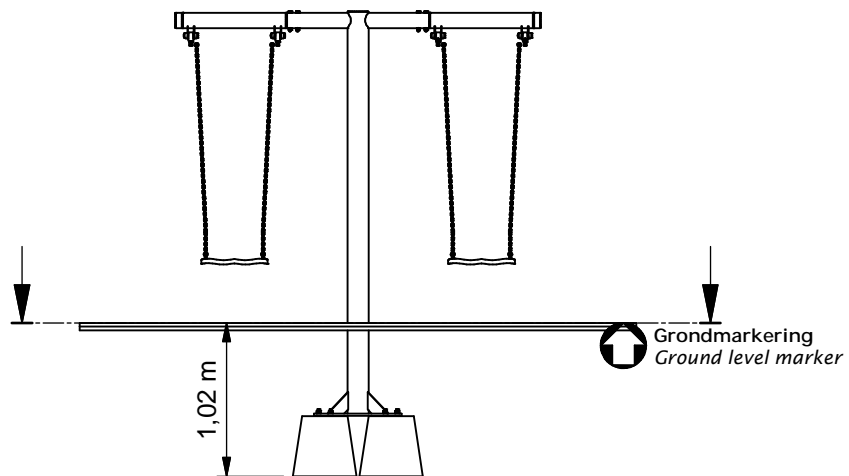
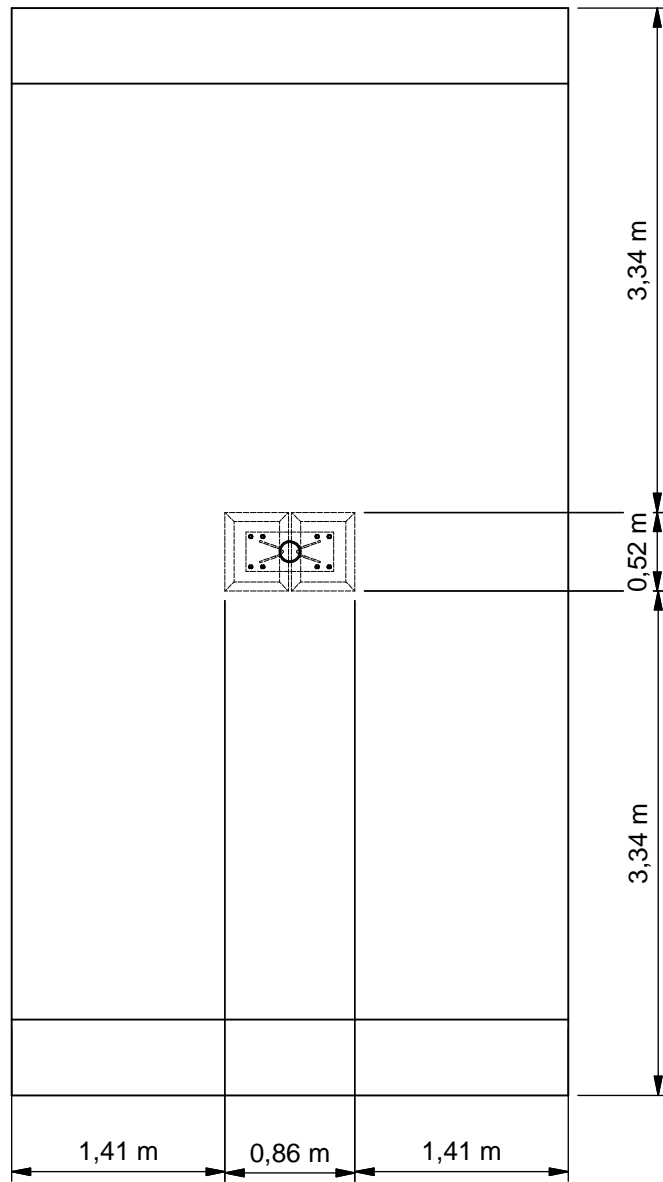

Benaming  
Title T-Schommel

Opmerking  
Comment Anti-Overgooi

Datum  
Date 3-3-2015

Tekening  
Drawing

TOE CSP 440 320 B

Bodemplan *Groundplan*

**Geleverde modules:**

Zie tabel

**Supplied modules:**

See table

**Montageinstructie:**

- De hoofdmaten geven de maten van de standers en vloeren aan
- De detailtekeningen geven specifiek de maten van de verbindingen aan
- De modules met buizen zijn op de tekeningen bemaat op bovenkant kopplaat
- Overige modules zijn bemaat op de bovenkant (klimwanden, paalkappen, etc.)

**Assembly instruction:**

- The main dimensions indicate the dimensions of the posts and floors
- The detailed dimensions show the specific dimensions of the connections
- The modules which contain tubes are dimensioned at the top of the flanges
- Other modules are dimensioned at the top (climbing walls, caps for the posts, etc.)

**Montagevolgorde:**

- 1 - Graaf de gaten volgens het bodemplan
- 2 - Plaats 2(2x)
- 3 - Plaats 1 en verbind deze aan 2
- 4 - Plaats 3(2x) en verbind deze aan 1
- 5 - Controleer of het toestel voldoet aan de afmetingen zoals op blad 'afmetingen'
- 6 - Dicht de gaten en verdicht het zand

**Assembly sequence:**

- 1 - Dig the holes according to the ground plan
- 2 - Place 2(2x)
- 3 - Place 1 and attach it to 2
- 4 - Place 3(2x) and attach it to 1
- 5 - Check that the equipment conforms to the dimensions shown on sheet 'dimensions'
- 6 - Close the holes and compact the sand

**Controles:**

- 1 - Correcte opbouw en alle bevestigingsmiddelen
- 2 - Controleer de afmetingen van de valbodem t.o.v. het toestel

**Checks:**

- 1 - Correct assembly and all the fasteners
- 2 - Check the dimensions of the safety area with regard to the play equipment

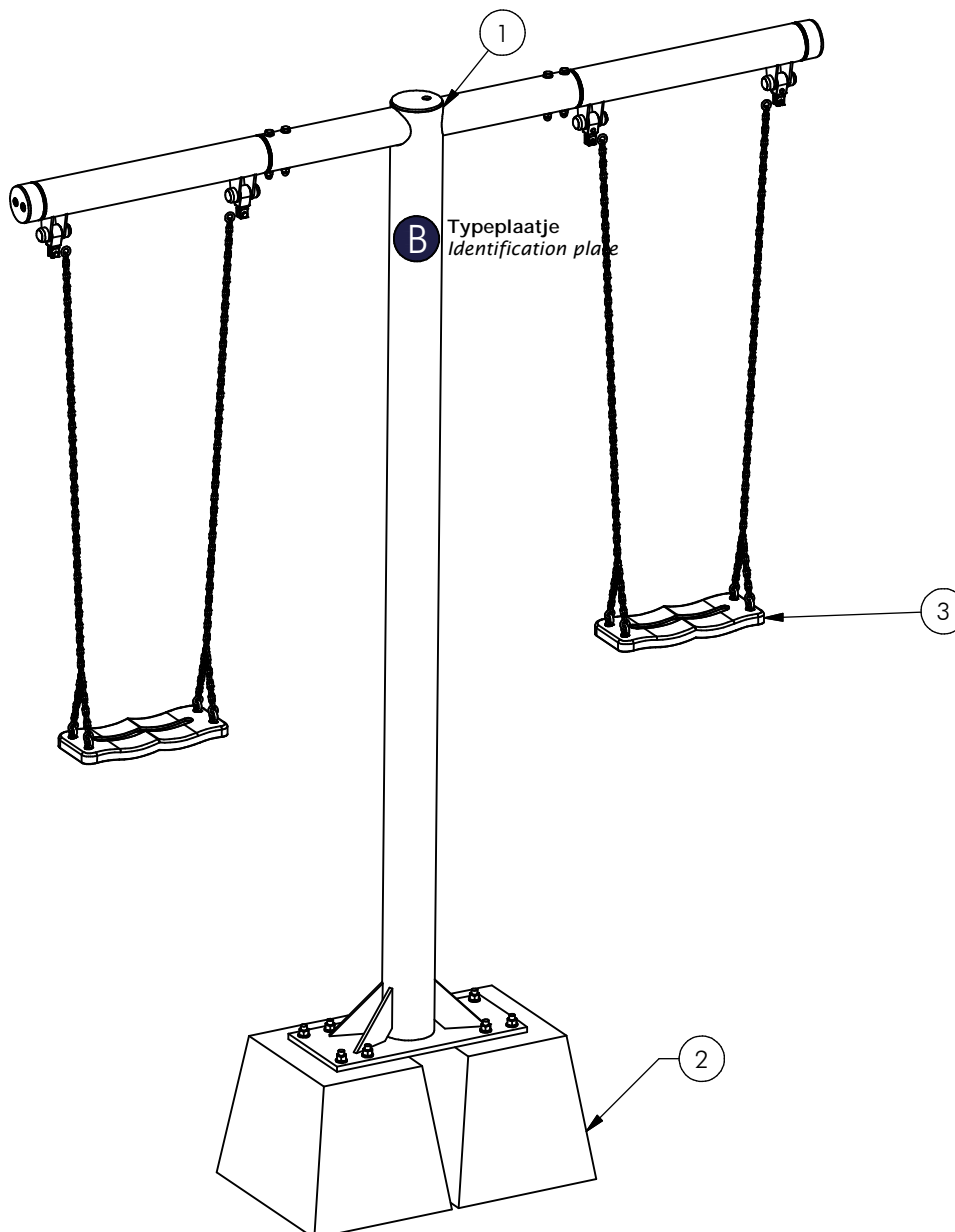

| Nr | # | Type | Progr. | Volgnr | Bew. | Rev. | Benaming      | Opmerking   |
|----|---|------|--------|--------|------|------|---------------|-------------|
| 1  | 1 | MOD  | CSP    | 023    | 320  | B    | Staander      | T-Schommel  |
| 2  | 2 | MOD  | OBT    | 006    | 001  |      | Poer model 6  | 150 KG      |
| 3  | 2 | MOD  | SOL    | 030    | 532  | A    | Overgooizitje | ketting 145 |



Benaming  
Title T-Schommel

Opmerking  
Comment Anti-Overgooi

Datum  
Date 3-3-2015

Tekening  
Drawing

TOE CSP 440 320 B

Modules Modules

# CSPE440.320

S2 half hexagon swing

## LOGBOOK

(Onderstaand logboek kan gebruikt worden om te voldoen aan de eisen, gesteld in artikel 14 van het Warenwetbesluit Attractie- en Speeltoestellen)

|  |   |
|--|---|
| Type indication                                    | Classic Play  |
| Product code                                       | CSPE440.320   |
| Name of equipment                                  | T-Schommel AW RAL3020   |
| Maximum height of fall                             | 1,2 m   |
| Year of construction                               | 2017  |
| Certificate  | 132567  |
| inspection authority                               | Keurmerkinstituut<br>Groeneweg 2e, Zoetermeer - 2718AA Zoetermeer   |
| Name manufacturer                                  | BOERplay<br>Hyacintstraat 2 - 4255 HX Nieuwendijk<br>Phone: +31 (0)183 40 23 66<br>Fax: +31 (0)183 40 35 64 |
| name installer                                     | _____<br>_____  |
| Description of equipment                           | S2 half hexagon swing   |
| Location of equipment                              | _____   |
| Data about the owner of the play equipment         |   |
| Name:  | _____   |
| Address:   | _____   |
| Postcode and town:                                 | _____   |
| Contact person:                                    | _____   |
| Telephone number:                                  | _____   |
| Data about the administrator of the play equipment |   |
| Name:  | _____   |
| Address:   | _____   |
| Postcode and town:                                 | _____   |
| Contact person:                                    | _____   |
| Telephone number:                                  | _____   |

# LOGBOOK

## Inspection and maintenance intervals



| Nr. | Inspection   | Maintenance  | months between inspections |
|-----|--|--|----------------------------|
| 1   | Verify equipment's stability, junctions and missing parts. Inspect bolts, screws and nuts for absence, jams, corrosion and wear. | Add missing parts, secure joints, apply missing fixing agent and replace corroded parts. | 1                          |
| 2   | Check suspension for wear.   | Replace worn parts and/or remove non-functioning parts.                                  | 1                          |
| 3   | Inspect rotating parts such as hinges, rolling-element bearings, etc. for wear and acceptability.                                | Replace worn parts and/or remove non-functioning parts.                                  | 1                          |
| 4   | Check wood for splinters, unacceptable damage and signs of rot. Especially at ground level.                                      | Repair damage. Replace affected wood. Smoothen splintered wood and sharp edges.          | 1                          |
| 5   | Inspect foundation for stability, tearing and coverage.  | Restore foundation and covering material.  | 3                          |
| 6   | Examine rubber and synthetic parts for wear, damage and break.   | Replace original parts.  | 3                          |
| 7   | Inspect metal for corrosion and damage in the coating.   | Restore any damaged coating (after removing rust and applying primer).                   | 6                          |
| 8   | Check ropes, cables, chains and nets for wear and damage. Steel cables and nets which are tensioned must be checked for tension. | Replace parts where necessary. Steel cables and nets must be tensioned.                  | 3                          |
| 9   | Inspect equipment for unsafe changes and additions.  | Remove unsafe additions and correct unsafe changes.                                      | 1                          |
| 10  | Inspect safety surfaces.   | Restore and repair where necessary.  | 1                          |

## Remarks

1. If used intensively, all points require extra attention.
2. Extreme weather conditions and locations may require a higher inspection frequency. Discuss this with the supplier.
3. Vandalism-sensitive locations require stricter inspections, possibly daily.
4. Check the terrain regularly for items that do not belong there, are unsafe or may be used wrongly. Examples are poisonous plants, glass shards, etc. Frequency depends on strain.
5. Remember that bad maintenance leads to unsafe conditions and notably faster impoverishment of the playground area.
6. Replacement parts can be ordered at the manufacturer with the part numbers on the module drawing. Drawings can be found in de user guide.
7. The impact area shall be provided with impact attenuating surface according to the specified falling height.
8. This list is conform the CEN-standard "playground equipment and surfacing NEN-EN 1176-7".

# Certificaat

## KEURMERKINSTITUUT

### Warenwetbesluit attractie- en speeltoestellen

Certificaat van goedkeuring afgegeven door Keurmerkinstituut (aangewezen bij ministeriële beschikking van 8 juni 2004, VGB/P&L 2478562).

Certificaat nr.: 132567

Dossier nr.: 9248 Serie / Enkel: S

Betreft: T-schommel Anti-wrap

Aanduidingen: CSP.302.440.00001

Eigenaar/houder: Boer speeltoestellen b.v.  
Postbus 10  
4255 ZG Nieuwendijk

Soort toestel: T- schommel met 2 zittingen aan draaibare bovenbalken

Fabrikant: Boer speeltoestellen b.v., Nieuwendijk

Jaar van fabricage: 2013

Leverancier: Boer speeltoestellen b.v., Nieuwendijk

Jaar van leverantie: 2013

Datum keuring: 19 augustus 2013



Keurmerkinstituut, Groeneweg 2 te Zoetermeer, verklaart dat het bovenvermelde toestel voldoet aan de vervaardigingsvoorschriften genoemd in het Warenwetbesluit attractie- en speeltoestellen (Staatsblad 474, 27 september 1996).  
Beoordelingscriteria EN 1176-1:2008, EN 1176-2: 2008.

drs. W. van Weperen  
directeur



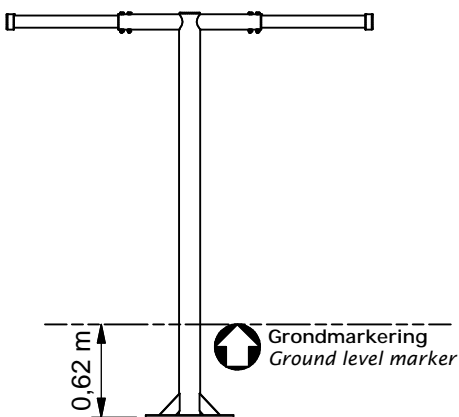
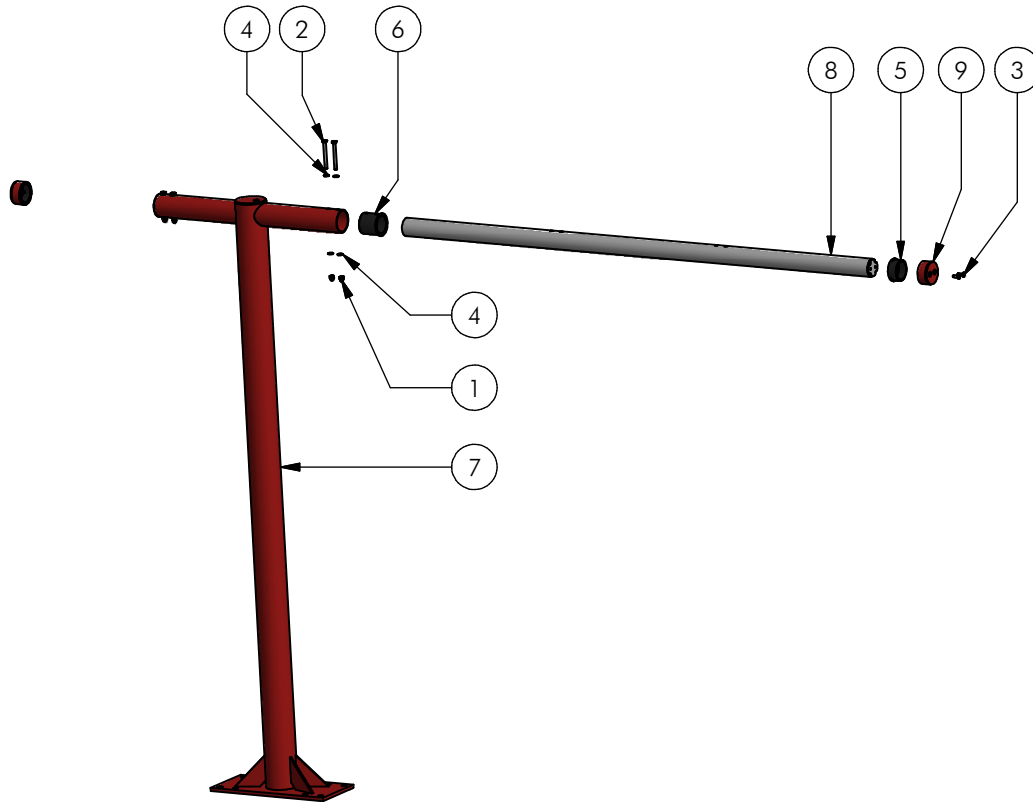

| Nr | # | Type | Progr. | Volgnr | Bew. | Rev. | Benaming             | Opmerking          |
|----|---|------|--------|--------|------|------|----------------------|--------------------|
| 1  | 4 | BSV  | 011    | 012    | 025  |      | Borgdopmoer          | M12 - VZ 8.8       |
| 2  | 4 | BSV  | 021    | 012    | 120  |      | Zeskantbout ISO 4014 | M12 x 120 - VZ 8.8 |
| 3  | 4 | BSV  | 024    | 010    | 030  |      | Verzonken bout       | M10 x 30 - VZ 8.8  |
| 4  | 8 | BSV  | 030    | 012    | 003  |      | Sluitring            | M12 - VZ 8.8       |
| 5  | 2 | KST  | UBP    | 200    | 005  | A    | Lagerring            | UBP Schommel       |
| 6  | 2 | KST  | UBP    | 200    | 006  | A    | Lagerring met gat    | Overgooi Schommel  |
| 7  | 1 | SME  | CSP    | 019    | 320  | B    | Staander             | T-Schommel         |
| 8  | 1 | SME  | CSP    | 020    |      | B    | As                   | T-Schommel         |
| 9  | 2 | SME  | CSP    | 021    | 320  |      | Eindstuk             | T-Schommel         |



Benaming  
Title: Staander

Opmerking  
Comment: T-Schommel

Datum  
Date: 27-2-2015

Tekening  
Drawing

**MOD CSP 023 320 B**  
 Samenstelling module Assembly module

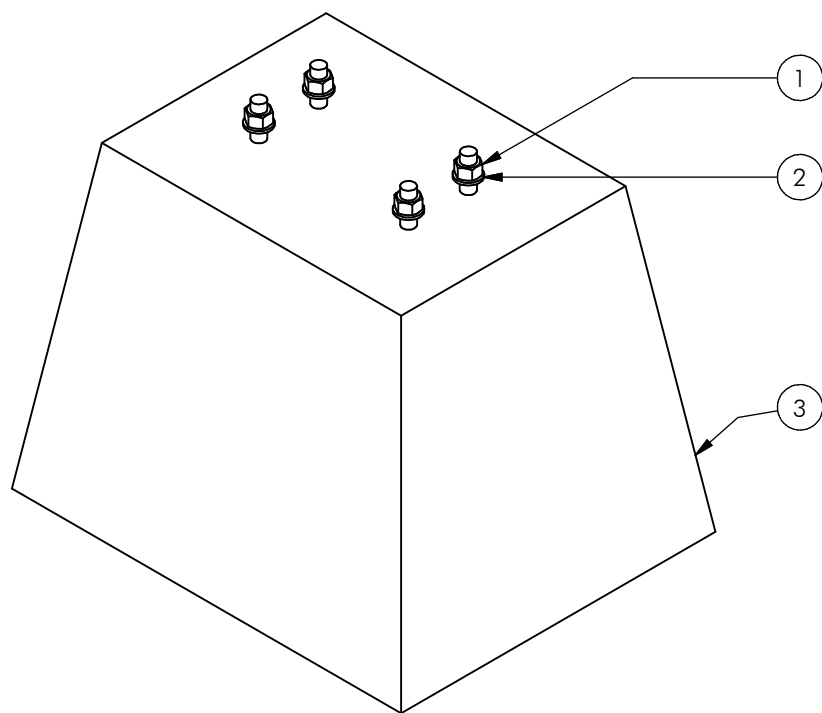

| Nr | # | Type | Progr. | Volgnr | Bew. | Rev. | Benaming    | Opmerking    |
|----|---|------|--------|--------|------|------|-------------|--------------|
| 1  | 4 | BSV  | 017    | 016    | 015  |      | Zeskantmoer | M16 - VZ 8.8 |
| 2  | 4 | BSV  | 030    | 016    | 003  |      | SLUITRING   | M16 x 3      |
| 3  | 1 | OBT  | POE    | 006    | 150  |      | Poermodel 6 | 9802050060   |



Benaming  
Title Poer model 6

Opmerking  
Comment 150 KG

Datum  
Date 5-3-2015

Tekening  
Drawing

**MOD OBT 006 001**

**Samenstelling module Assembly module**

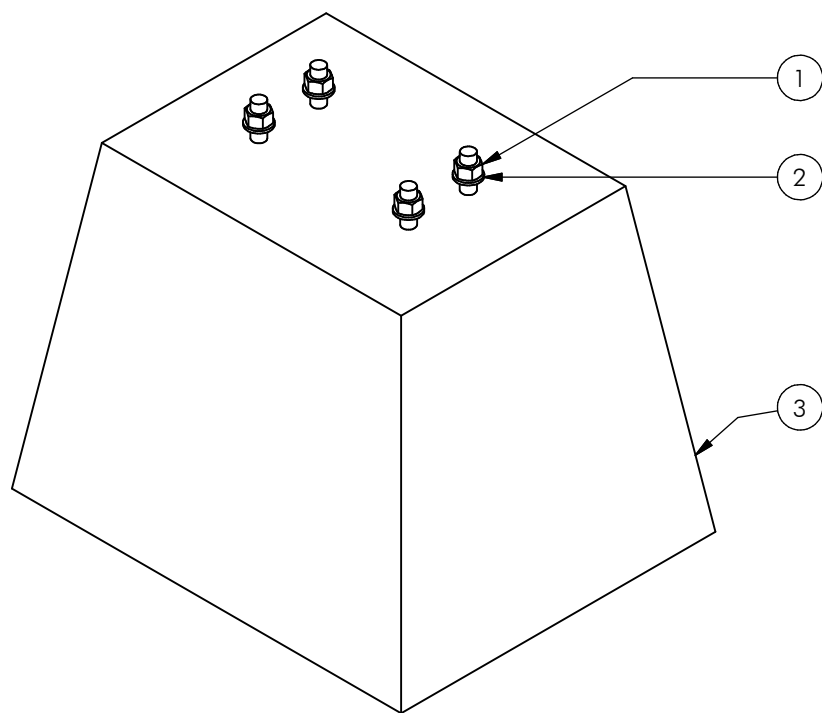

| Nr | # | Type | Progr. | Volgnr | Bew. | Rev. | Benaming    | Opmerking    |
|----|---|------|--------|--------|------|------|-------------|--------------|
| 1  | 4 | BSV  | 017    | 016    | 015  |      | Zeskantmoer | M16 - VZ 8.8 |
| 2  | 4 | BSV  | 030    | 016    | 003  |      | SLUITRING   | M16 x 3      |
| 3  | 1 | OBT  | POE    | 006    | 150  |      | Poermodel 6 | 9802050060   |



Benaming  
Title Poer model 6

Opmerking  
Comment 150 KG

Datum  
Date 5-3-2015

Tekening  
Drawing

**MOD OBT 006 001**

Samenstelling module *Assembly module*

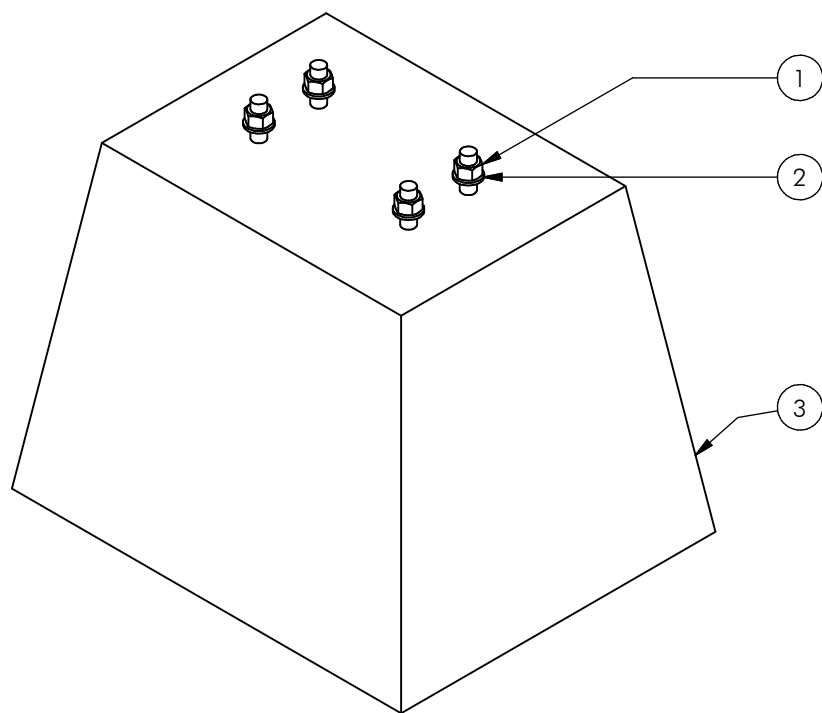

| Nr | # | Type | Progr. | Volgnr | Bew. | Rev. | Benaming    | Opmerking    |
|----|---|------|--------|--------|------|------|-------------|--------------|
| 1  | 4 | BSV  | 017    | 016    | 015  |      | Zeskantmoer | M16 - VZ 8.8 |
| 2  | 4 | BSV  | 030    | 016    | 003  |      | SLUITRING   | M16 x 3      |
| 3  | 1 | OBT  | POE    | 006    | 150  |      | Poermodel 6 | 9802050060   |



Benaming  
Title Poer model 6

Opmerking  
Comment 150 KG

Datum  
Date 5-3-2015

Tekening  
Drawing

**MOD OBT 006 001**

**Samenstelling module Assembly module**

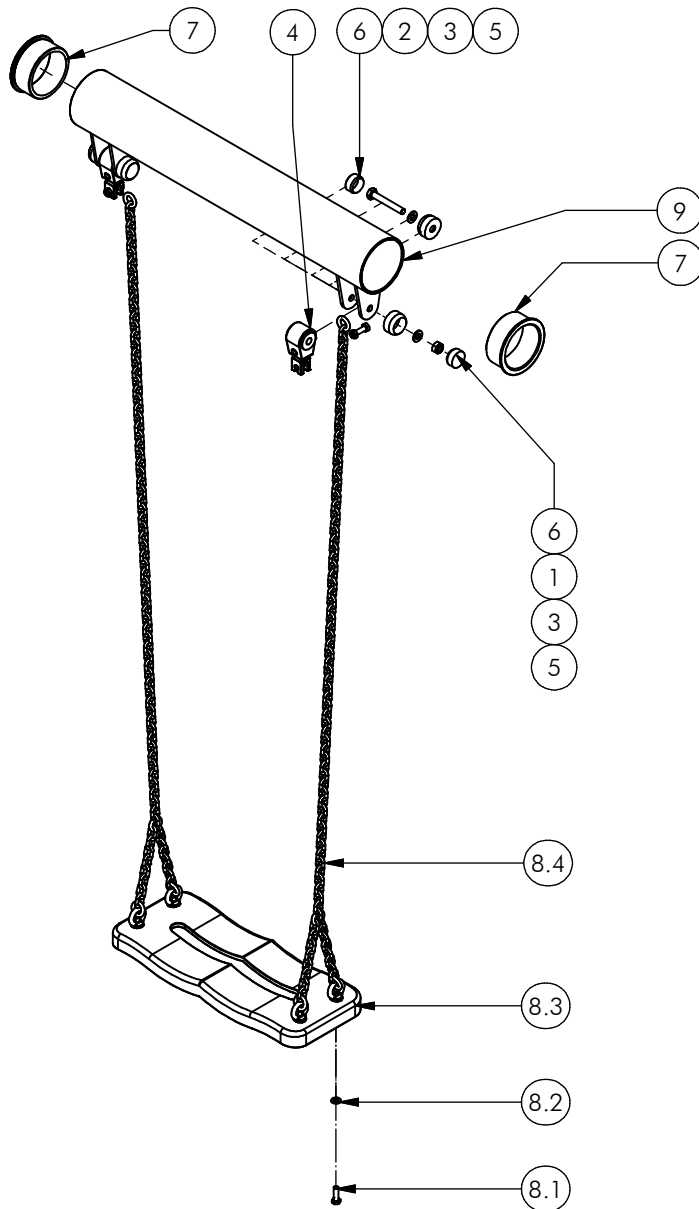

| Nr. | # | Type | Progr. | Volgnr | Bew. | Rev. | Benaming            | Opmerking            |
|-----|---|------|--------|--------|------|------|---------------------|----------------------|
| 1   | 2 | BSR  | 010    | 010    | 010  |      | Borgmoer            | M10 - RVS A2-70      |
| 2   | 2 | BSR  | 021    | 010    | 070  |      | Zeskantbout         | M10 x 70 - RVS A2-70 |
| 3   | 6 | BSR  | 030    | 010    | 002  |      | SLUITRING           | M10                  |
| 4   | 2 | BSR  | 081    | 012    | 090  |      | Schommelscharnier   | RVS A2-70            |
| 5   | 4 | KST  | DON    | 010    | 060  |      | Beschermdop M10-M12 | Donut zwart          |
| 6   | 4 | KST  | DOP    | 010    | 060  |      | Beschermdop M10-M12 | Dop zwart            |
| 7   | 2 | KST  | UBP    | 200    | 005  | A    | Lagerring           | UBP Schommel         |
| 8   | 1 | SMD  | ZIT    | 145    | 090  |      | Zitje incl. ketting |                      |
| 8.1 | 4 | BSR  | 021    | 008    | 025  |      | Zeskantbout         | M8 x 25 - RVS A2-70  |
| 8.2 | 4 | BSR  | 030    | 008    | 002  |      | Sluitring           | M8 - RVS A2-70       |
| 8.3 | 1 | CNK  | ZIT    | 001    | 090  |      | Schommelzitje CNK   | Zwart                |
| 8.4 | 2 | RNT  | KET    | 005    | 145  |      | Schommelketting 5mm | Met vork 1,45 m      |
| 9   | 1 | SME  | UBP    | 200    | 502  | D    | UBP Schommelbuis    | Schommel dubbel      |



Benaming Title Overgooizitje  
 Opmerking Comment ketting 145  
 Datum Date 19-4-2016

Tekening Drawing

**MOD SOL 030 532 B**  
 Samenstelling module Assembly module