

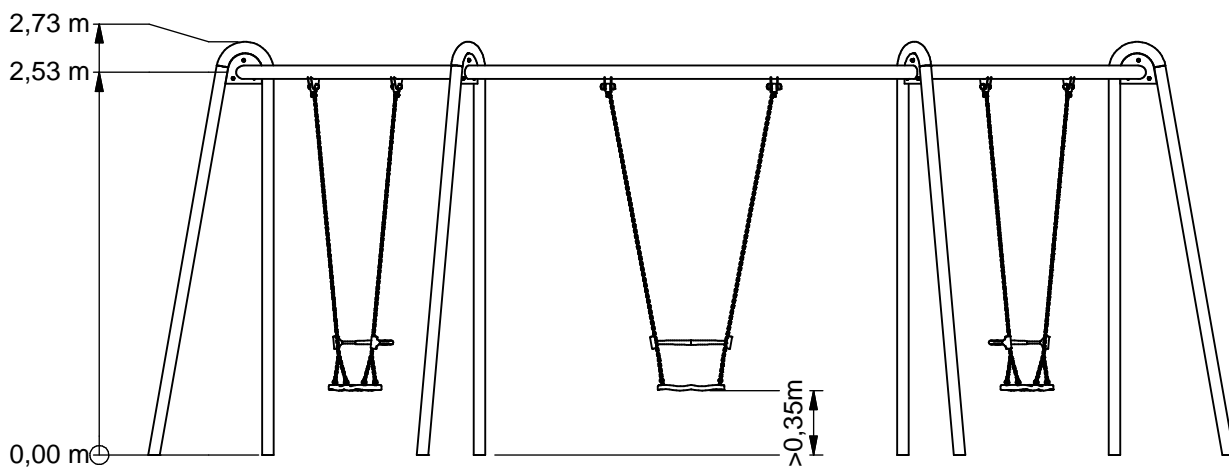

S2 Hexagon swing

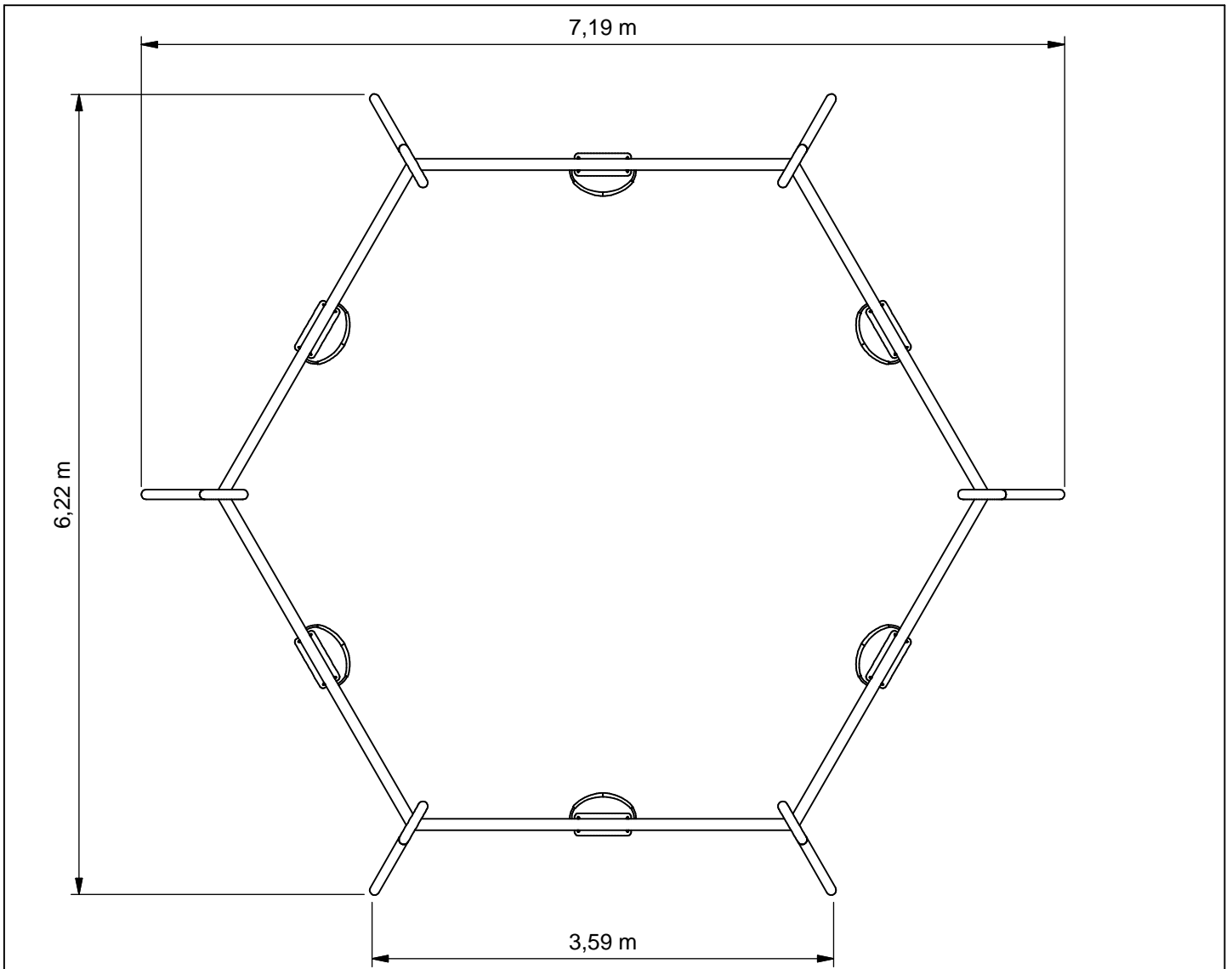

CSPE430.320



Benaming
Title | Zeskantschommel
Opmerking
Comment | Classic Play
Datum
Date | 2-3-2015

Tekening
Drawing

TOE CSP 430 320

Afmetingen Dimensions

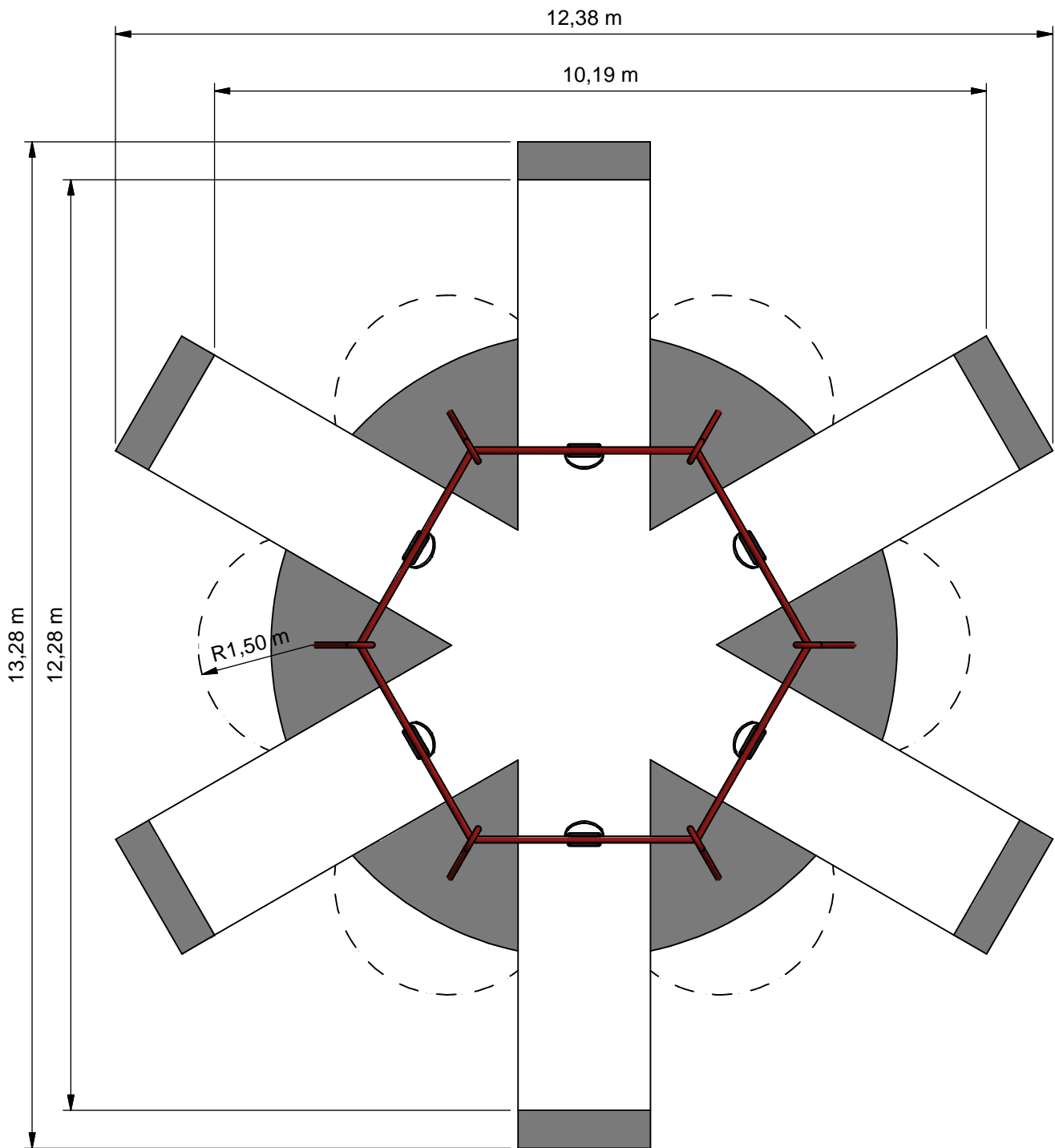

- Obstakelvrij EN-1176**
- Obstacle free EN-1176*
- Opvangzone**
- Impact area*
- Obstakelvrij WAS**
- Obstacle free WAS*



Benaming
Title Zeskantschommel

Opmerking
Comment Classic Play

Datum
Date 2-3-2015

Tekening
Drawing

TOE CSP 430 320

Obstakelvrije zone *Obstacle free zone*

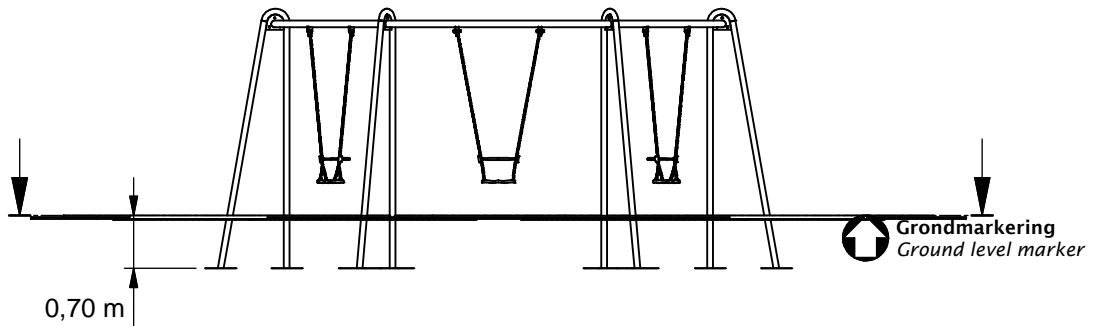
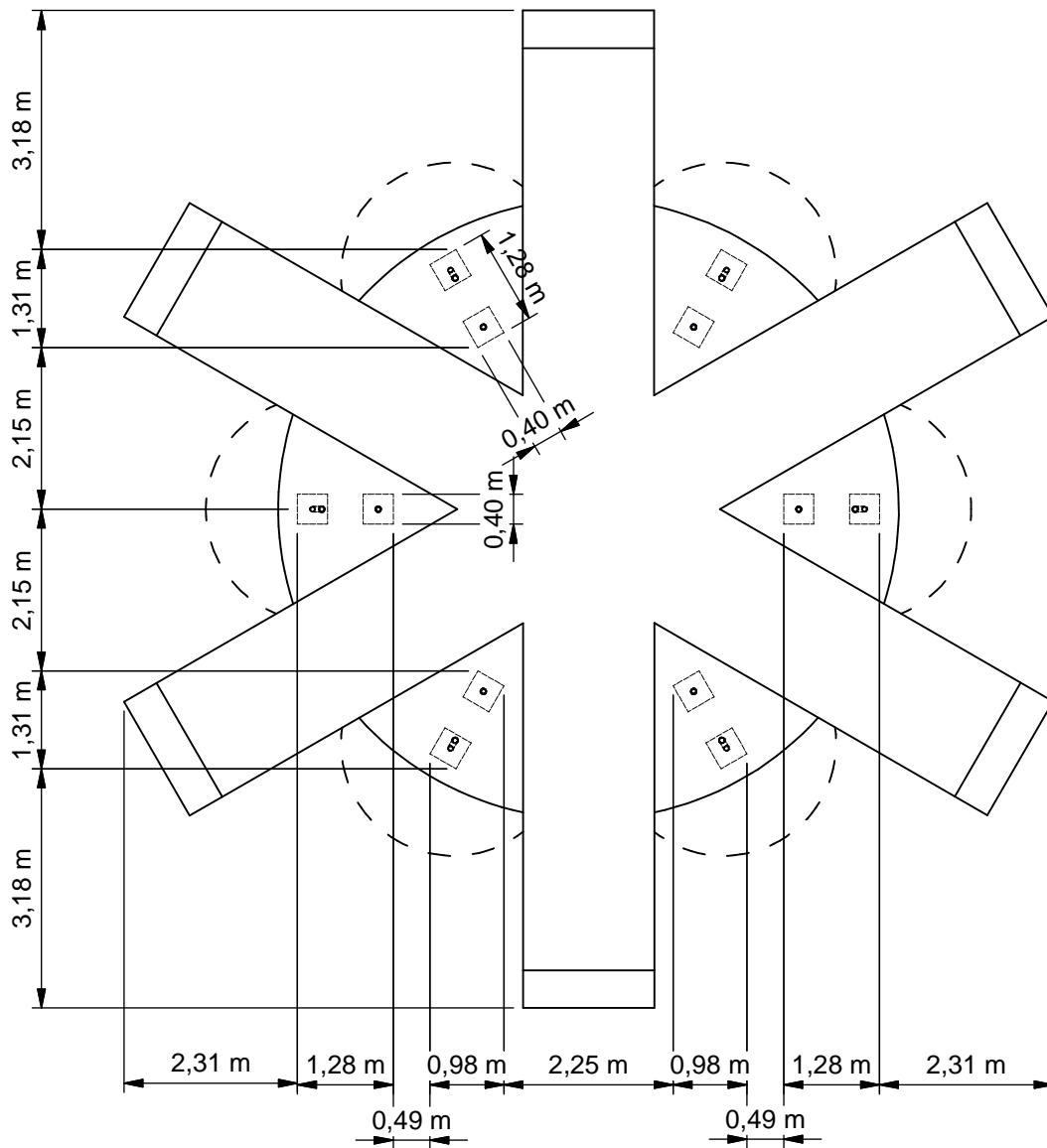

Benaming
Title Zeskantschommel

Opmerking
Comment Classic Play

Datum
Date 2-3-2015

Tekening
Drawing

TOE CSP 430 320

Bodemplan Groundplan

Geleverde modules:

Zie tabel

Supplied modules:

See table

Montageinstructie:

- De hoofdmaten geven de maten van de standers en vloeren aan
- De detailtekeningen geven specifiek de maten van de verbindingen aan
- De modules met buizen zijn op de tekeningen bemaat op bovenkant kopplaat
- Overige modules zijn bemaat op de bovenkant (klimwanden, paalkappen, etc.)

Assembly instruction:

- The main dimensions indicate the dimensions of the posts and floors
- The detailed dimensions show the specific dimensions of the connections
- The modules which contain tubes are dimensioned at the top of the flanges
- Other modules are dimensioned at the top (climbing walls, caps for the posts, etc.)

Montagevolgorde:

- 1 - Graaf de gaten volgens het bodemplan
- 2 - Plaats 1(6x)
- 3 - Plaats 2(6x) en verbind deze aan 1(6x)
- 4 - Controleer of het toestel voldoet aan de afmetingen zoals op blad 'afmetingen'
- 5 - Dicht de gaten en verdicht het zand

Assembly sequence:

- 1 - Dig the holes according to the ground plan
- 2 - Place 1(6x)
- 3 - Place 2(6x) and attach it to 1(6x)
- 4 - Check that the equipment conforms to the dimensions shown on sheet 'dimensions'
- 5 - Close the holes and compact the sand

Controles:

- 1 - Correcte opbouw en alle bevestigingsmiddelen
- 2 - Controleer de afmetingen van de valbodem t.o.v. het toestel
- 3 - Maat tussen maaiveld en schommelzitje < 350 mm

Checks:

- 1 - Correct assembly and all the fasteners
- 2 - Check the dimensions of the safety area with regard to the play equipment
- 3 - Distance between groundlevel and te seat of the swing < 350 mm

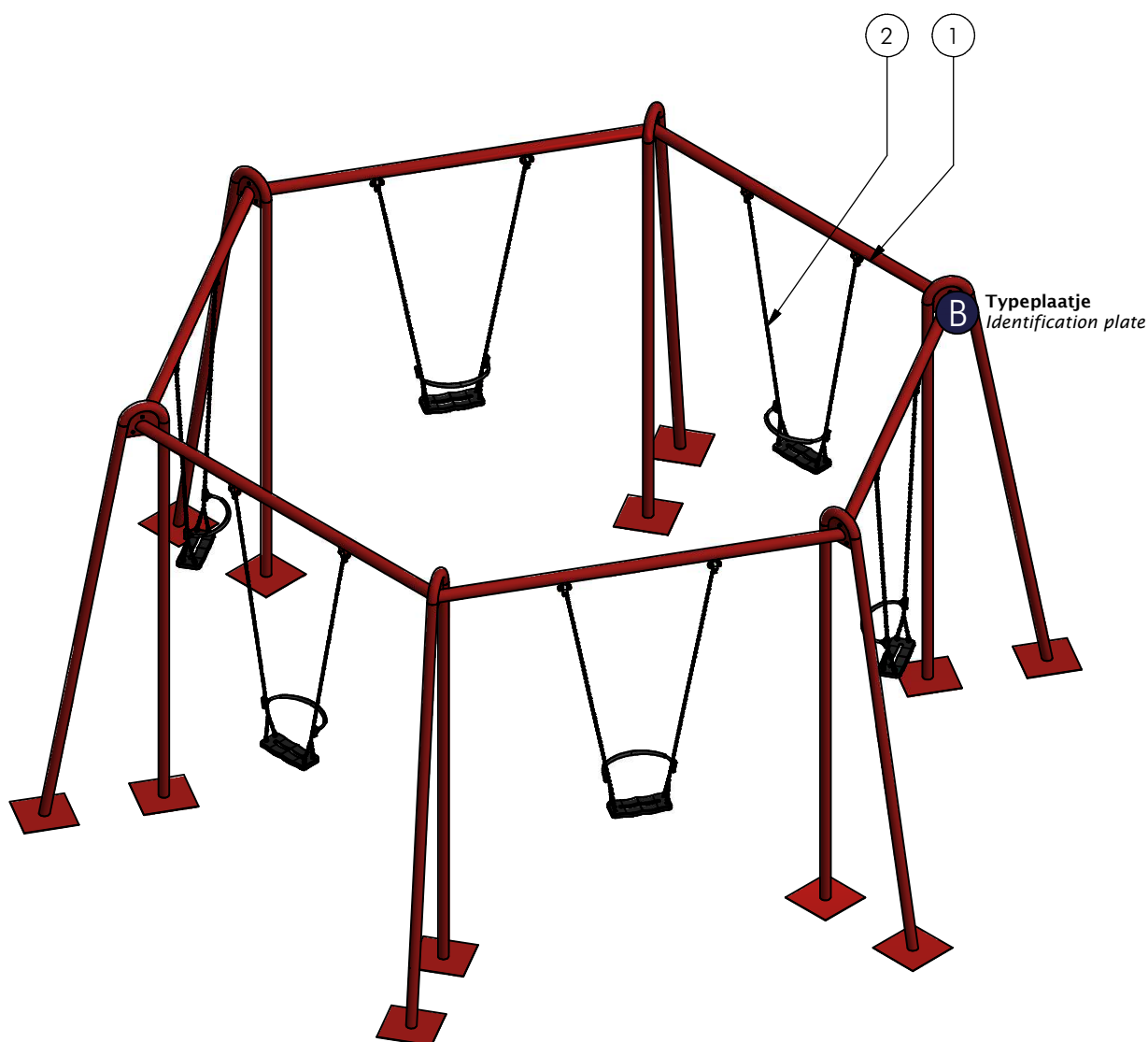

Nr	#	Type	Progr.	Volgnr	Bew.	Rev.	Benaming	Opmerking
1	6	MOD	CSP	008	320	B	Zeskantmodule	Zeskantschommel
2	6	MOD	SOL	030	531	A	Schommelzitje 6H	Ketting 2,0 m



Benaming
Title | Zeskantschommel

Opmerking
Comment | Classic Play

Datum
Date | 2-3-2015

Tekening
Drawing

TOE CSP 430 320

Modules Modules

CSPE430.320

S2 Hexagon swing

LOGBOOK

(Onderstaand logboek kan gebruikt worden om te voldoen aan de eisen, gesteld in artikel 14 van het Warenwetbesluit Attractie- en Speeltoestellen)

Type indication	Classic Play
Product code	CSPE430.320
Name of equipment	S2 zeskantschommel RAL3020
Maximum height of fall	1,5 m
Year of construction	2017
Certificate	131679
inspection authority	Keurmerkinstituut Groeneweg 2e, Zoetermeer - 2718AA Zoetermeer
Name manufacturer	BOERplay Hyacintstraat 2 - 4255 HX Nieuwendijk Phone: +31 (0)183 40 23 66 Fax: +31 (0)183 40 35 64
name installer	_____ _____
Description of equipment	S2 Hexagon swing
Location of equipment	_____
Data about the owner of the play equipment	
Name:	_____
Address:	_____
Postcode and town:	_____
Contact person:	_____
Telephone number:	_____
Data about the administrator of the play equipment	
Name:	_____
Address:	_____
Postcode and town:	_____
Contact person:	_____
Telephone number:	_____

LOGBOOK

Inspection and maintenance intervals



Nr.	Inspection	Maintenance	months between inspections
1	Verify equipment's stability, junctions and missing parts. Inspect bolts, screws and nuts for absence, jams, corrosion and wear.	Add missing parts, secure joints, apply missing fixing agent and replace corroded parts.	1
2	Check suspension for wear.	Replace worn parts and/or remove non-functioning parts.	1
3	Inspect rotating parts such as hinges, rolling-element bearings, etc. for wear and acceptability.	Replace worn parts and/or remove non-functioning parts.	1
4	Check wood for splinters, unacceptable damage and signs of rot. Especially at ground level.	Repair damage. Replace affected wood. Smoothen splintered wood and sharp edges.	1
5	Inspect foundation for stability, tearing and coverage.	Restore foundation and covering material.	3
6	Examine rubber and synthetic parts for wear, damage and break.	Replace original parts.	3
7	Inspect metal for corrosion and damage in the coating.	Restore any damaged coating (after removing rust and applying primer).	6
8	Check ropes, cables, chains and nets for wear and damage. Steel cables and nets which are tensioned must be checked for tension.	Replace parts where necessary. Steel cables and nets must be tensioned.	3
9	Inspect equipment for unsafe changes and additions.	Remove unsafe additions and correct unsafe changes.	1
10	Inspect safety surfaces.	Restore and repair where necessary.	1

Remarks

1. If used intensively, all points require extra attention.
2. Extreme weather conditions and locations may require a higher inspection frequency. Discuss this with the supplier.
3. Vandalism-sensitive locations require stricter inspections, possibly daily.
4. Check the terrain regularly for items that do not belong there, are unsafe or may be used wrongly. Examples are poisonous plants, glass shards, etc. Frequency depends on strain.
5. Remember that bad maintenance leads to unsafe conditions and notably faster impoverishment of the playground area.
6. Replacement parts can be ordered at the manufacturer with the part numbers on the module drawing. Drawings can be found in de user guide.
7. The impact area shall be provided with impact attenuating surface according to the specified falling height.
8. This list is conform the CEN-standard "playground equipment and surfacing NEN-EN 1176-7".

Certificaat

KEURMERKINSTITUUT

Warenwetbesluit attractie- en speeltoestellen

Certificaat van goedkeuring afgegeven door Keurmerkinstituut (aangewezen bij ministeriële beschikking van 8 juni 2004, VGB/P&L 2478562).

Certificaat nr.: 131679

Dossier nr.: 8411 Serie / Enkel: S

Betreft: Zeskantschommel

Aanduidingen: CP 302.430

Eigenaar/houder: Boer speeltoestellen b.v.
Postbus 10
4255 ZG Nieuwendijk

Soort toestel: Metalen zeskantschommel

Fabrikant: Boer speeltoestellen b.v., Nieuwendijk

Jaar van fabricage: 2012

Leverancier: Boer speeltoestellen b.v., Nieuwendijk

Jaar van leverantie: 2012

Datum keuring: 10 september 2012

Keurmerkinstituut, Groeneweg 2 te Zoetermeer, verklaart dat het bovenvermelde toestel voldoet aan de vervaardigingsvoorschriften genoemd in het Warenwetbesluit attractie- en speeltoestellen (Staatsblad 474, 27 september 1996). Beoordelingscriteria EN 1176-1:2008, EN 1177:2008.

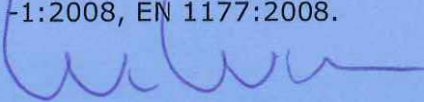
drs. W. van Weperen
directeur

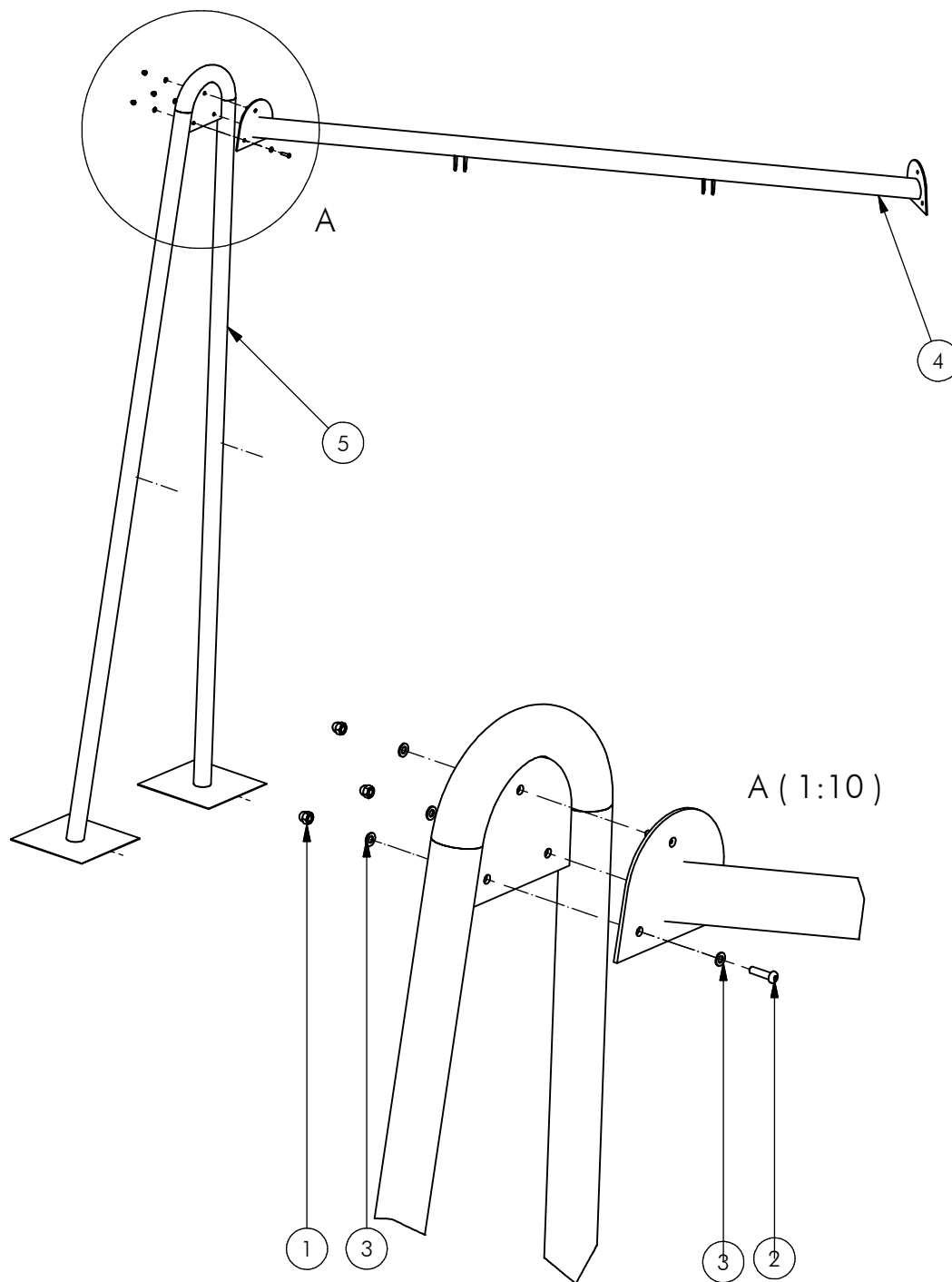

Nr	#	Type	Progr.	Volgnr	Bew.	Rev.	Benaming	Opmerking
1	3	BSR	011	010	020		DOPMOER	BORG RVS M10
2	3	BSR	023	010	040		Bolkopbout ISO 7380	M10 x 40 - RVS A2-70
3	6	BSR	030	010	002		Sluitring	M10 - RVS A2-70
4	1	SME	CSP	004	320	A	Bovenbalk Mid	Zesk.schommel
5	1	SME	CSP	005	320		Staander	doorbouwschommel



Benaming
Title Zeskantmodule

Opmerking
Comment Zeskantschommel

Datum
Date 27-2-2015

Tekening
Drawing

MOD CSP 008 320 B
 Samenstelling module *Assembly module*

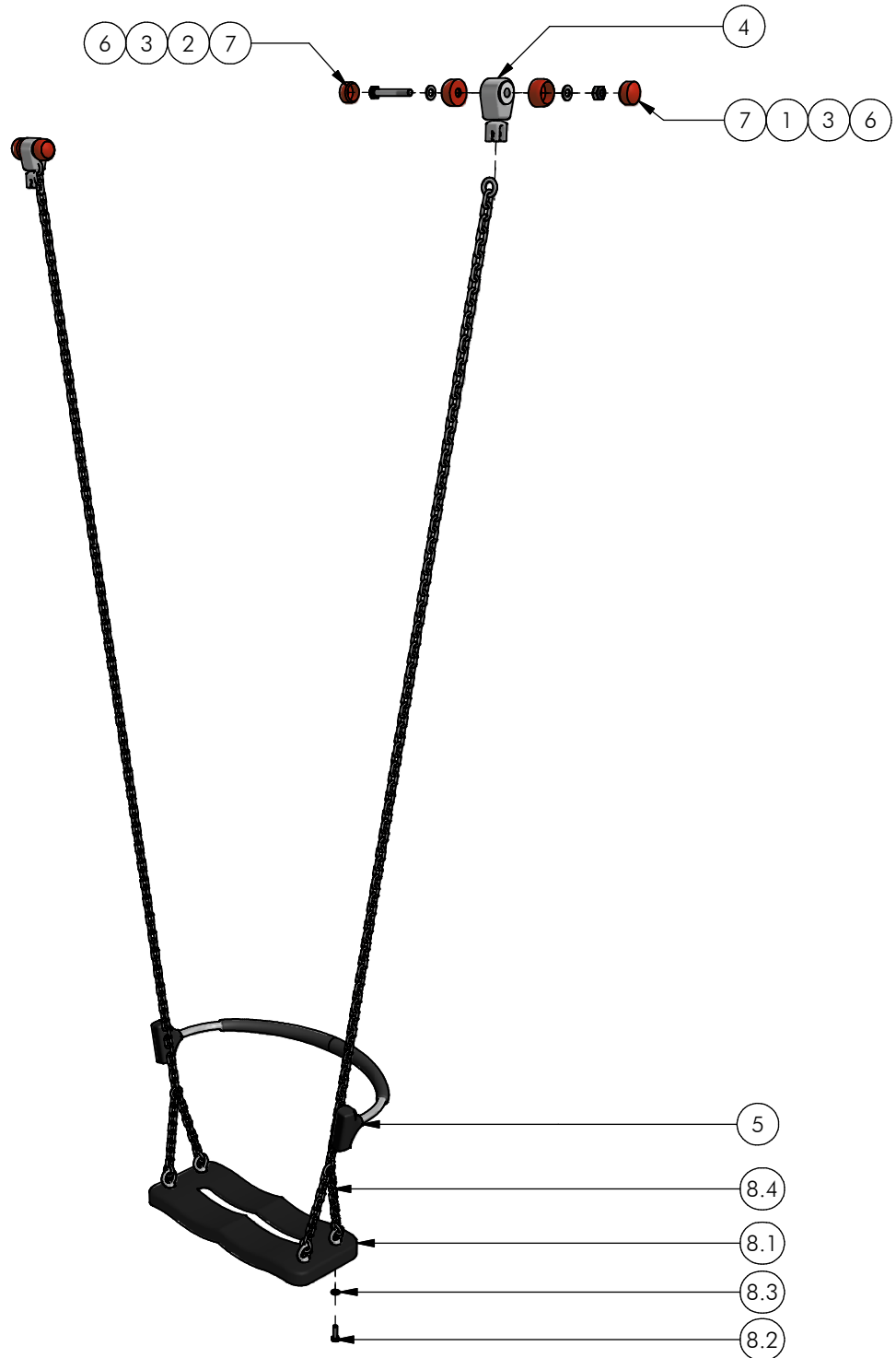

Nr.	#	Type	Progr.	Volgnr	Bew.	Rev.	Benaming	Opmerking
1	2	BSR	010	010	010		Borgmoer	M10 - RVS A2-70
2	2	BSR	021	010	070		Zeskantbout	M10 x 70 - RVS A2-70
3	4	BSR	030	010	002		Sluitring	M10 - RVS A2-70
4	2	BSR	081	012	090		Schommelscharnier	RVS A2-70
5	1	DRD	JMP	BEV	001		Afspringbeveiliging	Contactschommels
6	4	KST	DON	010	030		Beschermdop M10-M12	Donut Rood
7	4	KST	DOP	010	030		Beschermdop M10-M12	Dop rood
8	1	SMD	ZIT	200	090		Zitje incl Ketting	
8.1	1	CNK	ZIT	001	090		Schommelzitje CNK	Zwart
8.2	4	BSR	021	008	025		Zeskantbout	M8 x 25 - RVS A2-70
8.3	4	BSR	030	008	016		Sluitring	M8 - RVS A2-70
8.4	2	RNT	KET	005	200		Schommelketting 5mm	Met vork 2,0 m



Benaming
Title Schommelzitje 6H

Opmerking
Comment Ketting 2,0 m

Datum
Date 3-3-2015

Tekening
Drawing

MOD SOL 030 531 A
 Samenstelling module Assembly module