

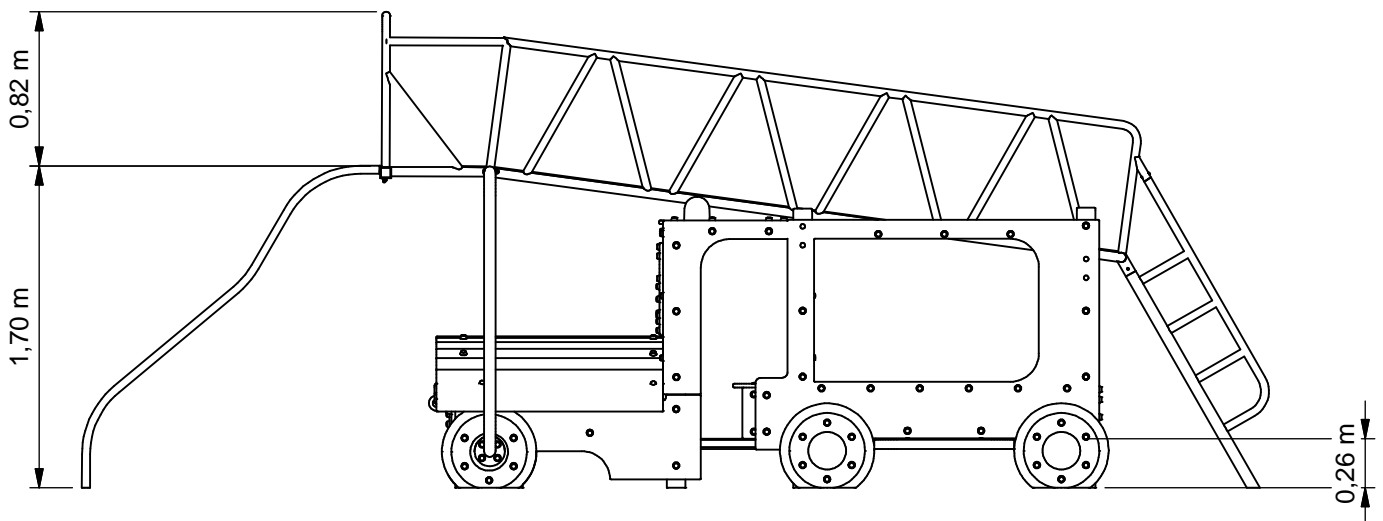

Fire truck

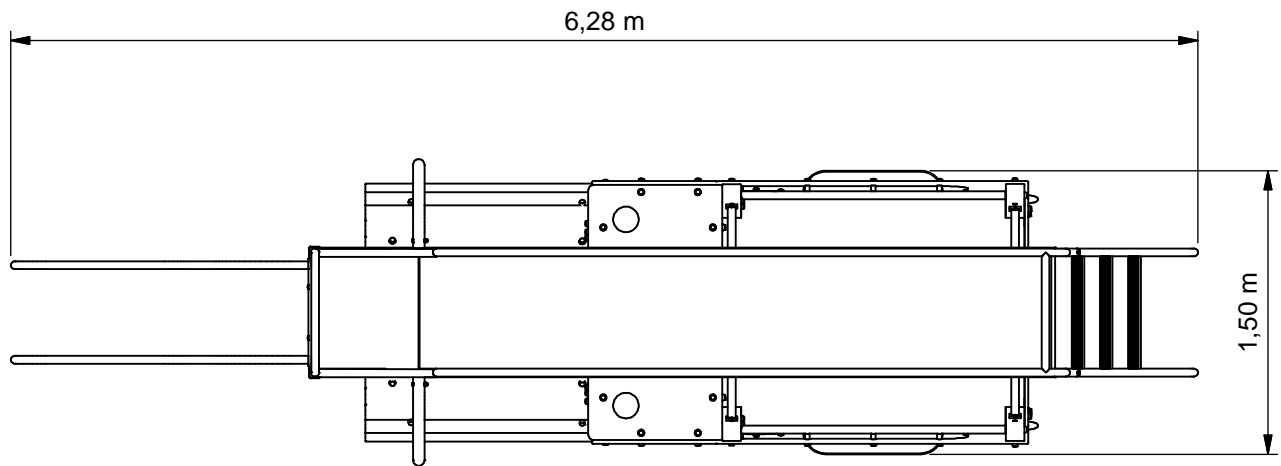

MNPE407.001



Benaming
Title Brandweer

Opmerking
Comment Mini Play

Datum
Date 9-10-2015

Tekening
Drawing

TOE MNP 407 001

Hoofdafmetingen Main dimensions

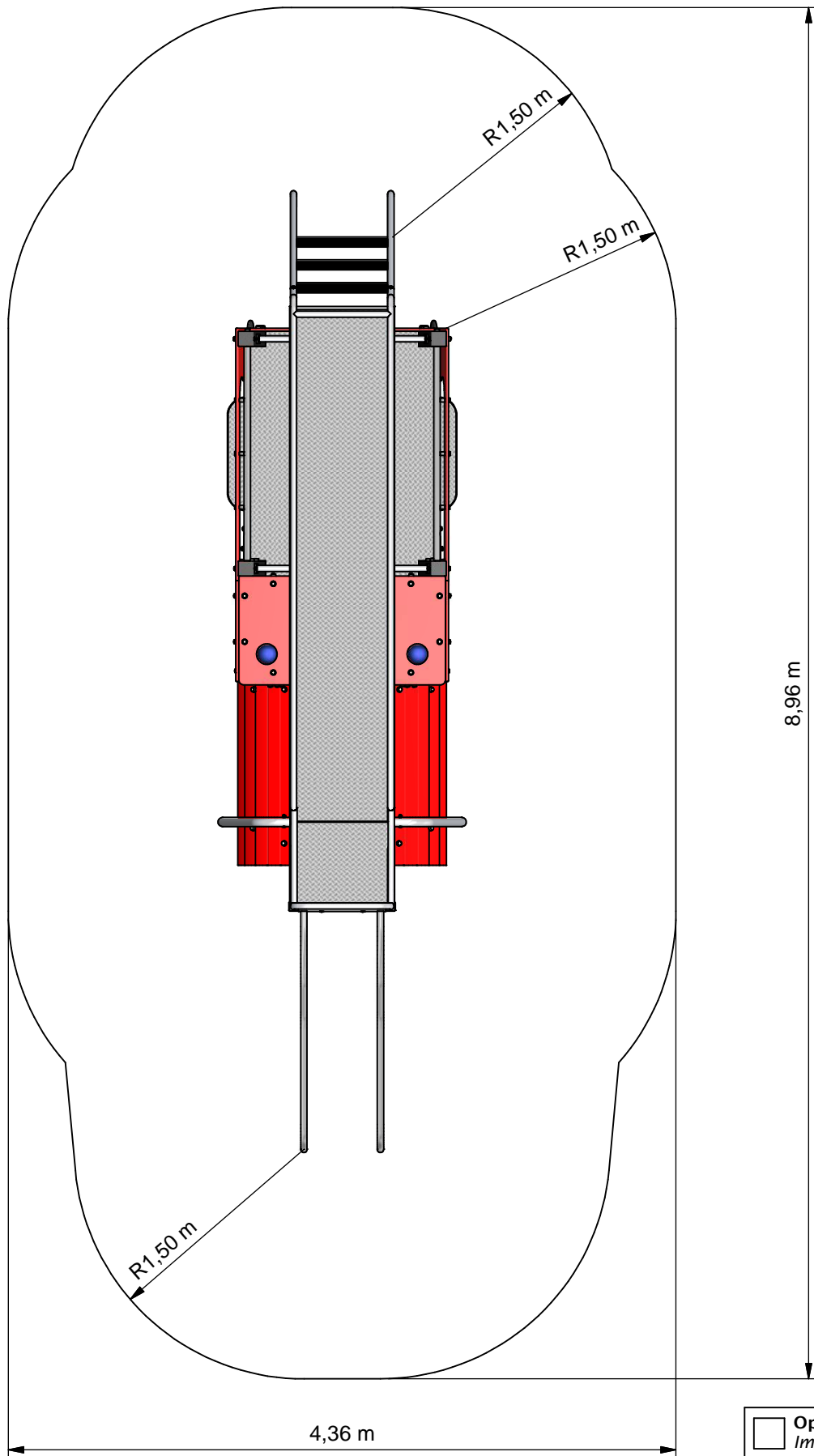

- Opvangzone
Impact area
- Obstakelvrije zone
Obstacle free zone



Benaming Title Brandweer
 Opmerking Comment Mini Play
 Datum Date 9-10-2015

Tekening Drawing

TOE MNP 407 001

Obstakelvrije zone Obstacle free zone

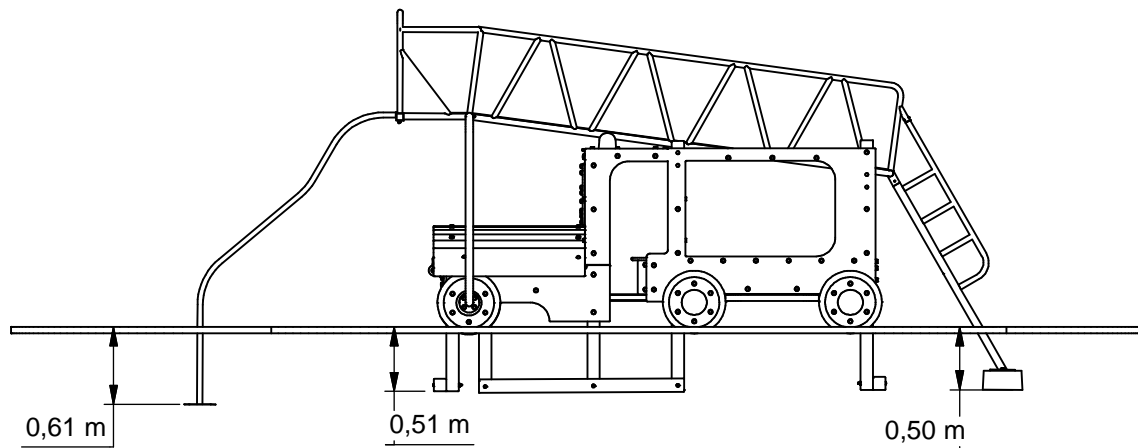
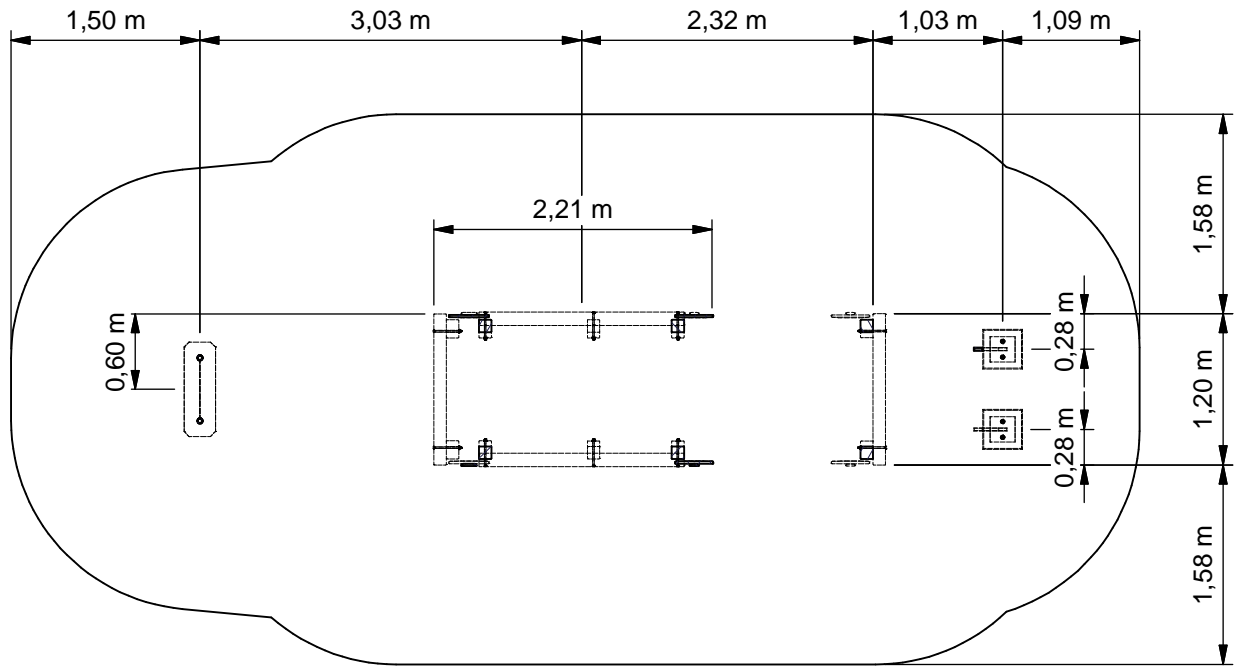

Benaming
Title Brandweer

Opmerking
Comment Mini Play

Datum
Date 9-10-2015

Tekening
Drawing

TOE MNP 407 001

Bodemplan Groundplan

Geleverde modules:

Zie tabel

Supplied modules:

See table

Montageinstructie:

- De modules kunnen correct geassembleerd worden met de voorgeboorde gaten.

Assembly instruction:

- The modules can be assembled correctly using the predrilled holes.

Montagevolgorde:

- 1 - Assembleer brandweer(1,2,3,4,5,6,7,8,10,11)
- 2 - Graaf de gaten volgens het bodemplan
- 3 - Plaats brandweer
- 4 - Assembleer en plaats 9+12 en verbind deze aan de brandweer
- 5 - Controleer of het toestel voldoet aan de afmetingen zoals op blad 'afmetingen'
- 6 - Dicht de gaten en verdicht het zand

Assembly sequence:

- 1 - Assemble firetruck (1,2,3,4,5,6,7,8,10,11)
- 2 - Dig the holes according to the ground plan
- 3 - Place firetruck
- 4 - Assemble and place 9+12 and attach the to the firetruck
- 5 - Check that the equipment conforms to the dimensions shown on sheet 'dimensions'
- 6 - Close the holes and compact the sand

Controles:

- 1 - Correcte opbouw en alle bevestigingsmiddelen
- 2 - Controleer de afmetingen van de valbodem t.o.v. het toestel

Checks:

- 1 - Correct assembly and all the fasteners
- 2 - Check the dimensions of the safety area with regard to the play equipment

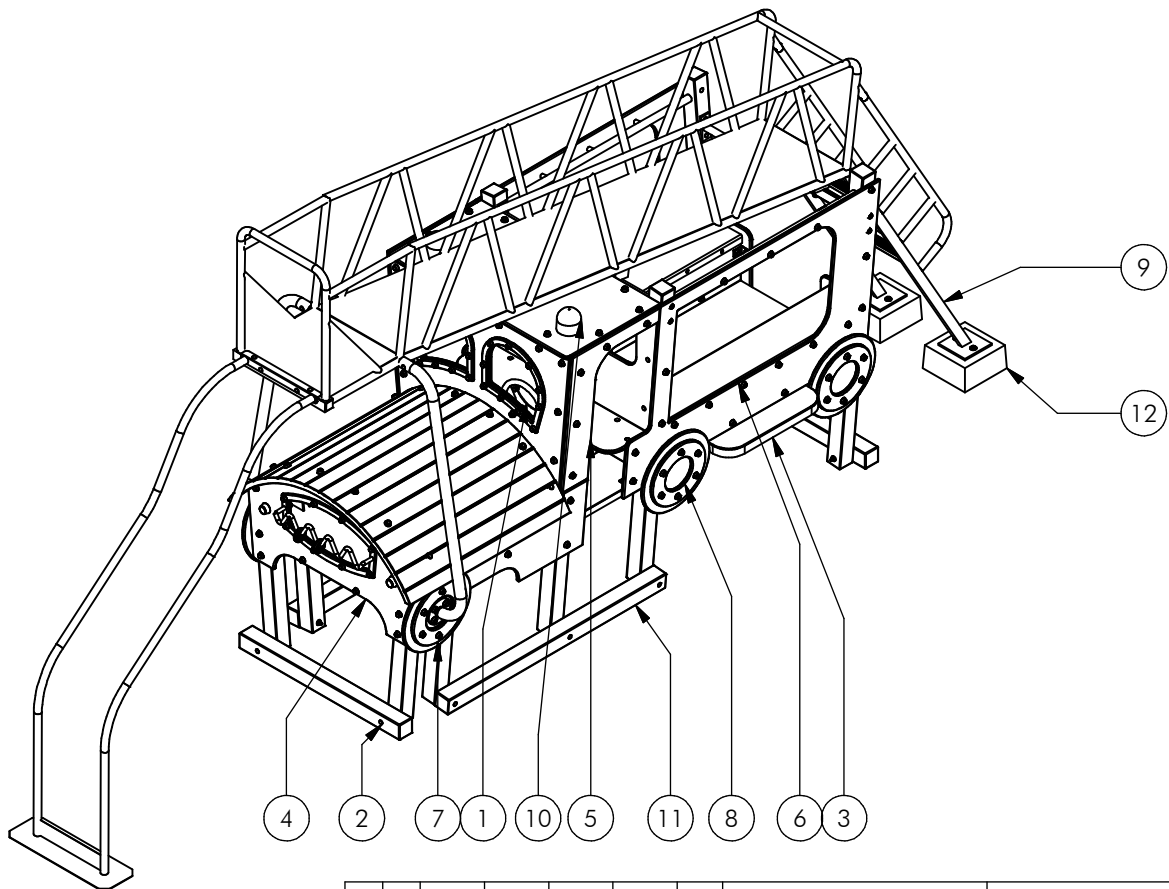

Nr	#	Type	Progr.	Volgnr	Bew.	Rev.	Benaming	Opmerking
1	1	MOD	MNP	341	012		Stuur	Tractor
2	10	MOD	MNP	341	021		Bevestiging	Schoren
3	1	MOD	MNP	341	043		Vloer	Brandweer
4	1	MOD	MNP	341	044		Motor	Brandweer
5	1	MOD	MNP	341	045		Cabine	Brandweer
6	1	MOD	MNP	341	046		Achterkant	Brandweer
7	2	MOD	MNP	341	047		Voorwiel	Brandweer
8	4	MOD	MNP	341	048		Achterwiel	Brandweer
9	1	MOD	MNP	341	049		Trap+glijstang	Brandweer
10	2	MOD	MNP	341	050		Zwaailicht	Brandweer
11	1	MOD	MNP	407	001		Rebo pakket	Brandweer
12	2	MOD	OBT	009	001		Poer Model 9	Gewicht 33,5 kg



Benaming
Title Brandweer

Opmerking
Comment Mini Play

Datum
Date 9-10-2015

Tekening
Drawing

TOE MNP 407 001

Modules Modules

MNPE407.001

Fire truck

LOGBOOK

(Onderstaand logboek kan gebruikt worden om te voldoen aan de eisen, gesteld in artikel 14 van het Warenwetbesluit Attractie- en Speeltoestellen)

Type indication	Mini Play
Product code	MNPE407.001
Name of equipment	AP Brandweerauto
Maximum height of fall	1,7 m
Year of construction	2017
Certificate	633129
inspection authority	Aib Vincotte Nederland Takkebijsters 8, Breda - 4817 BL Breda
Name manufacturer	BOERplay Hyacintstraat 2 - 4255 HX Nieuwendijk Phone: +31 (0)183 40 23 66 Fax: +31 (0)183 40 35 64
name installer	_____ _____
Description of equipment	Fire truck
Location of equipment	_____
Data about the owner of the play equipment	
Name:	_____
Address:	_____
Postcode and town:	_____
Contact person:	_____
Telephone number:	_____
Data about the administrator of the play equipment	
Name:	_____
Address:	_____
Postcode and town:	_____
Contact person:	_____
Telephone number:	_____

LOGBOOK

Inspection and maintenance intervals



Nr.	Inspection	Maintenance	months between inspections
1	Verify equipment's stability, junctions and missing parts. Inspect bolts, screws and nuts for absence, jams, corrosion and wear.	Add missing parts, secure joints, apply missing fixing agent and replace corroded parts.	1
2	Check suspension for wear.	Replace worn parts and/or remove non-functioning parts.	1
3	Inspect rotating parts such as hinges, rolling-element bearings, etc. for wear and acceptability.	Replace worn parts and/or remove non-functioning parts.	1
4	Check wood for splinters, unacceptable damage and signs of rot. Especially at ground level.	Repair damage. Replace affected wood. Smoothen splintered wood and sharp edges.	1
5	Inspect foundation for stability, tearing and coverage.	Restore foundation and covering material.	3
6	Examine rubber and synthetic parts for wear, damage and break.	Replace original parts.	3
7	Inspect metal for corrosion and damage in the coating.	Restore any damaged coating (after removing rust and applying primer).	6
8	Check ropes, cables, chains and nets for wear and damage. Steel cables and nets which are tensioned must be checked for tension.	Replace parts where necessary. Steel cables and nets must be tensioned.	3
9	Inspect equipment for unsafe changes and additions.	Remove unsafe additions and correct unsafe changes.	1
10	Inspect safety surfaces.	Restore and repair where necessary.	1

Remarks

1. If used intensively, all points require extra attention.
2. Extreme weather conditions and locations may require a higher inspection frequency. Discuss this with the supplier.
3. Vandalism-sensitive locations require stricter inspections, possibly daily.
4. Check the terrain regularly for items that do not belong there, are unsafe or may be used wrongly. Examples are poisonous plants, glass shards, etc. Frequency depends on strain.
5. Remember that bad maintenance leads to unsafe conditions and notably faster impoverishment of the playground area.
6. Replacement parts can be ordered at the manufacturer with the part numbers on the module drawing. Drawings can be found in de user guide.
7. The impact area shall be provided with impact attenuating surface according to the specified falling height.
8. This list is conform the CEN-standard "playground equipment and surfacing NEN-EN 1176-7".

CERTIFICAAT VAN GOEDKEURING

Afgegeven door AIB-Vinçotte Nederland B.V., aangewezen bij ministeriële beschikking van het Ministerie van Volksgezondheid, Welzijn en Sport, van 29 maart 2001 onder kenmerk GZB/C&O/2162178.

Het certificaat betreft de keuring van een typekenmerkend speeltoestel.

Certificaat nr. : 633129
Afgifte datum cert. : 05 mei 2009
Dossier- rapport nr. : 633129
Datum keuring : 10 oktober 2008
Betreft : Inter Play Type Nr. : 34.1.407.XXXXX
Soort toestel : Combinatietoestel met glijstang NEN-EN 1176-1 + 3 (1998)
Eigenaar - houder :

Fabrikant : Boer Speeltoestellen B.V.
Postbus 10 4255 ZG NIEUWENDIJK (NL)

Jaar van fabricage :

Leverancier : Boer Speeltoestellen B.V.
Postbus 10 4255 ZG NIEUWENDIJK (NL)

Jaar van leverantie :

Dit certificaat is onbeperkt geldig

AIB-Vinçotte Nederland B.V. gevestigd aan de Heusing 2 te Breda, verklaart dat het bovenbeschreven toestel voldoet aan de vervaardigingsvoorschriften genoemd in het "Warenwetbesluit Attractie- en Speeltoestellen"

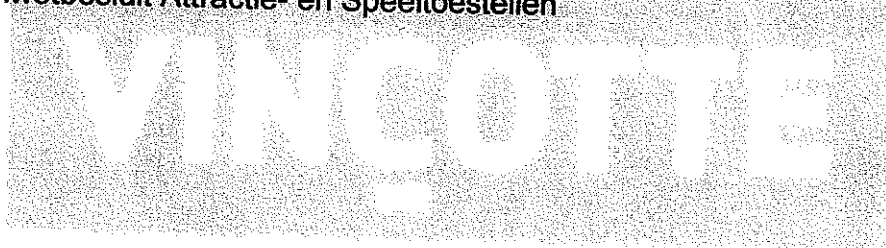

AIB-Vinçotte Nederland B.V.
Namens het bestuur,

R. van Hirtum
Afdelingsmanager

M. Verheijen
Inspecteur

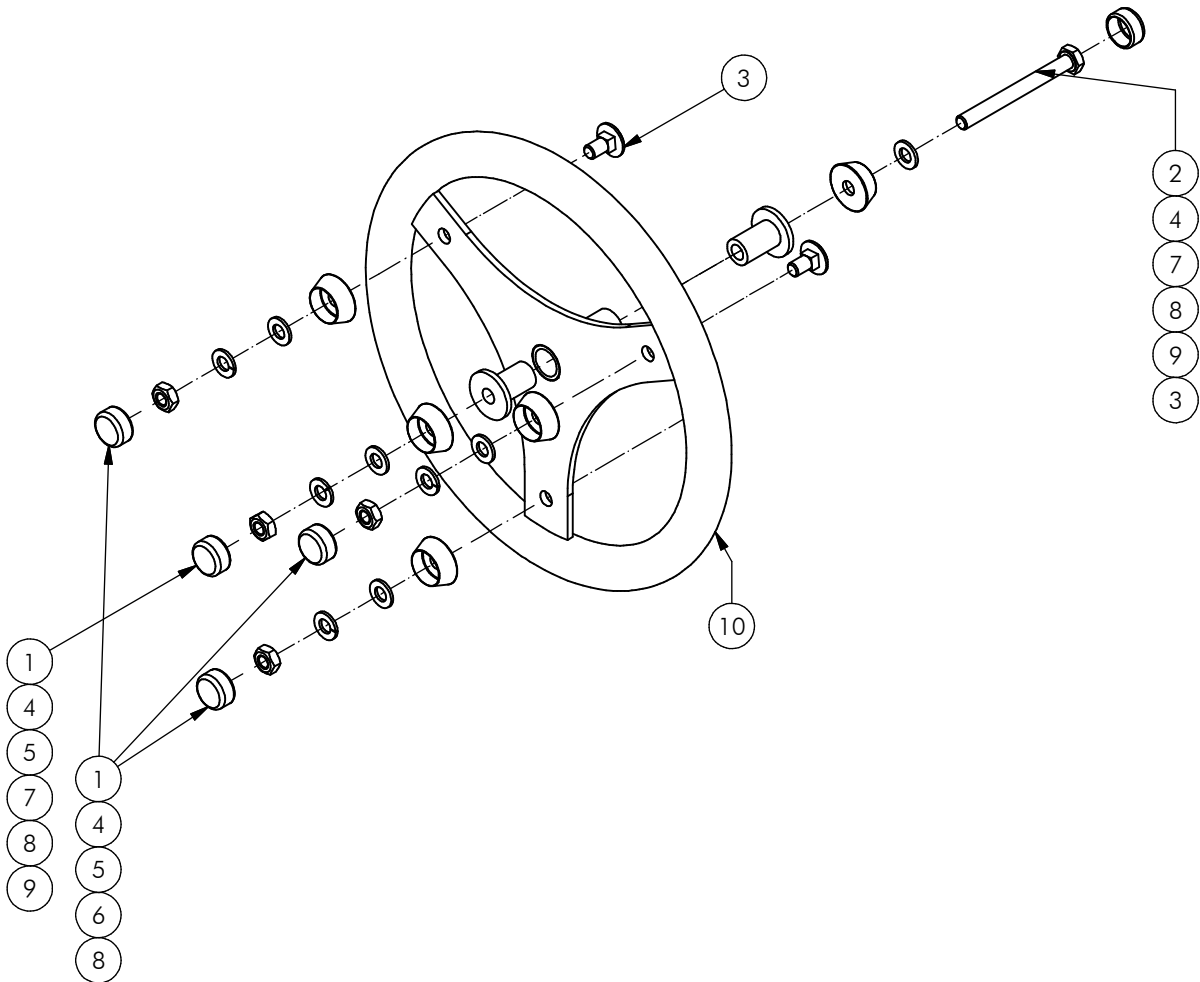

Nr	#	Type	Progr.	Volgnr	Bew.	Rev.	Benaming	Opmerking
1	4	BSV	017	010	008		Zeskantmoer	M10 - VZ 8.8
2	1	BSV	021	010	100		Zeskantbout ISO 4014	M10 x 100 - VZ 8.8
3	3	BSV	026	010	020		Slotbout	M10 x 20 - VZ 8.8
4	5	BSV	030	010	002		Sluiring	M10 - VZ 8.8
5	4	BSV	032	010	002		Veerring	M10 - VZ 8.8
6	3	KST	DON	011	090		interplay donut	zwart
7	2	KST	DON	011	030		interplay donut M10 rood	84395000022
8	5	KST	DOP	011	030		interplay dop M10 rood	84395000024
9	2	KST	MNP	204	PA6		Lagerbus Ø35/19	L= 35 mm
10	1	SME	MNP	091	906		Stuur	Tractor



Benaming
Title | Stuur

Opmerking
Comment | Tractor

Datum
Date | 4-6-2015

Tekening
Drawing

MOD MNP 341 012

Samenstelling module *Assembly module*

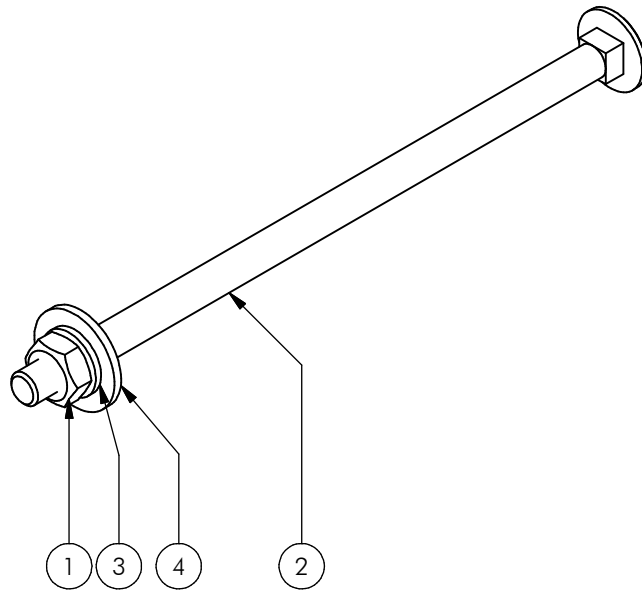

Nr	#	Type	Progr.	Volgnr	Bew.	Rev.	Benaming	Opmerking
1	1	BSV	017	010	008		Zeskantmoer	M10 - VZ 8.8
2	1	BSV	026	010	220		Slotbout	M10 x 220 - VZ 8.8
3	1	BSV	032	010	002		Veerring	M10 - VZ 8.8
4	1	BSV	035	010	030		Carrosseriering	M10 x 30 - VZ 8.8



Benaming
Title Bevestiging

Opmerking
Comment Schoren

Datum
Date 1-10-2015

Tekening
Drawing

MOD MNP 341 021

Samenstelling module *Assembly module*

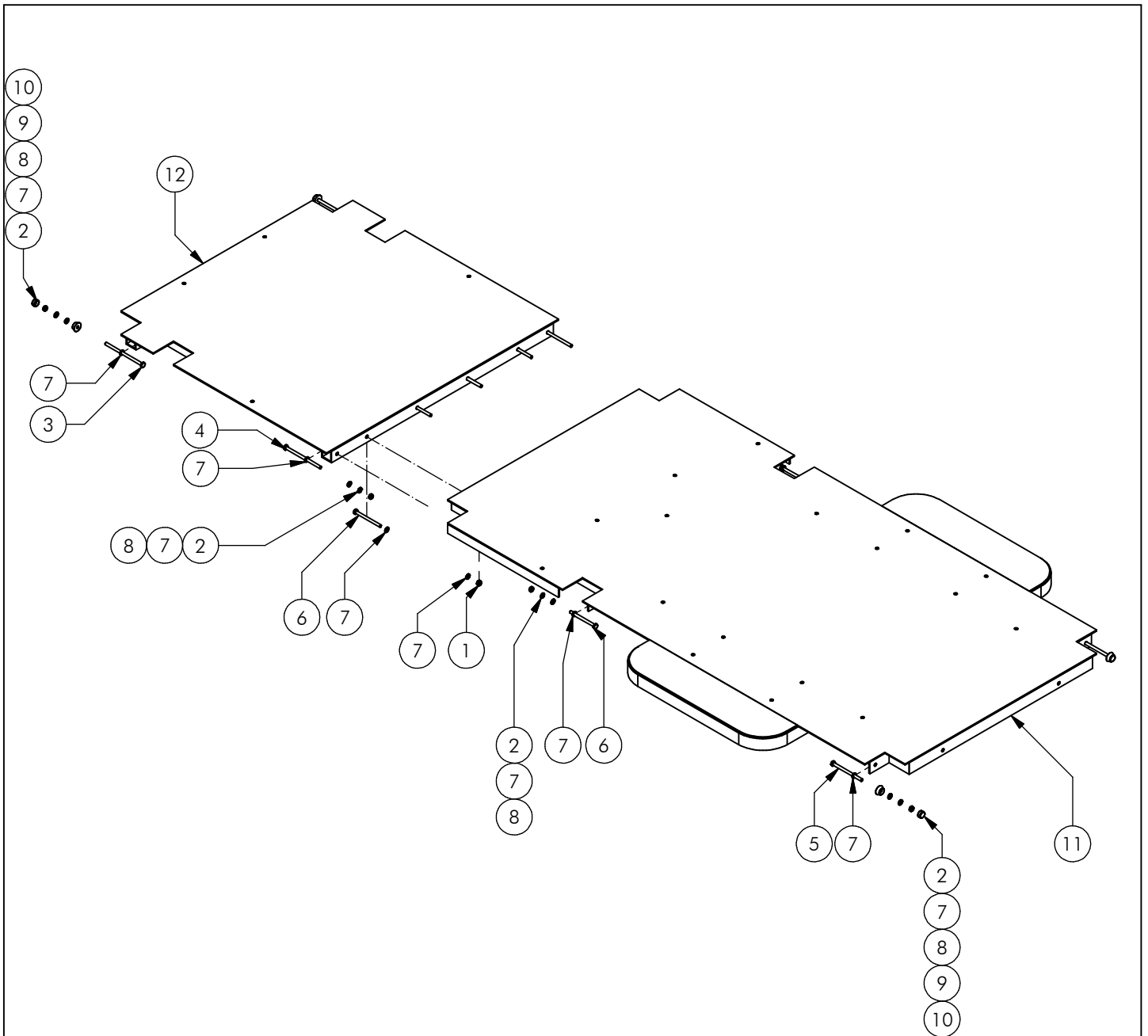

Nr	#	Type	Progr.	Volgnr	Bew.	Rev.	Benaming	Opmerking
1	4	BSV	010	010	010		Borgmoer	M10 - VZ 8.8
2	8	BSV	017	010	008		Zeskantmoer	M10 - VZ 8.8
3	2	BSV	021	010	180		Zeskantbout ISO 4014	M10 x 180 - VZ 8.8
4	2	BSV	021	010	170		Zeskantbout ISO 4014	M10 x 170 - VZ 8.8
5	2	BSV	021	010	140		Zeskantbout ISO 4014	M10 x 140 - VZ 8.8
6	6	BSV	021	010	120		Zeskantbout ISO 4014	M10 x 120 - VZ 8.8
7	24	BSV	030	010	002		Sluitring	M10 - VZ 8.8
8	8	BSV	032	010	002		Veerring	M10 - VZ 8.8
9	4	KST	DON	011	020		interplay donut M10 wit	84395000012
10	4	KST	DOP	011	020		interplay dop M10 wit	84395000014
11	1	SME	MNP	128	906		Bordes	Groot
12	1	SME	MNP	129	906		Bordes	Klein



Benaming
Title: Vloer

Opmerking
Comment: Brandweer

Datum
Date: 7-10-2015

Tekening
Drawing

MOD MNP 341 043

Samenstelling module Assembly module

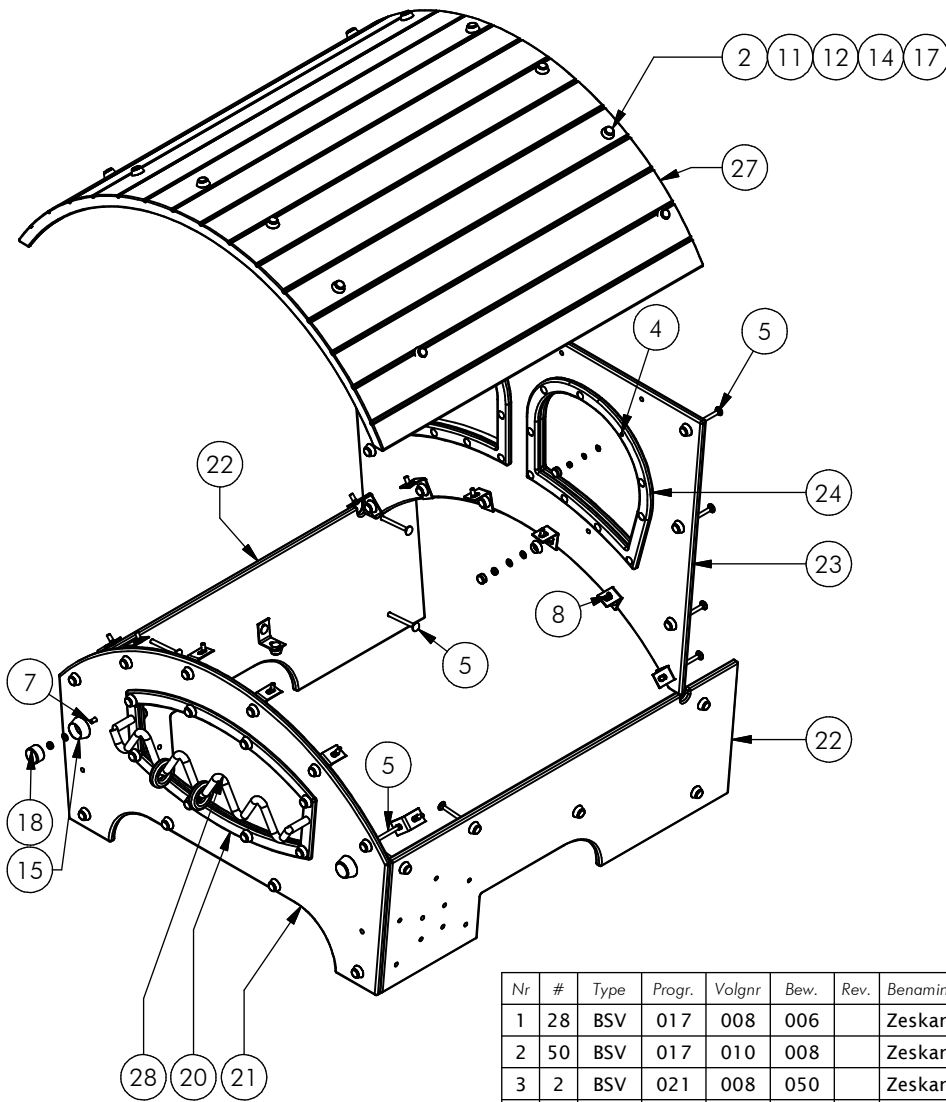

Nr	#	Type	Progr.	Volgnr	Bew.	Rev.	Benaming	Opmerking
1	28	BSV	017	008	006		Zeskantmoer	M8 - VZ 8.8
2	50	BSV	017	010	008		Zeskantmoer	M10 - VZ 8.8
3	2	BSV	021	008	050		Zeskantbout ISO 4014	M8 x 50 - VZ 8.8
4	28	BSV	026	008	040		Slotbout	M8 x 40 - VZ 8.8
5	18	BSV	026	010	130		Slotbout	M10 x 130 - VZ 8.8
6	2	BSV	026	010	140		Slotbout	M10 x 140 - VZ 8.8
7	10	BSV	026	010	035		SLOTBOUT	M10x35
8	16	BSV	026	010	025		Slotbout	M10 x 25 - VZ 8.8
9	4	BSV	026	010	045		Slotbout	M10 x 45 - VZ 8.8
10	30	BSV	030	008	016		Sluitring	M8 - VZ 8.8
11	50	BSV	030	010	002		SLUITRING	M10 VZ
12	48	BSV	034	010	002		Veerring	M10 - VZ 8.8
13	28	BSV	034	008	002		Veerring	M8 - VZ 8.8
14	58	KST	DON	011	020		interplay donut M10 wit	84395000012
15	2	KST	DON	012	010		miniplay donut M12 geel	823950000151
16	20	KST	DOP	011	090		interplay dop	zwart
17	58	KST	DOP	011	020		interplay dop M10 wit	84395000014
18	2	KST	DOP	012	010		miniplay dop M12 - M20 geel	823950000152
19	16	OME	MNP	009	320		Hoekje model 1	
20	1	OME	MNP	433	906		Plaat 10mm	711 x 355 mm
21	1	OPE	MNP	462	030		Motorfront	Brandweer
22	2	OPE	MNP	463	030		Zijkant moter	Brandweer
23	1	OPE	MNP	464	030		Voorkant cabine	Brandweer
24	2	OPE	MNP	465	090		Raamlijst	Brandweer
25	1	OPE	MNP	466	010		Ring	Zigzag
26	1	OPE	MNP	466	030		Ring	Zigzag
27	1	POL	FRP	026	320	A	Polyester overkapping	Freeplay
28	1	SME	MNP	135	906		Zigzag	Brandweer



Benaming
Title Motor

Opmerking
Comment Brandweer

Datum
Date 14-10-2015

Tekening
Drawing

MOD MNP 341 044

Samenstelling module Assembly module

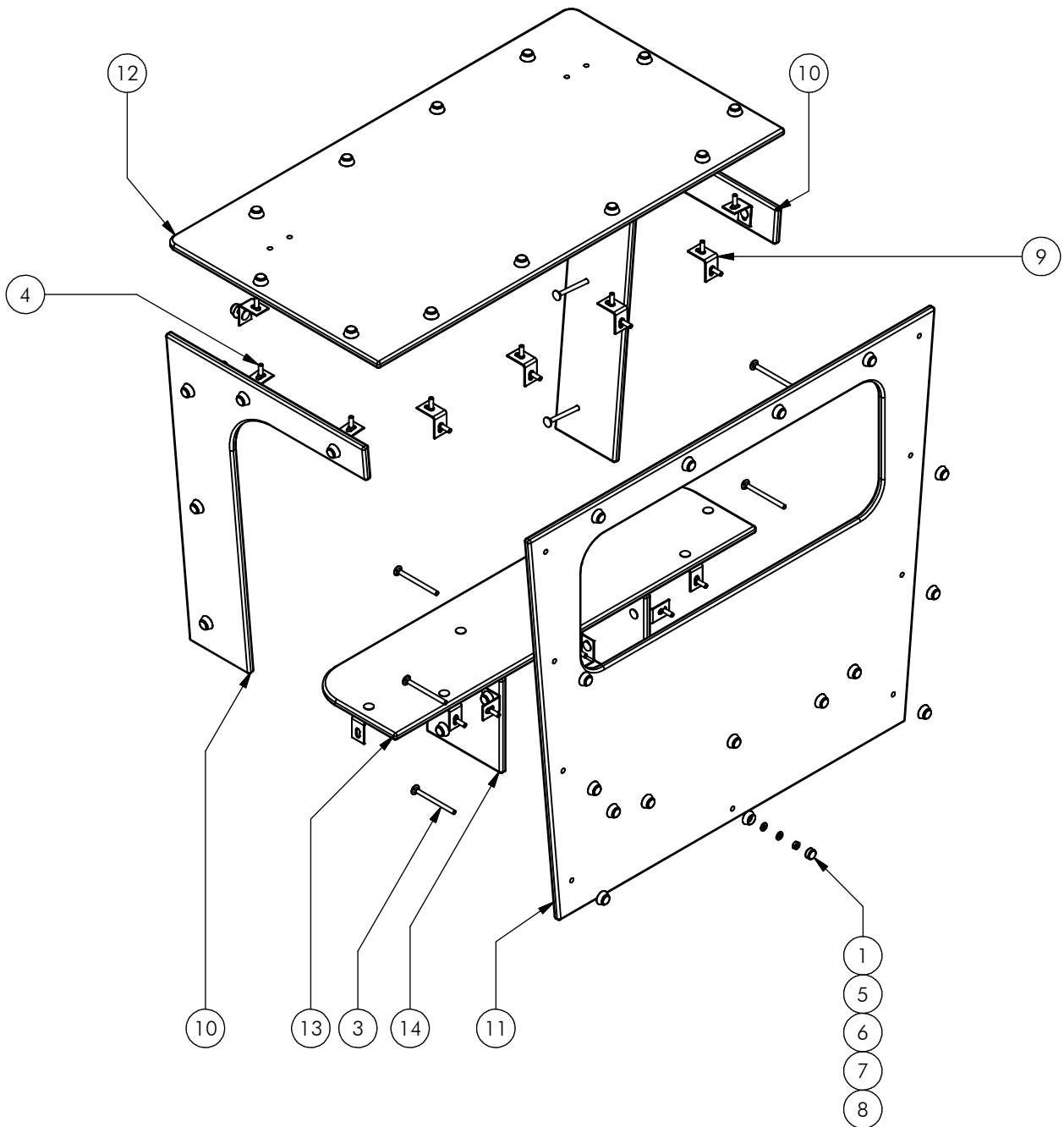

Nr	#	Type	Progr.	Volgnr	Bew.	Rev.	Benaming	Opmerking
1	58	BSV	017	010	008		Zeskantmoer	M10 - VZ 8.8
2	3	BSV	026	010	025		Slotbout	M10 x 25 - VZ 8.8
3	12	BSV	026	010	130		Slotbout	M10 x 130 - VZ 8.8
4	43	BSV	026	010	035		Slotbout	M10 x 35 - VZ 8.8
5	58	BSV	030	010	002		Sluitring	M10 - VZ 8.8
6	58	BSV	032	010	002		Veerring	M10 - VZ 8.8
7	55	KST	DON	011	020		interplay donut M10 wit	84395000012
8	55	KST	DOP	011	020		interplay dop M10 wit	84395000014
9	24	OME	MNP	009	372		Hoekje rood model 1	miniplay M12
10	2	OPE	MNP	467	030		Zijkant cabine	Brandweer
11	1	OPE	MNP	468	030		Achterkant cabine	Brandweer
12	1	OPE	MNP	469	030		Dak cabine	Brandweer
13	1	OPE	MNP	470	030		Zitvlak cabine	Brandweer
14	2	OPE	MNP	471	030		Steun zitvlak	Brandweer



Benaming
Title Cabine

Opmerking
Comment Brandweer

Datum
Date 9-10-2015

Tekening
Drawing

MOD MNP 341 045

Samenstelling module Assembly module

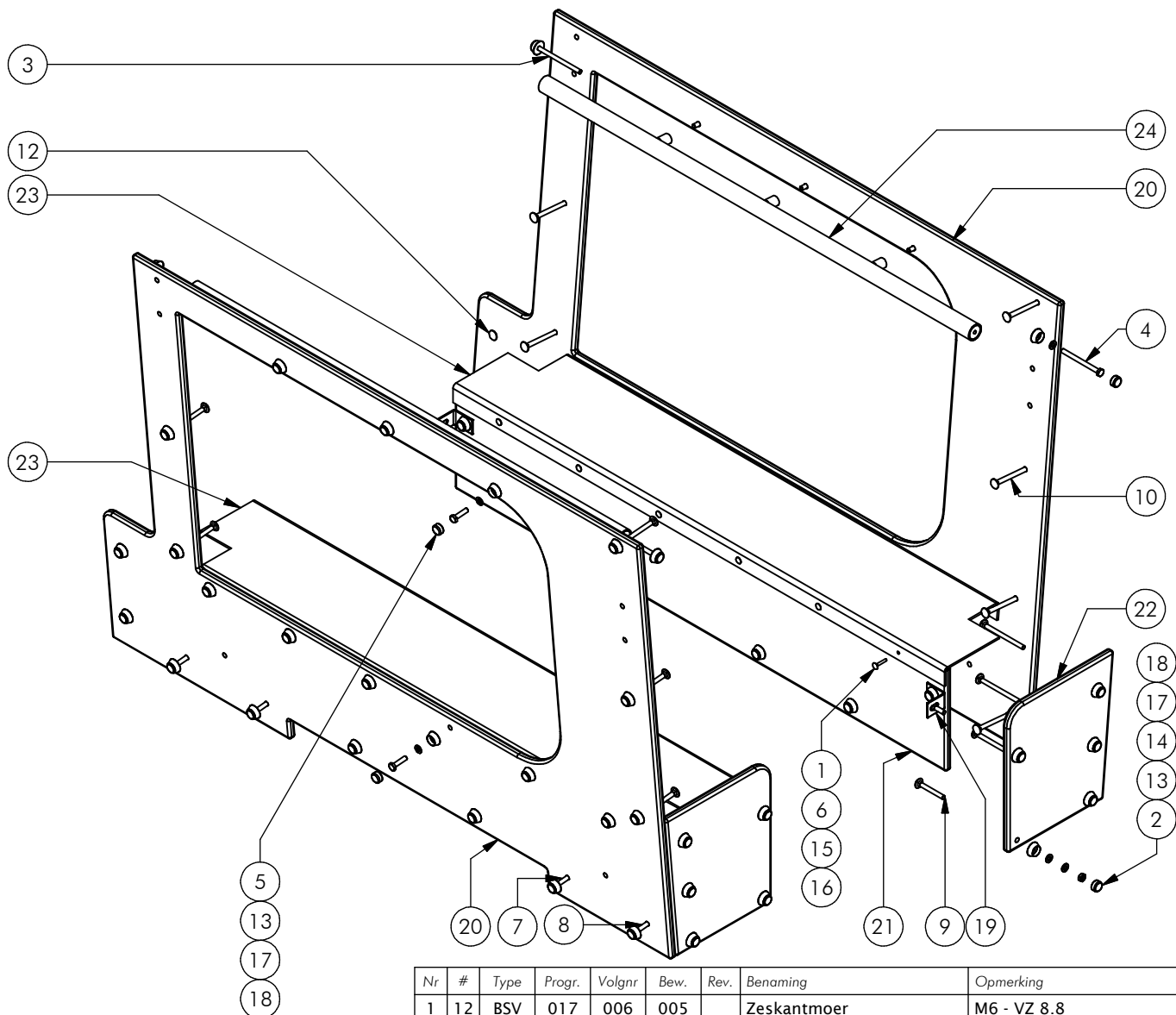

Nr	#	Type	Progr.	Volgnr	Bew.	Rev.	Benaming	Opmerking
1	12	BSV	017	006	005		Zeskantmoer	M6 - VZ 8.8
2	62	BSV	017	010	008		Zeskantmoer	M10 - VZ 8.8
3	2	BSV	021	010	140		Zeskantbout ISO 4014	M10 x 140 - VZ 8.8
4	2	BSV	021	010	120		Zeskantbout ISO 4014	M10 x 120 - VZ 8.8
5	18	BSV	021	010	040		ZESKANTBOUT	M10 x 40
6	12	BSV	026	006	030		Slotbout	M6 x 30 Verzinkt
7	4	BSV	026	010	070		Slotbout	M10 x 70 - VZ 8.8
8	4	BSV	026	010	170		Slotbout	M10 x 170 - VZ 8.8
9	2	BSV	026	010	080		Slotbout	M10x80
10	16	BSV	026	010	130		Slotbout	M10 x 130 - VZ 8.8
11	14	BSV	026	010	025		Slotbout	M10 x 25 - VZ 8.8
12	22	BSV	026	010	035		Slotbout	M10 x 35 - VZ 8.8
13	84	BSV	030	010	002		Sluitring	M10 - VZ 8.8
14	62	BSV	032	010	002		Veerring	M10 - VZ 8.8
15	12	BSV	034	006	002		Veerring	M6 - VZ 8.8
16	12	BSV	035	006	020		CARROSSERIERING	M6 x 20 - VZ 8.8
17	70	KST	DON	011	020		interplay donut M10 wit	84395000012
18	70	KST	DOP	011	020		interplay dop M10 wit	84395000014
19	18	OME	MNP	009	320		Hoekje model 1	
20	2	OPE	MNP	472	030		Zijkant	Brandweer
21	2	OPE	MNP	473	030		Zijkant zitting	Brandweer
22	2	OPE	MNP	474	030		Achterkant	Brandweer
23	2	SME	MNP	130	906		Alu Zitbank	Brandweer
24	2	SME	MNP	131	906		Verstevigings pijp	Brandweer



Benaming Title Achterkant
 Opmerking Comment Brandweer
 Datum Date 14-10-2015

Tekening Drawing

MOD MNP 341 046

Samenstelling module Assembly module

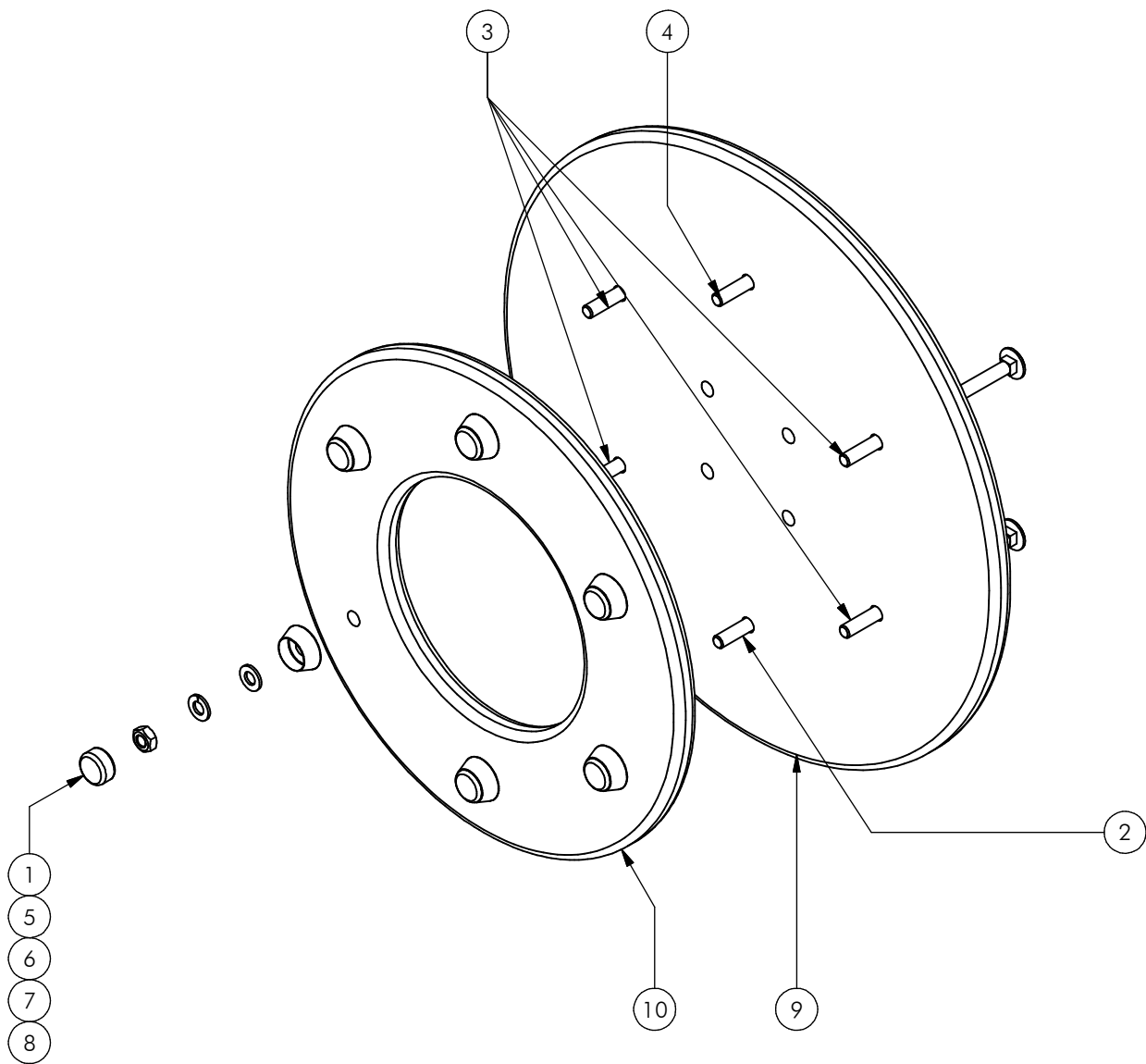

Nr	#	Type	Progr.	Volgnr	Bew.	Rev.	Benaming	Opmerking
1	6	BSV	017	010	008		Zeskantmoer	M10 - VZ 8.8
2	1	BSV	026	010	050		Slotbout	M10 x 50 - VZ 8.8
3	4	BSV	026	010	170		Slotbout	M10 x 170 - VZ 8.8
4	1	BSV	026	010	070		Slotbout	M10 x 70 - VZ 8.8
5	6	BSV	030	010	002		Sluitring	M10 - VZ 8.8
6	6	BSV	032	010	002		Veerring	M10 - VZ 8.8
7	6	KST	DON	011	020		interplay donut M10 wit	84395000012
8	6	KST	DOP	011	020		interplay dop M10 wit	84395000014
9	1	OPE	MNP	475	090		Voorwiel	Brandweer
10	1	OPE	MNP	477	030		Sierwiel	Brandweer



Benaming
Title: Voorwiel

Opmerking
Comment: Brandweer

Datum
Date: 13-10-2015

Tekening
Drawing

MOD MNP 341 047

Samenstelling module Assembly module

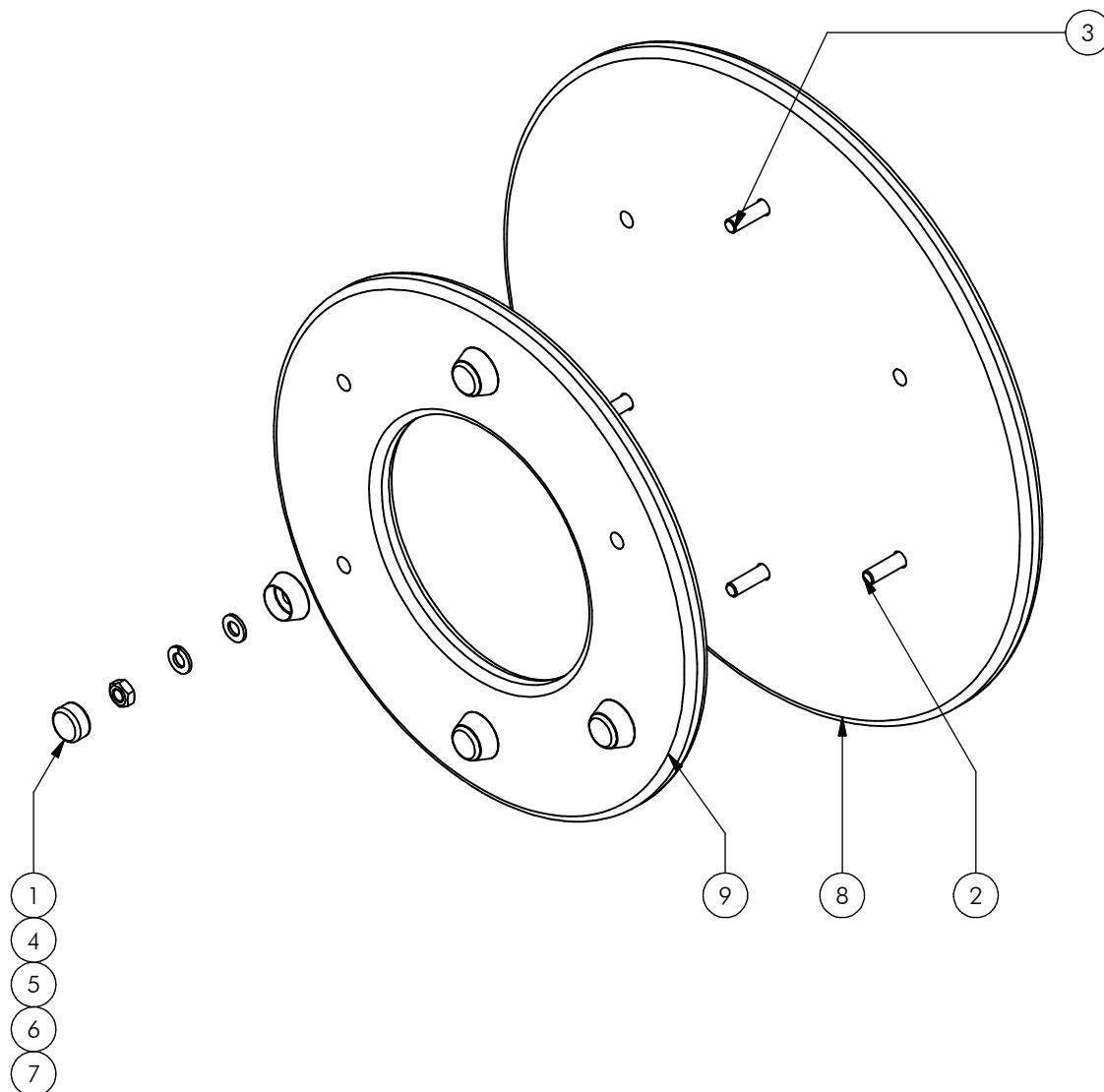

Nr	#	Type	Progr.	Volgnr	Bew.	Rev.	Benaming	Opmerking
1	4	BSV	017	010	008		Zeskantmoer	M10 - VZ 8.8
2	3	BSV	026	010	050		Slotbout	M10 x 50 - VZ 8.8
3	1	BSV	026	010	070		Slotbout	M10 x 70 - VZ 8.8
4	4	BSV	030	010	002		Sluitring	M10 - VZ 8.8
5	4	BSV	032	010	002		Veerring	M10 - VZ 8.8
6	4	KST	DON	011	020		interplay donut M10 wit	84395000012
7	4	KST	DOP	011	020		interplay dop M10 wit	84395000014
8	1	OPE	MNP	476	090		Achterwiel	Brandweer
9	1	OPE	MNP	477	030		Sierwiel	Brandweer



Benaming
Title: Achterwiel

Opmerking
Comment: Brandweer

Datum
Date: 13-10-2015

Tekening
Drawing

MOD MNP 341 048

Samenstelling module Assembly module

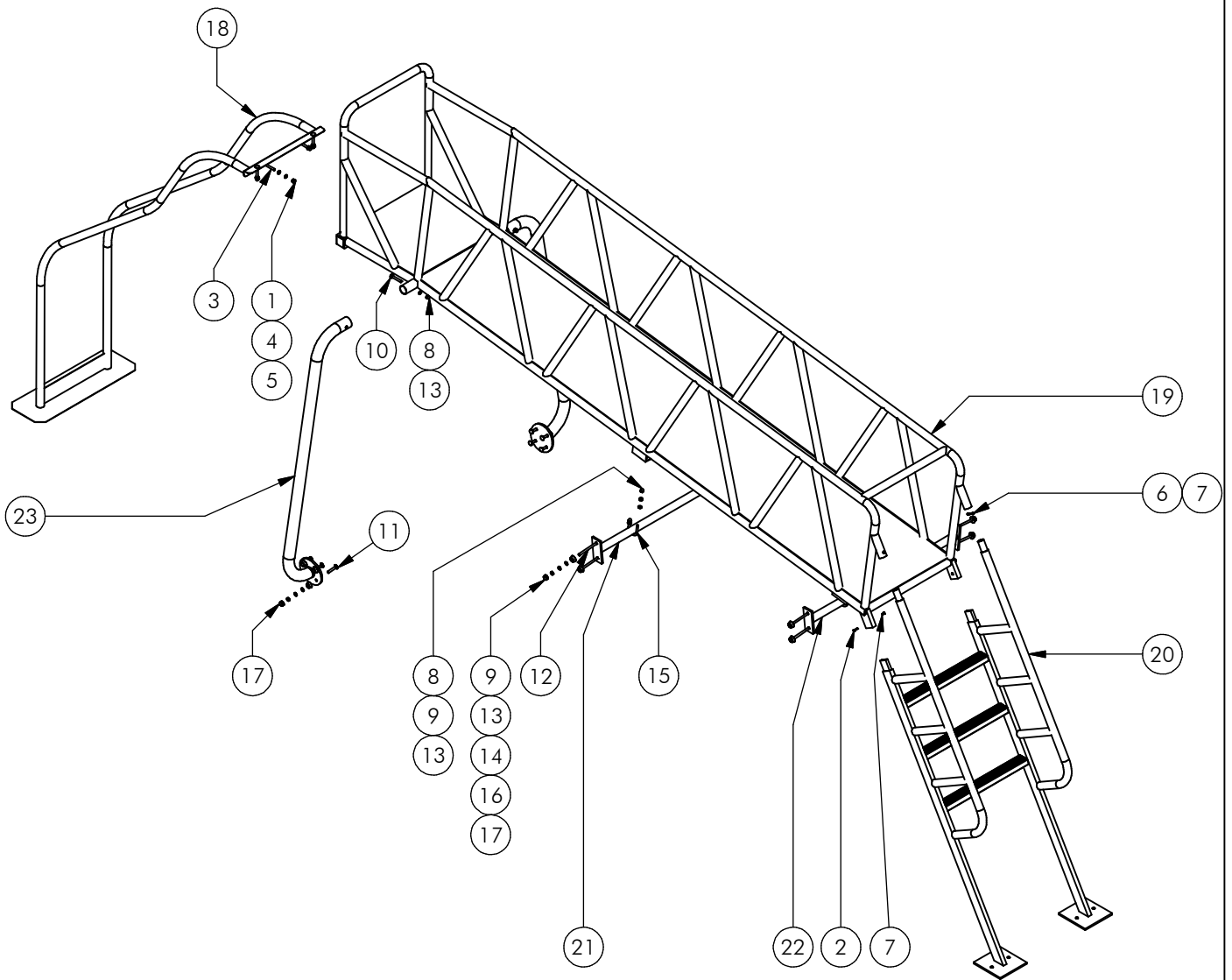

Nr	#	Type	Progr.	Volgnr	Bew.	Rev.	Benaming	Opmerking
1	4	BSR	012	010	020		DOPMOER	RVS M10
2	2	BSR	023	006	025		Bolkopbout ISO 7380	M6 x 25 - RVS A2-70
3	4	BSR	026	010	080		Slotbout	M10 x 80 - RVS A2-70
4	4	BSR	030	010	002		SLUITRING	M10
5	4	BSR	034	010	002		Veerring	M10 - RVS A2-70
6	2	BSR	063	006	035		Patentschroef	M6 x 35 - RVS A2-70
7	4	BSR	063	006	BUS		Patentmoer	M6 - RVS A2-70
8	10	BSV	011	010	020		Borgdopmoer	M10 - VZ 8.8
9	24	BSV	017	010	008		Zeskantmoer	M10 - VZ 8.8
10	2	BSV	026	010	070		Slotbout	M10 x 70 - VZ 8.8
11	8	BSV	026	010	060		SLOTBOUT	M10x60
12	8	BSV	026	010	140		Slotbout	M10 x 140 - VZ 8.8
13	26	BSV	030	010	002		Sluitring	M10 - VZ 8.8
14	16	BSV	032	010	002		Veerring	M10 - VZ 8.8
15	4	BSV	140	010	002		Pijpbeugel M10	Brandweerwagen
16	16	KST	DON	011	020		interplay donut M10 wit	84395000012
17	16	KST	DOP	011	020		interplay dop M10 wit	84395000014
18	1	SME	MNP	038	320		Barrister rails	1700mm
19	1	SME	MNP	039	906		Ladder Brandweerwagen	Zitstangen
20	1	SME	MNP	052	906		Ladder	Brandweer
21	1	SME	MNP	132	906		Steun voor	Ladderbordes
22	1	SME	MNP	133	906		Steun achter	Ladderbordes
23	2	SME	MNP	134	906		Schoor	Brandweer



Benaming Title Trap+glijstang
 Opmerking Comment Brandweer
 Datum Date 13-10-2015

Tekening Drawing

MOD MNP 341 049

Samenstelling module Assembly module

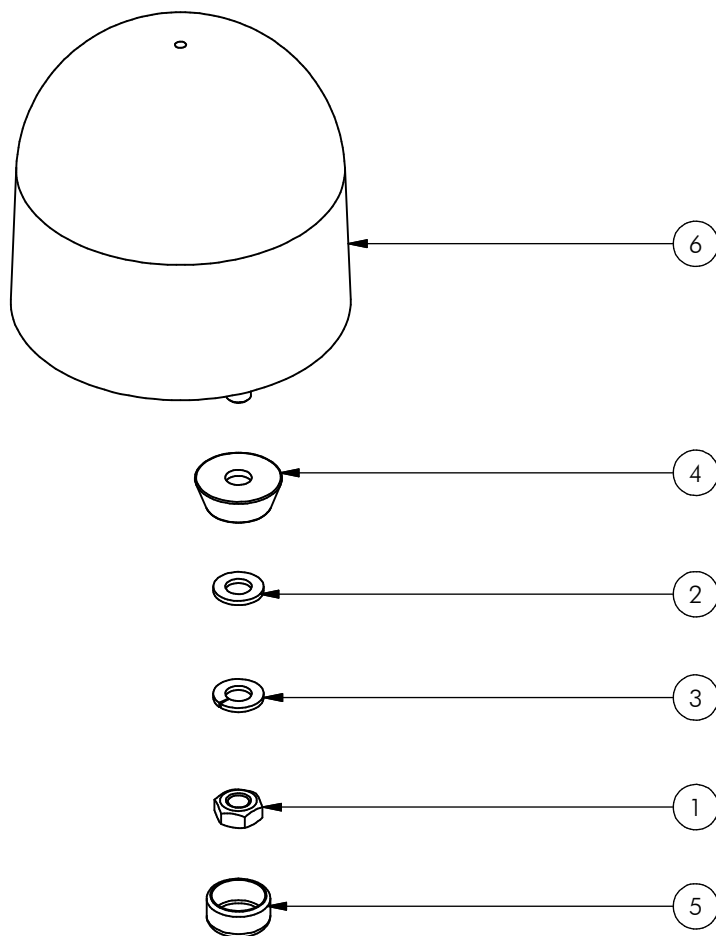

Nr	#	Type	Progr.	Volgnr	Bew.	Rev.	Benaming	Opmerking
1	2	BSV	017	010	008		Zeskantmoer	M10 - VZ 8.8
2	2	BSV	030	010	002		Sluitring	M10 - VZ 8.8
3	2	BSV	032	010	002		Veerring	M10 - VZ 8.8
4	2	KST	DON	011	020		interplay donut M10 wit	84395000012
5	2	KST	DOP	011	020		interplay dop M10 wit	84395000014
6	1	SMD	MNP	022	502		Zwaailicht	Brandweer



Benaming
Title Zwaailicht

Opmerking
Comment Brandweer

Datum
Date 14-10-2015

Tekening
Drawing

MOD MNP 341 050

Samenstelling module Assembly module

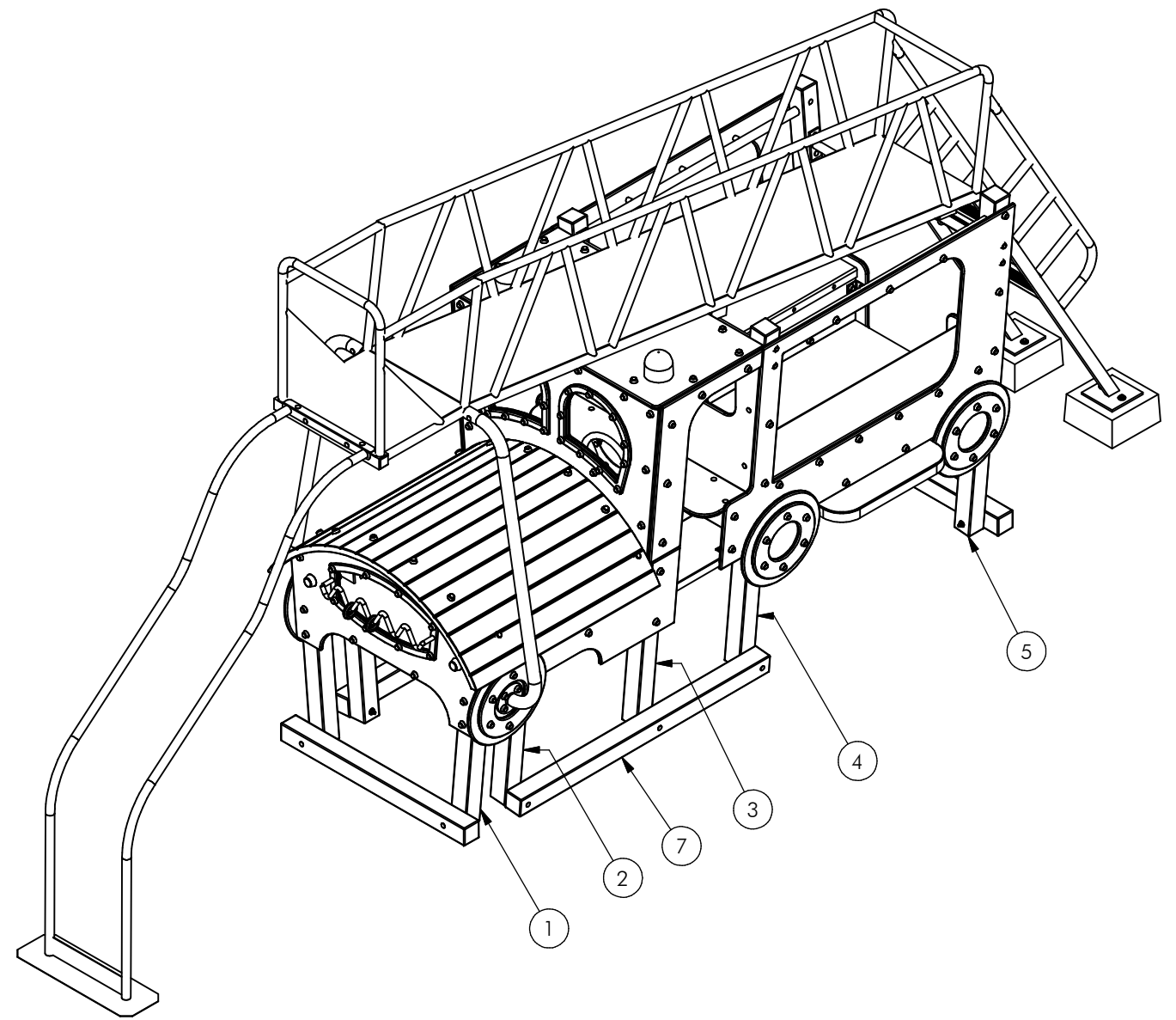
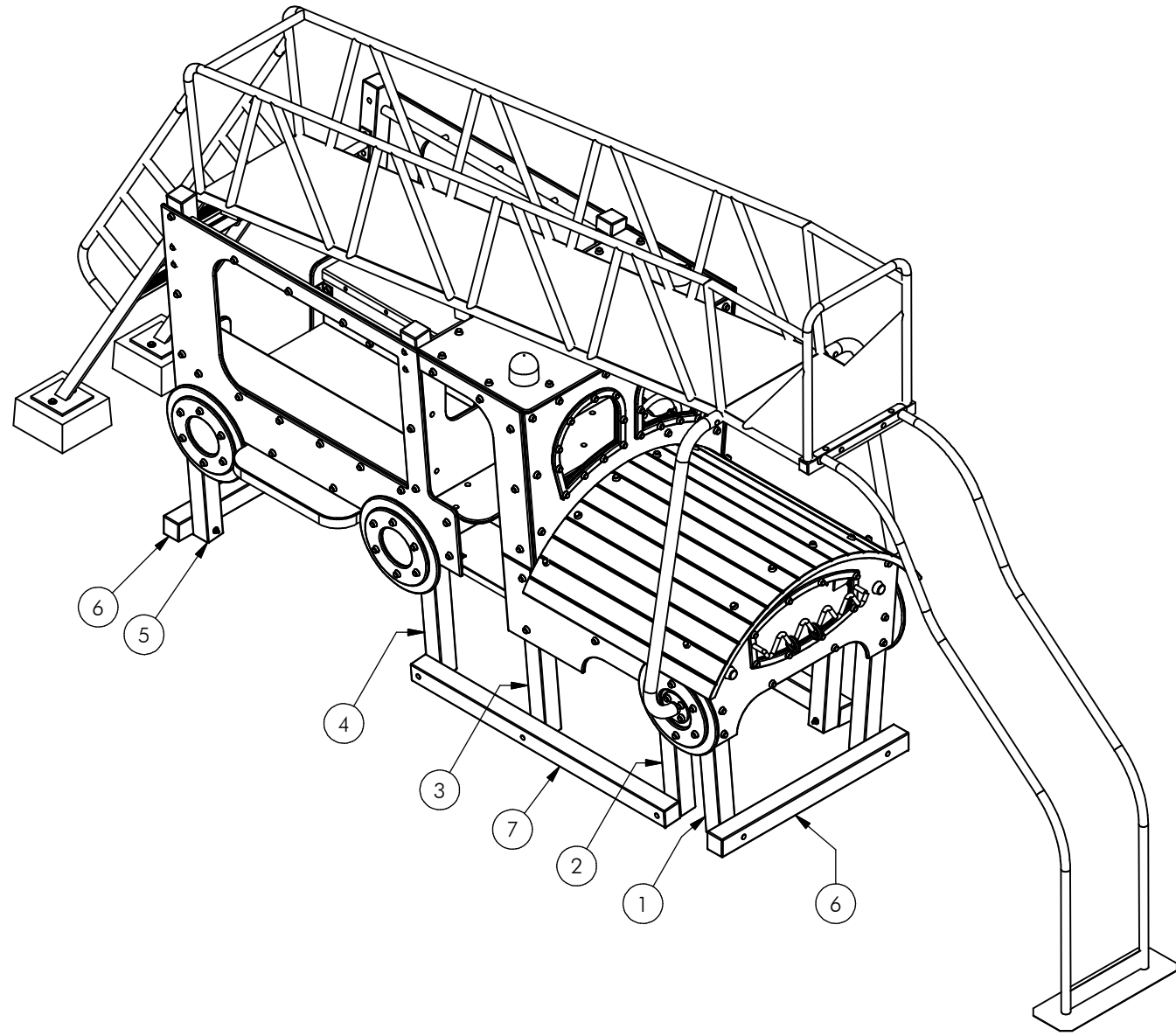

Nr	#	Type	Progr.	Volgnr	Bew.	Rev.	Benaming	Opmerking
1	2	ORE	MNP	420	100		Rebo 1106	Paal 99x99
2	2	ORE	MNP	421	100		Rebo 1106	Paal 99x99
3	2	ORE	MNP	422	100		Rebo 1907	Paal 99x99
4	2	ORE	MNP	423	100		Rebo 1981	Paal 99x99
5	2	ORE	MNP	424	100		Rebo 1981	Paal 99x99
6	2	ORE	MNP	425	100		Rebo 1200	Paal 99x99
7	2	ORE	MNP	426	100		Rebo 1630	Paal 99x99



Benaming Title Rebo pakket
 Opmerking Comment Brandweer
 Datum Date 7-10-2015

Tekening Drawing

MOD MNP 407 001
 Samenstelling module Assembly module

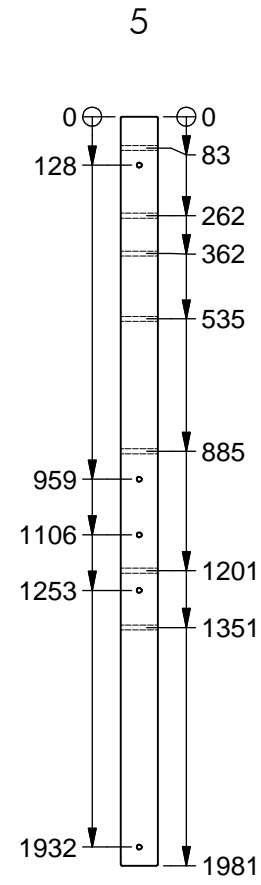
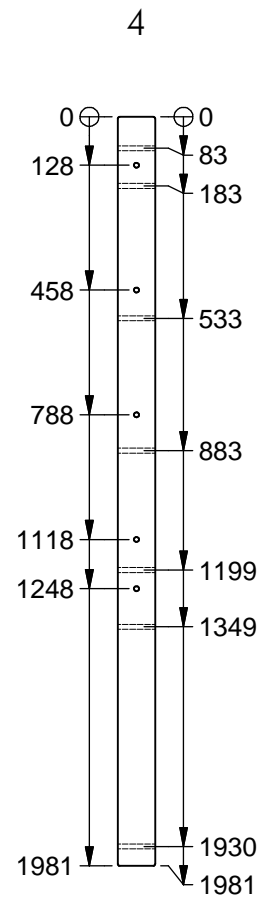
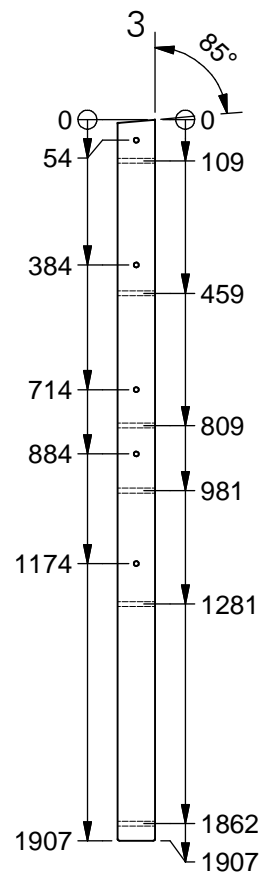
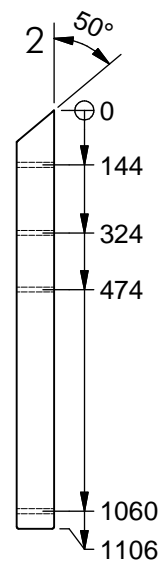
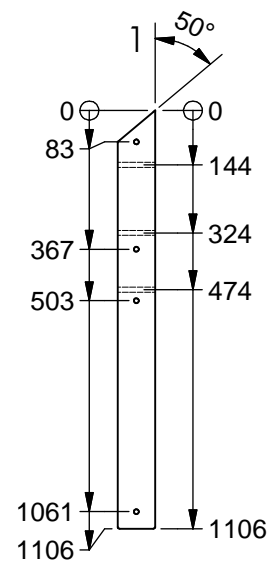

6

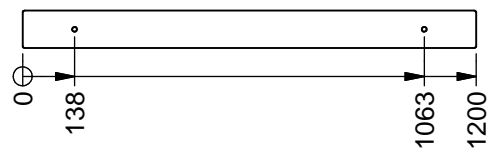

7

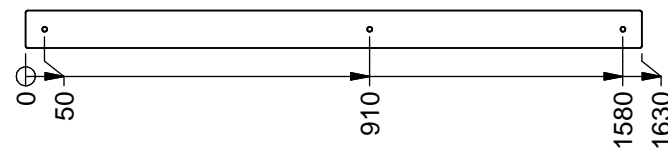

All holes Ø13 unless otherwise stated.
 All holes pierce unless otherwise stated.
 All the holes in the heart of the post, unless otherwise stated.
 Alle gaten Ø13 tenzij anders vermeld.
 Alle gaten doorboren tenzij anders vermeld.
 Alle gaten in hart van de paal tenzij anders vermeld.



Benaming Title Rebo pakket
 Opmerking Comment Brandweer
 Datum Date 7-10-2015

Tekening Drawing

MOD MNP 407 001

Zaag- en boorstaat Cut and drill table

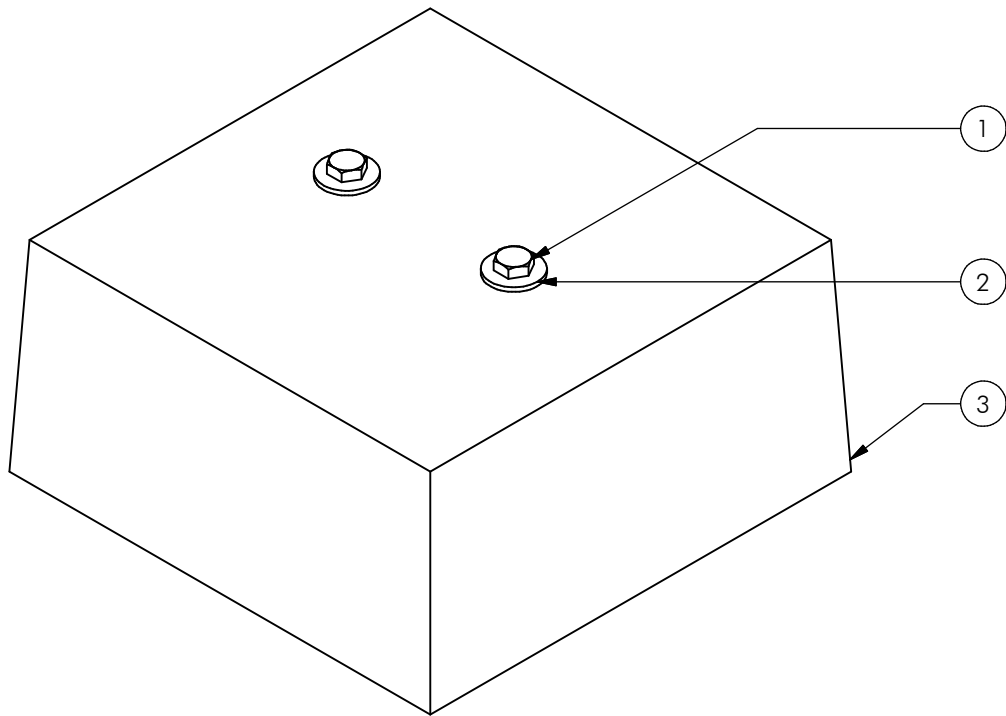

Nr	#	Type	Progr.	Volgnr	Bew.	Rev.	Benaming	Opmerking
1	2	BSV	021	012	040		Zeskantbout ISO 4014	M12 x 40 - VZ 8.8
2	2	BSV	035	012	035		Carrosseriering	M12 x 35 - VZ 8.8
3	1	OBT	POE	009	033		POER	MODEL 9



Benaming
Title | Poer Model 9

Opmerking
Comment | Gewicht 33,5 kg

Datum
Date | 17-8-2012

Tekening
Drawing

MOD OBT 009 001

Samenstelling module Assembly module