

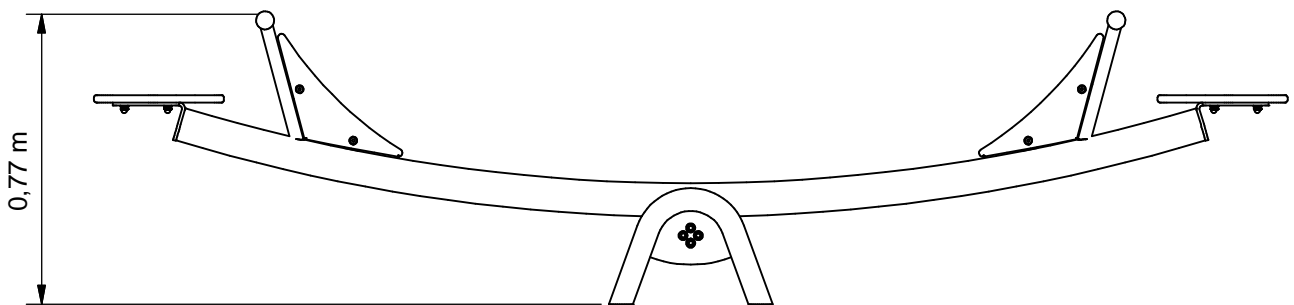

Seesaw eagle

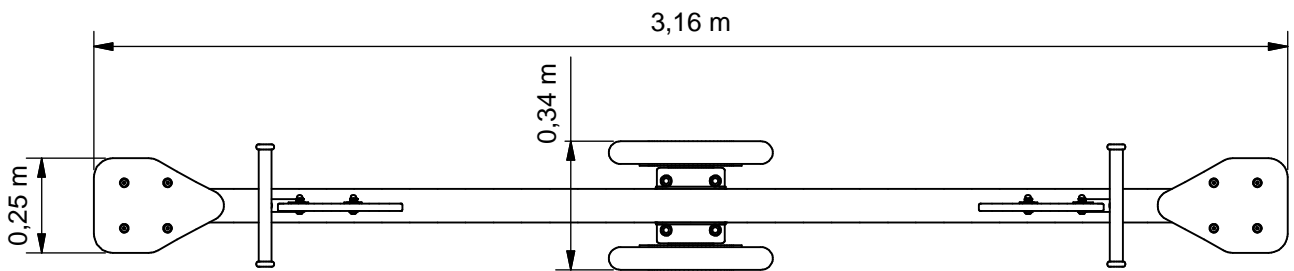

SOLE030.010



Benaming
Title Adelaar

Opmerking
Comment 2 personen

Datum
Date 4-2-2009

Tekening
Drawing

TOE SOL 030 010

Afmetingen Dimensions

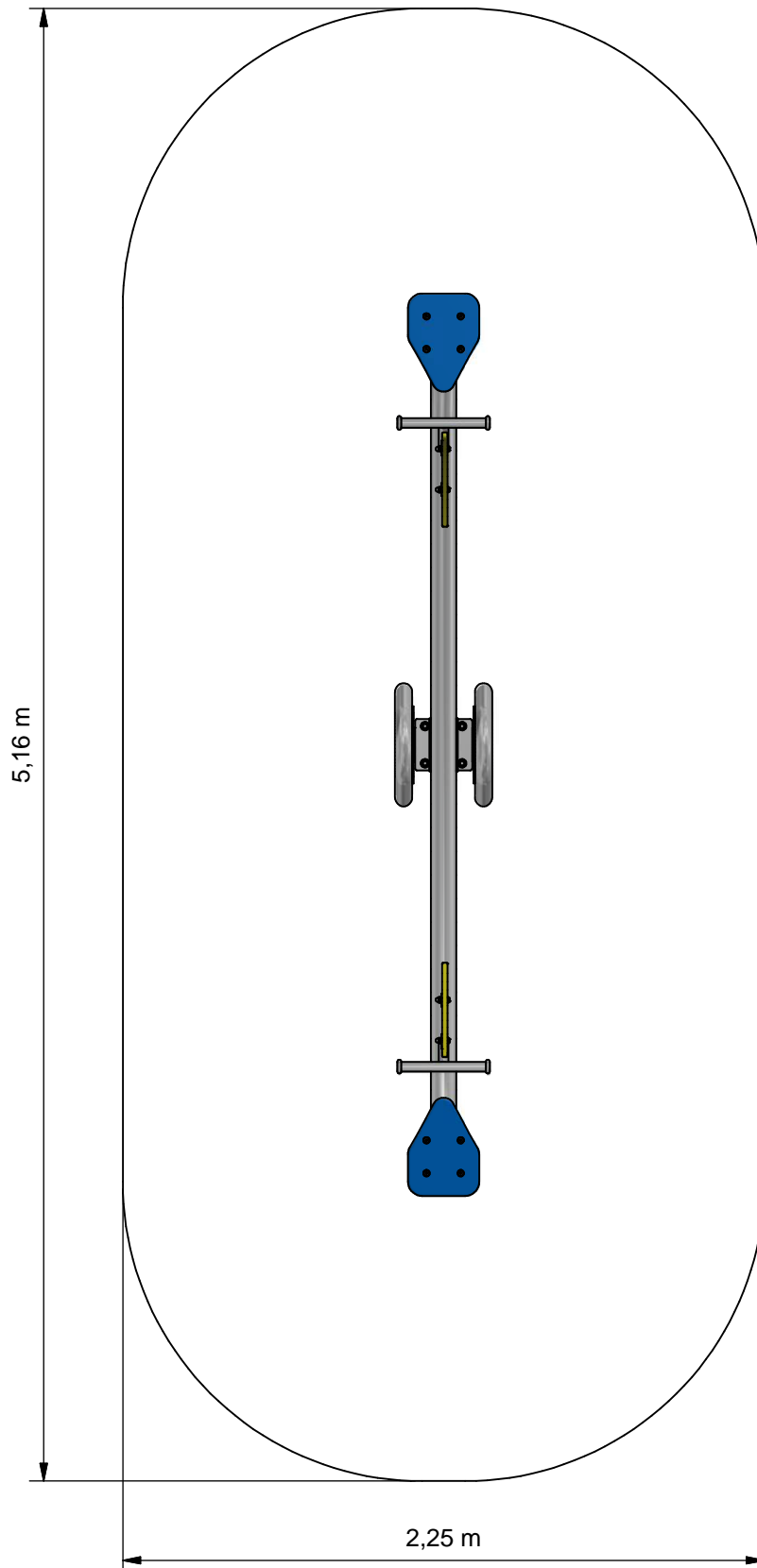

- Opvangzone**
Impact area
- Obstakelvrije zone**
Obstacle free zone



Benaming
Title Adelaar

Opmerking
Comment 2 personen

Datum
Date 21-9-2011

Tekening
Drawing

TOE SOL 030 010

Obstakelvrije zone *Obstacle free zone*

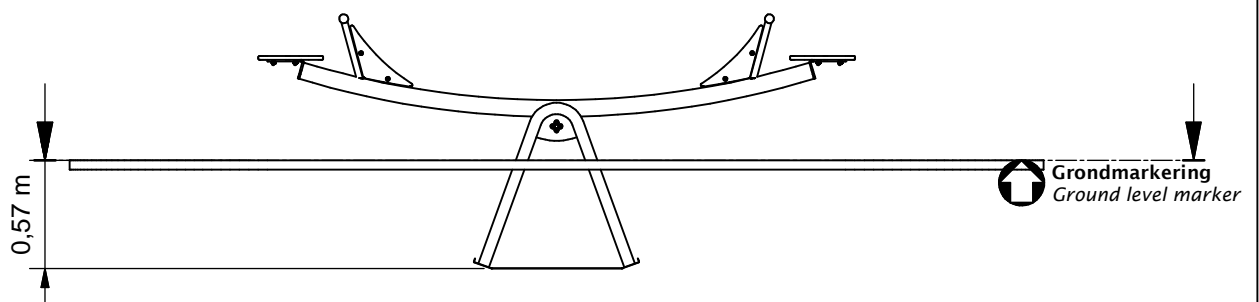
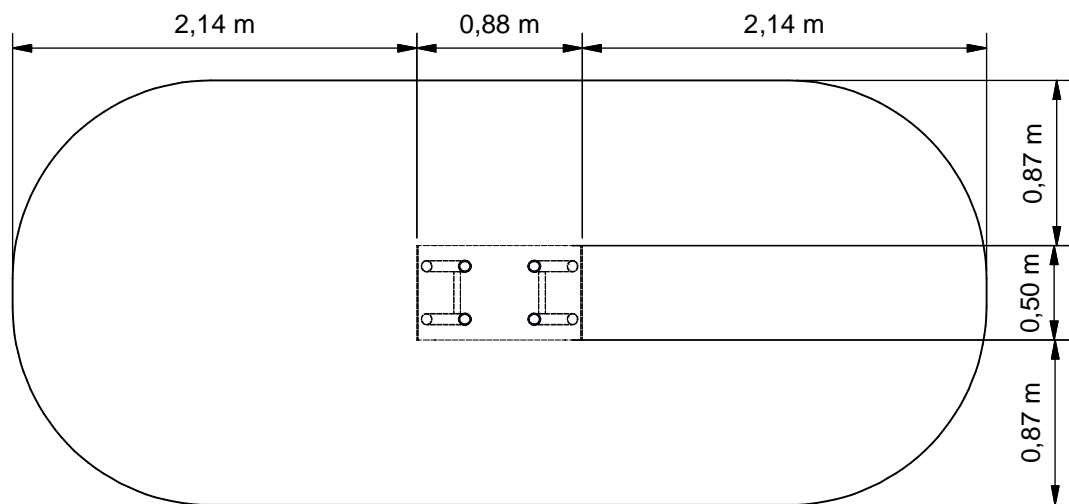

Benaming
Title Adelaar

Opmerking
Comment 2 personen

Datum
Date 21-9-2011

Tekening
Drawing

TOE SOL 030 010

Bodemplan Groundplan

Geleverde modules:

Zie tabel

Supplied modules:

See table

Montageinstructie:

- De hoofdmaten geven de maten van de standers en vloeren aan
- De detailtekeningen geven specifiek de maten van de verbindingen aan
- De modules met buizen zijn op de tekeningen bemaat op bovenkant kopplaat
- Overige modules zijn bemaat op de bovenkant (klimwanden, paalkappen, etc.)

Assembly instruction:

- The main dimensions indicate the dimensions of the posts and floors
- The detailed dimensions show the specific dimensions of the connections
- The modules which contain tubes are dimensioned at the top of the flanges
- Other modules are dimensioned at the top (climbing walls, caps for the posts, etc.)

Montagevolgorde:

- 1 - Graaf de gaten volgens het bodemplan
- 2 - Plaats 1
- 3 - Plaats 2 en verbind deze aan 1
- 4 - Controleer of het toestel voldoet aan de afmetingen zoals op blad 'afmetingen'
- 5 - Dicht de gaten en verdicht het zand

Assembly sequence:

- 1 - Dig the holes according to the ground plan
- 2 - Place 1
- 3 - Place 2 and attach it to 1
- 4 - Check that the equipment conforms to the dimensions shown on sheet 'dimensions'
- 5 - Close the holes and compact the sand

Controles:

- 1 - Correcte opbouw en alle bevestigingsmiddelen
- 2 - Controleer de afmetingen van de valbodem t.o.v. het toestel

Checks:

- 1 - Correct assembly and all the fasteners
- 2 - Check the dimensions of the safety area with regard to the play equipment

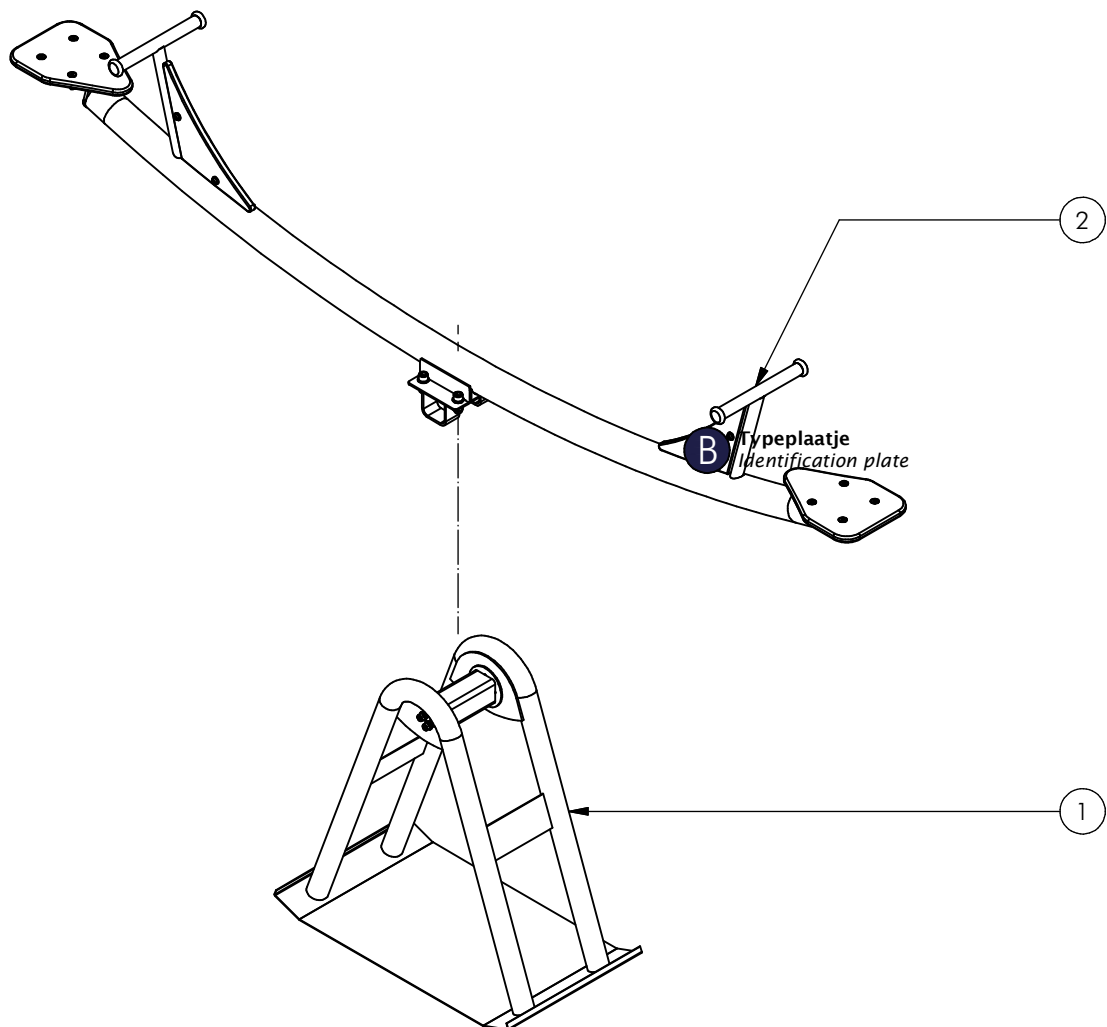

Nr	#	Type	Progr.	Volgnr	Bew.	Rev.	Benaming	Opmerking
1	1	MOD	SOL	030	305		Onderstel	Wip
2	1	MOD	SOL	030	306		Verend deel	Adelaar



Benaming
Title | Adelaar

Opmerking
Comment | 2 personen

Datum
Date | 21-9-2011

Tekening
Drawing

TOE SOL 030 010

Modules Modules

SOLE030.010

Seesaw eagle

LOGBOOK

(Onderstaand logboek kan gebruikt worden om te voldoen aan de eisen, gesteld in artikel 14 van het Warenwetbesluit Attractie- en Speeltoestellen)

Type indication	Pioneer Play
Product code	SOLE030.010
Name of equipment	Adelaar
Maximum height of fall	1,0 m
Year of construction	2017
Certificate	98200116203
inspection authority	Liftinstituut B.V. Buikslotermeerplein 381, A'dam - 1025 XE Amsterdam
Name manufacturer	BOERplay Hyacintstraat 2 - 4255 HX Nieuwendijk Phone: +31 (0)183 40 23 66 Fax: +31 (0)183 40 35 64
name installer	_____ _____
Description of equipment	Seesaw eagle
Location of equipment	_____
Data about the owner of the play equipment	
Name:	_____
Address:	_____
Postcode and town:	_____
Contact person:	_____
Telephone number:	_____
Data about the administrator of the play equipment	
Name:	_____
Address:	_____
Postcode and town:	_____
Contact person:	_____
Telephone number:	_____

LOGBOOK

Inspection and maintenance intervals



Nr.	Inspection	Maintenance	months between inspections
1	Verify equipment's stability, junctions and missing parts. Inspect bolts, screws and nuts for absence, jams, corrosion and wear.	Add missing parts, secure joints, apply missing fixing agent and replace corroded parts.	1
2	Check suspension for wear.	Replace worn parts and/or remove non-functioning parts.	1
3	Inspect rotating parts such as hinges, rolling-element bearings, etc. for wear and acceptability.	Replace worn parts and/or remove non-functioning parts.	1
4	Check wood for splinters, unacceptable damage and signs of rot. Especially at ground level.	Repair damage. Replace affected wood. Smoothen splintered wood and sharp edges.	1
5	Inspect foundation for stability, tearing and coverage.	Restore foundation and covering material.	3
6	Examine rubber and synthetic parts for wear, damage and break.	Replace original parts.	3
7	Inspect metal for corrosion and damage in the coating.	Restore any damaged coating (after removing rust and applying primer).	6
8	Check ropes, cables, chains and nets for wear and damage. Steel cables and nets which are tensioned must be checked for tension.	Replace parts where necessary. Steel cables and nets must be tensioned.	3
9	Inspect equipment for unsafe changes and additions.	Remove unsafe additions and correct unsafe changes.	1
10	Inspect safety surfaces.	Restore and repair where necessary.	1

Remarks

1. If used intensively, all points require extra attention.
2. Extreme weather conditions and locations may require a higher inspection frequency. Discuss this with the supplier.
3. Vandalism-sensitive locations require stricter inspections, possibly daily.
4. Check the terrain regularly for items that do not belong there, are unsafe or may be used wrongly. Examples are poisonous plants, glass shards, etc. Frequency depends on strain.
5. Remember that bad maintenance leads to unsafe conditions and notably faster impoverishment of the playground area.
6. Replacement parts can be ordered at the manufacturer with the part numbers on the module drawing. Drawings can be found in de user guide.
7. The impact area shall be provided with impact attenuating surface according to the specified falling height.
8. This list is conform the CEN-standard "playground equipment and surfacing NEN-EN 1176-7".

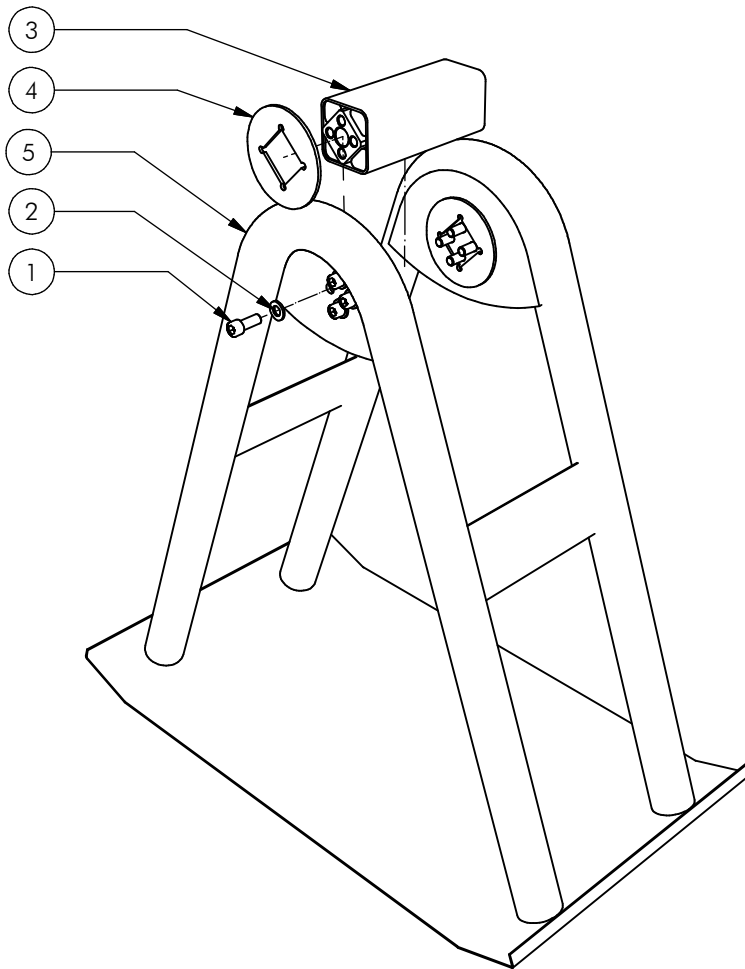

5	1	SME	SOL	001	320	G	Onderstel	Wip
4	2	KST	SOL	001	HPE		OPVULSCHIJFJE	ADELAAR
3	1	BSV	080	200	050		ROSTA ELEMENT	DR-A 50 x 200
2	8	BSR	030	012	003		SLUITRING	M12
1	8	BSR	027	012	030		CIL. KOPBOUT	M12 x 30
POS	N	TYPE	PROJ.	NR.	BEH.	R	BENAMING	OPMERKING



Benaming
Title: Onderstel

Opmerking
Comment: Wip

Datum
Date: 4-2-2009

Tekening
Drawing

MOD SOL 030 305

Samenstelling module *Assembly module*

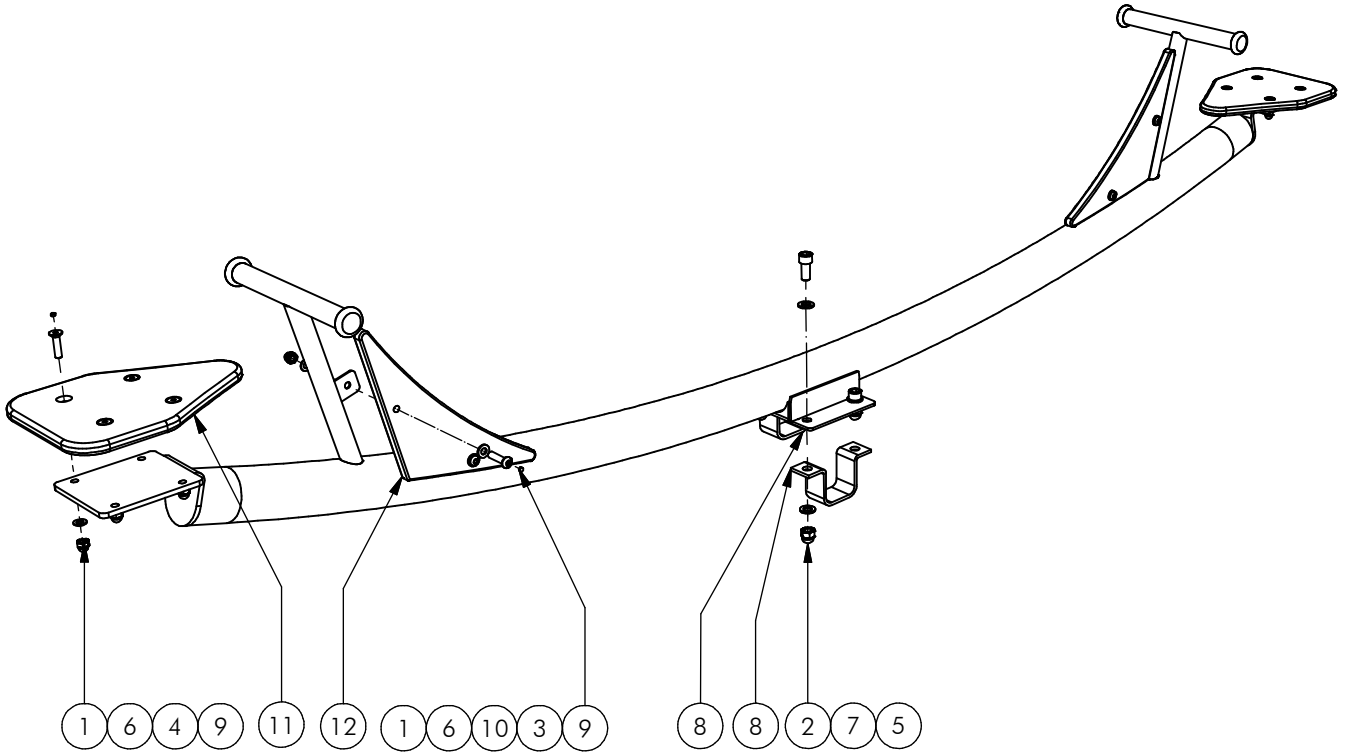

Nr	#	Type	Progr.	Volgnr	Bew.	Rev.	Benaming	Opmerking
1	12	BSR	011	010	020		DOPMOER	BORG RVS M10
2	4	BSR	012	016	030		Dopmoer	M16 - RVS A2-70
3	4	BSR	023	010	040		Bolkopbout ISO 7380	M10 x 40 - RVS A2-70
4	8	BSR	024	010	040		Verzonken bout	M10 x 40 - RVS A2-70
5	4	BSR	027	016	035		Cilinderkop bout	M16 x 35 - RVS A2-70
6	12	BSR	030	010	002		SLUITRING	M10
7	8	BSR	030	016	003		Sluitring	M16 - RVS A2-70
8	2	BSV	080	250	000		KLEMBEUGEL	ROSTA BR50
9	12	KST	DOP	006	030		OPVULDOPJE	6 MM ROOD
10	4	KST	ROR	010	000		RING NYLON	M10 x 2.5 MM
11	2	OPE	SOL	005	050	C	ZITTING	ADELAAR
12	2	OPE	SOL	006	010	A	STEUN TRESPA	ADELAAR
13	1	SME	SOL	003	320	E	VEERBUIS	ADELAAR



Benaming
Title Verend deel

Opmerking
Comment Adelaar

Datum
Date 28-11-2014

Tekening
Drawing

MOD SOL 030 306 A
 Samenstelling module Assembly module